

FAP 674 (IL. 158)

335+00

340+00

MATCHLINE STA. 342+00

SOUTH BOUND IL. 158

BEGIN PROFILE CORRECTION STA. 336+48

30' BUTT JOINT

PROFILE CORRECTION

STA. 339+09

OVERLAY

PLAN	DATE
BY	
NO. OF SHEETS	
NO. OF SHEETS CHECKED	
NO. OF SHEETS DESIGNED	
NO. OF SHEETS O.K.	
NO. OF SHEETS NOTING	
NO. OF SHEETS REVISIONS	
NO. OF SHEETS TOTAL	

PROFILE	DATE
BY	
NO. OF SHEETS	
NO. OF SHEETS CHECKED	
NO. OF SHEETS DESIGNED	
NO. OF SHEETS O.K.	
NO. OF SHEETS NOTING	
NO. OF SHEETS REVISIONS	
NO. OF SHEETS TOTAL	

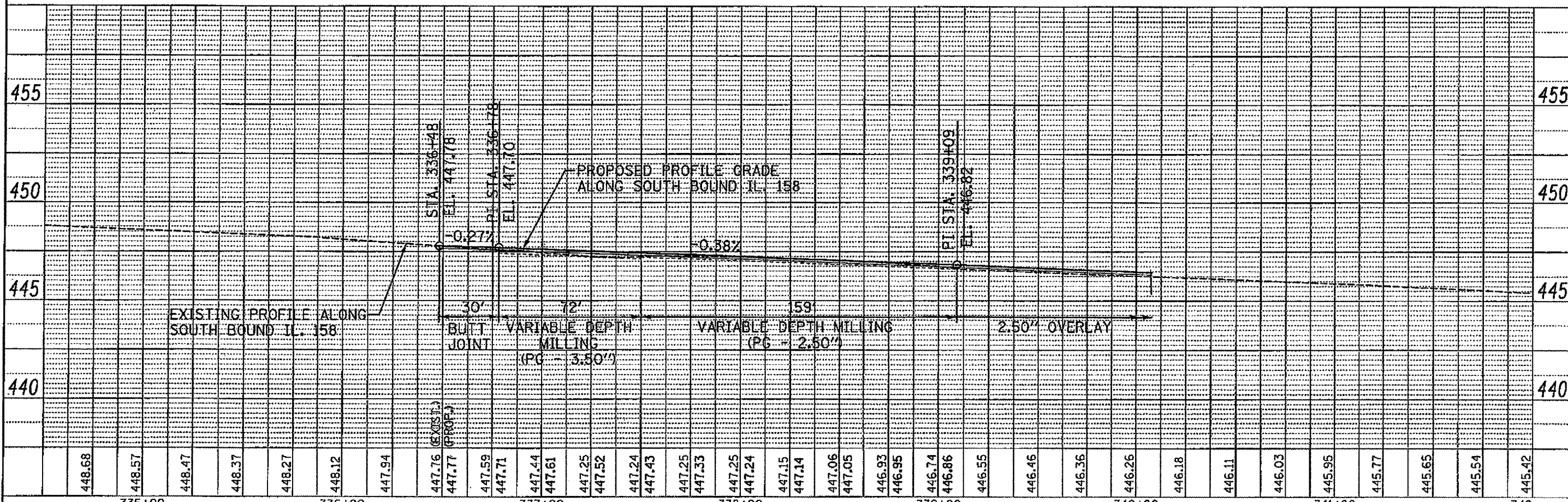

FILE NAME = C:\PP84.S01L105.dgn	USER NAME = eow12	DESIGNED - DHP	REVISED - 03/12/08	<b>STATE OF ILLINOIS</b> <b>DEPARTMENT OF TRANSPORTATION</b>	<b>PLAN &amp; PROFILE IL.158 SOUTH BOUND</b>		F.A.P. RTE.	SECTION	COUNTY	TOTAL SHEETS	SHEET NO.
		DRAWN - EOW	REVISED -		674	410, 410-1-I	ST. CLAIR	41	21		
PLOT SCALE = 25:1		CHECKED - SAR	REVISED -		SCALE: SHEET NO. OF SHEETS STA. TO STA.		CONTRACT NO. 76614				
PLOT DATE = 3/12/2008		DATE - 01/30/08	REVISED - 1"=50'		FED. ROAD DIST. NO. ILLINOIS FED. AID PROJECT						