

**DETAIL
HANDHOLE TO INTERCEPT
EXISTING CONDUIT***

* NOT A PAY ITEM

- NOTES:**
1. REMOVAL OF EXISTING CONDUIT FROM THE HANDHOLE AND THE INSTALLATION OF THE CONDUIT BUSHING SHALL BE INCIDENTAL TO THE HANDHOLE.
 2. THE CONTRACTOR SHALL BE PAID TO LOCATE THE CONDUIT UNDER OTHER PROVISIONS OF THIS CONTRACT. SEE LOCATING UNDERGROUND CABLE IN THE STANDARD SPECIFICATIONS.

**DETECTOR LOOP REQUIREMENTS AND CALCULATIONS
FOR IL 158 AND FRANK SCOTT PARKWAY/WHERRY ROAD**

LOOP	PHASE (Ø)	LOOP SIZE(FT)	REQUIRED # OF TURNS	CALCULATED INDUCTANCE MICROHENRIES (µH)	CALCULATED RESISTANCE OHMS (R)
NB LT CCO 1	1	6' X 6'	3	370.0	3.0
NB LT CD 1	1	6' X 50' Q	3-6-3	873.8	3.6
NB LT CD 2	1	6' X 50' Q	3-6-3	846.3	3.0

THE ABOVE VALUES ARE CALCULATED OF COMBINED LOOP AND LEAD-IN INDUCTANCE AND RESISTANCE, ACTUAL MEASURED VALUES SHOULD BE WITHIN +/- 20% OF THESE VALUES.

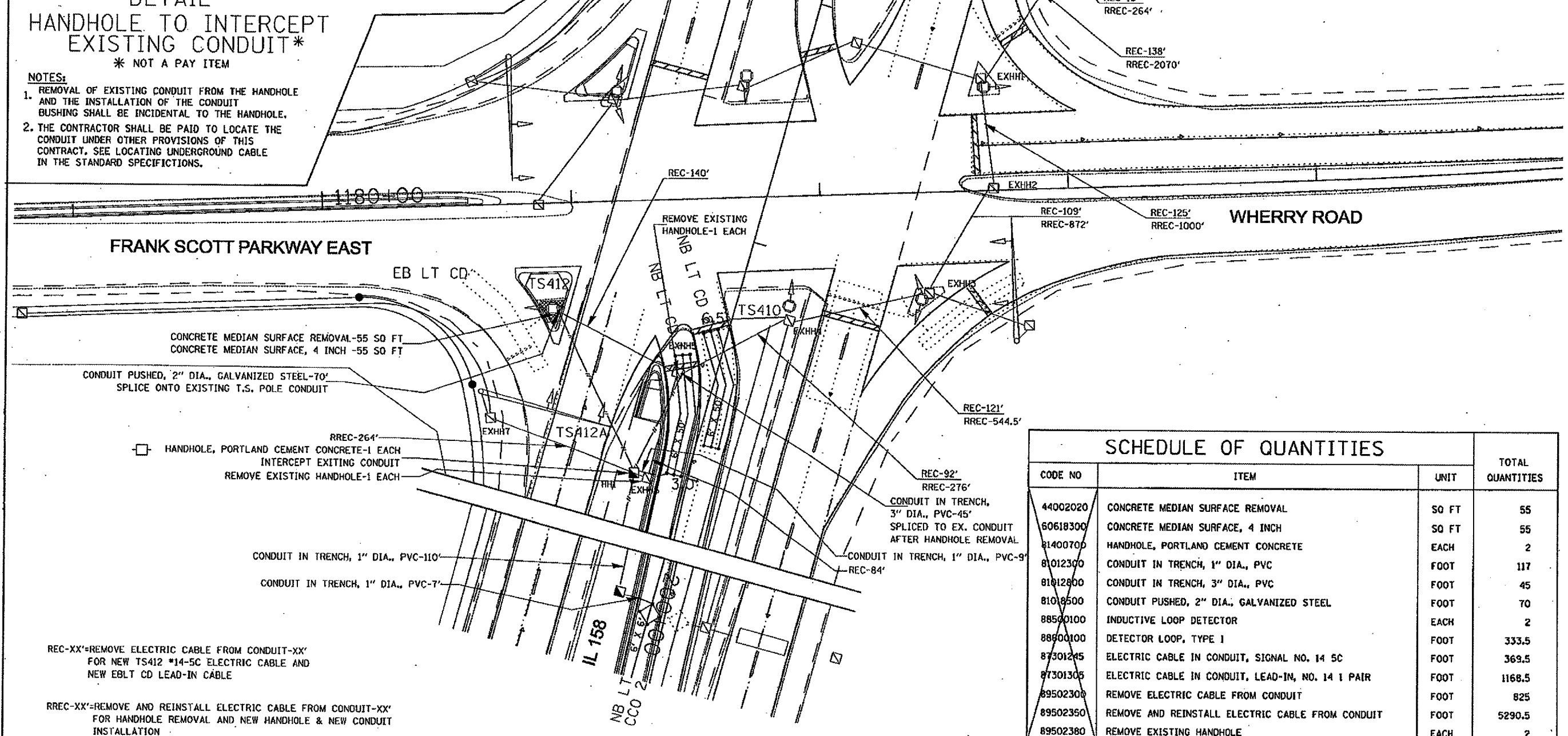

SCHEDULE OF QUANTITIES

CODE NO	ITEM	UNIT	TOTAL QUANTITIES
44002020	CONCRETE MEDIAN SURFACE REMOVAL	SO FT	55
60618300	CONCRETE MEDIAN SURFACE, 4 INCH	SO FT	55
81400700	HANDHOLE, PORTLAND CEMENT CONCRETE	EACH	2
81012300	CONDUIT IN TRENCH, 1" DIA., PVC	FOOT	117
81012800	CONDUIT IN TRENCH, 3" DIA., PVC	FOOT	45
81013500	CONDUIT PUSHED, 2" DIA., GALVANIZED STEEL	FOOT	70
88500100	INDUCTIVE LOOP DETECTOR	EACH	2
88900100	DETECTOR LOOP, TYPE 1	FOOT	333.5
87301245	ELECTRIC CABLE IN CONDUIT, SIGNAL NO. 14 5C	FOOT	369.5
87301305	ELECTRIC CABLE IN CONDUIT, LEAD-IN, NO. 14 1 PAIR	FOOT	1168.5
89502300	REMOVE ELECTRIC CABLE FROM CONDUIT	FOOT	825
89502350	REMOVE AND REINSTALL ELECTRIC CABLE FROM CONDUIT	FOOT	5290.5
89502380	REMOVE EXISTING HANDHOLE	EACH	2