

ROUTE NO.	SECTION	COUNTY	TOTAL SHEETS	SHEET NO.
FAS 1195	(112B) BR-3	KNOX	76	25
FED. ROAD DIST. NO. 7	ILLINOIS	FED. AID PROJECT		

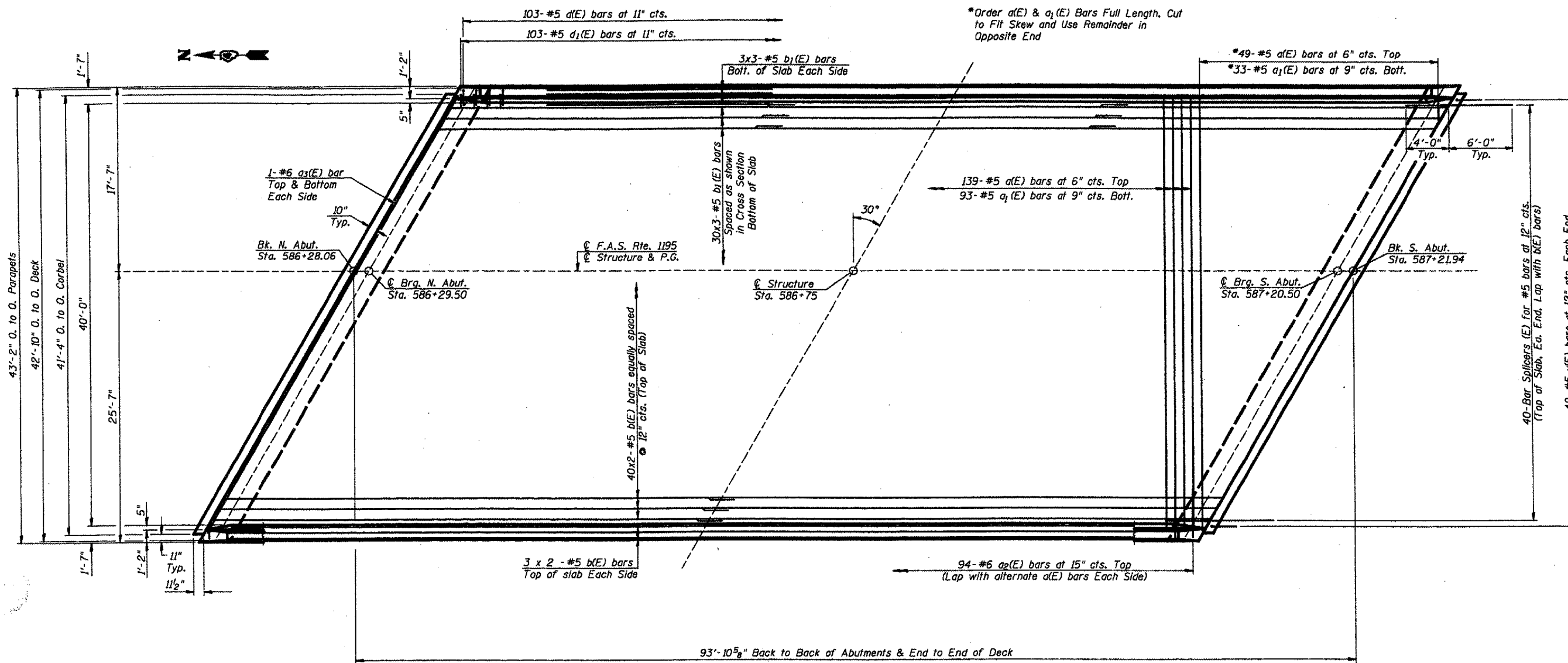

MIN. BAR LAPS	
BAR	LAP
#4	1'-8"
#5	2'-2"
#6	2'-7"
#7	3'-5"
#8	4'-6"

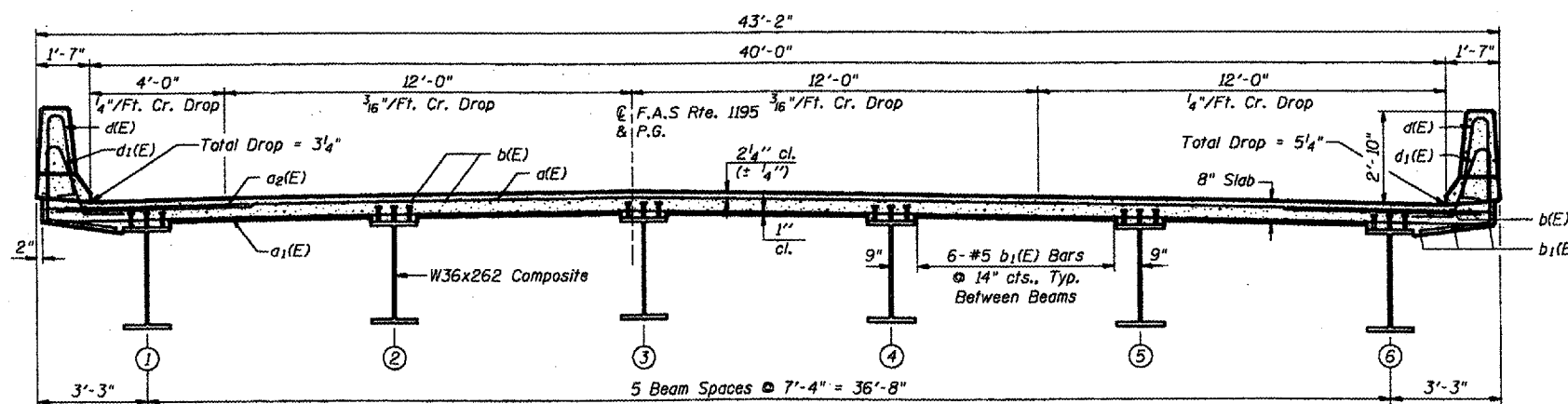

**NOTES:**

Reinforcement bars designated (E) shall be epoxy coated.

Bars indicated thus 40x2-#5 etc. indicates 40 lines of bars with 2 lengths per line.

See Sheet 7 of 12 for parapet details & bill of material.

**SUPERSTRUCTURE**  
**ILLINOIS ROUTE 180 OVER**  
**BRANCH OF BRANDYWINE CREEK**  
**F.A.S. ROUTE 1195 - SECTION (112B)BR-3**  
**KNOX COUNTY**  
**STA. 586+75 (S.N. 048-0089)**