

F.A.S. RTE.	SECTION	COUNTY	TOTAL SHEETS	SHEET NO.
1195	(112B)BR-3	KNOX	76	47
STA.	TO STA.			
FED. ROAD DIST. NO.	ILLINOIS	FED. AID PROJECT		

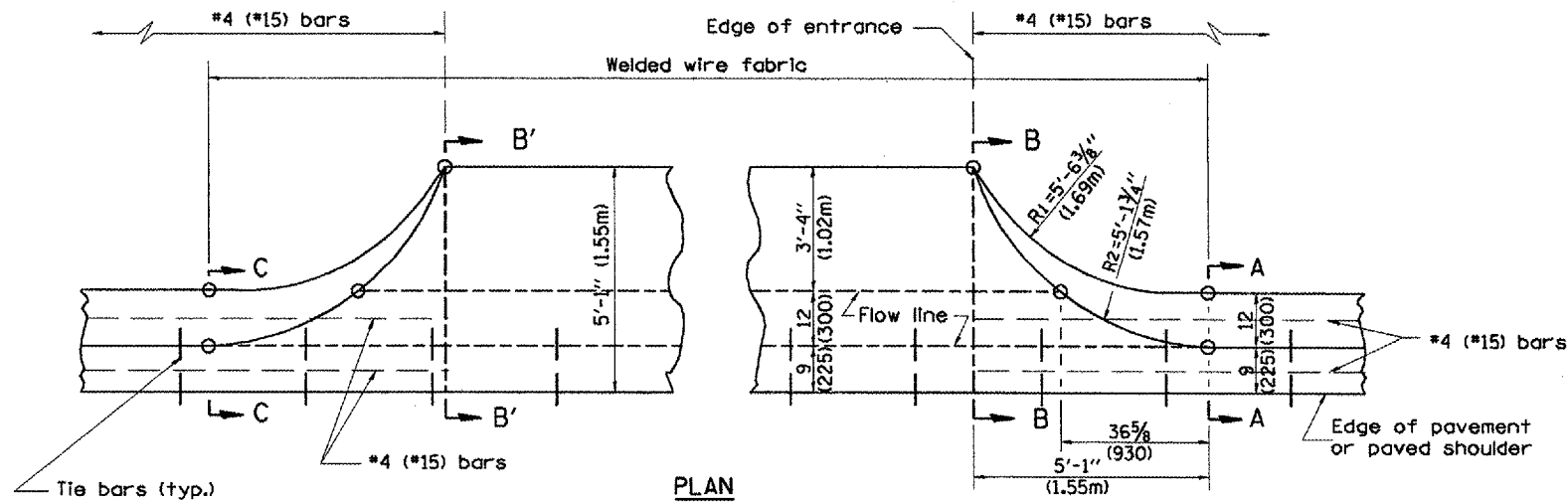

TYPICAL URBAN ENTRANCE

**QUANTITY URBAN ENTRANCE**  
 Section B'-B' to B-B= 0.1 cu. yd./ft.  
 Section C-C to B'-B' + B-B to A-A= 0.69 cu. yd.

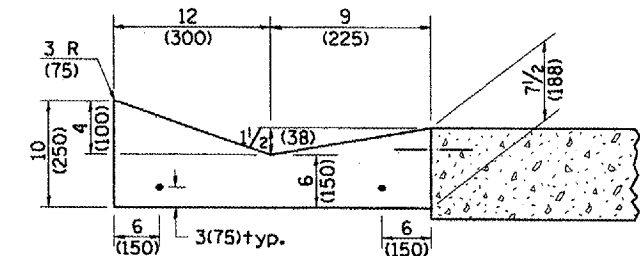

SECTION A-A & C-C

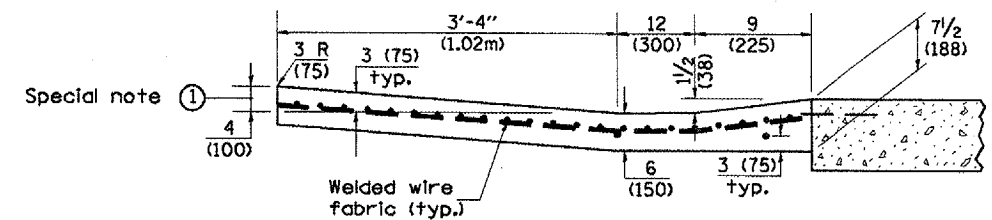

SECTION B-B & B'-B'

**SPECIAL NOTES:**

- ① 4 (100) is the normal dimension. If specified in the plans, the following shall be used for improved entrance match-up: Minimum - 2 1/2 (65) Maximum - 5 (125)

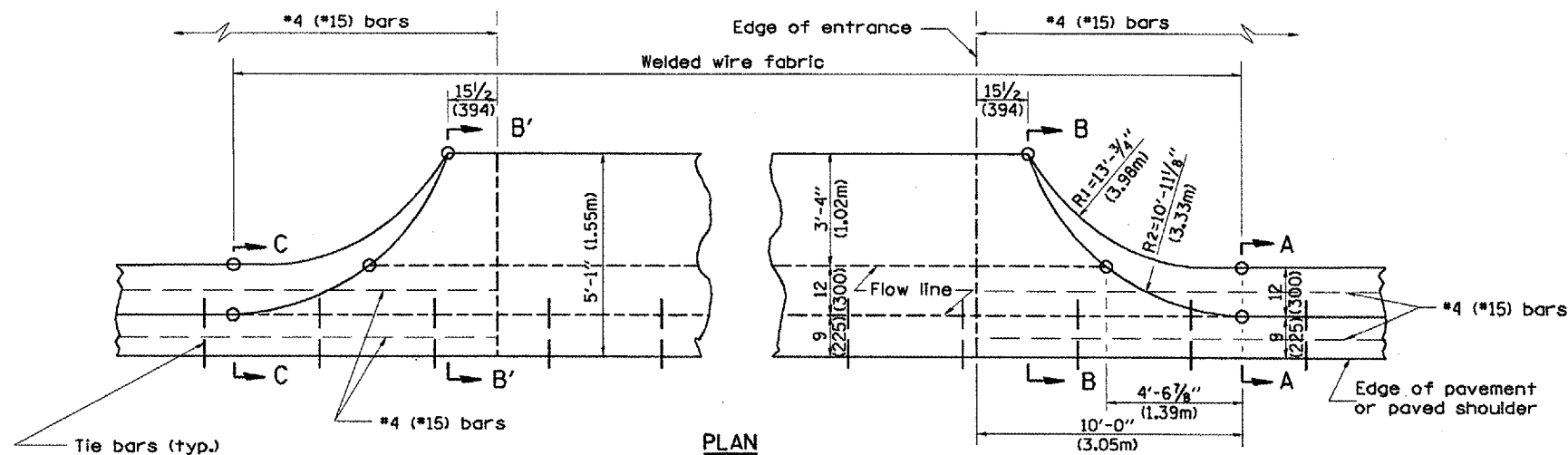

TYPICAL RURAL ENTRANCE

**QUANTITY RURAL ENTRANCE**  
 Section B'-B' to B-B= 0.1 cu. yd./ft.  
 Section C-C to B'-B' + B-B to A-A= 1.19 cu. yd.

All dimensions are in inches (millimeters) unless otherwise noted.

ILLINOIS DEPARTMENT OF TRANSPORTATION	
DISTRICT CADD STANDARD	
TYPE B GUTTER (MODIFIED) (INLET, OUTLET & ENTRANCE)	
CADD STANDARD 606201-D4	SHEET 3 OF 3
SCALE: NOT DRAWN TO SCALE	DRAWN BY CADD CHECKED BY

QUANTITIES	
CALC. BY:	DATE:
CHECKED BY:	DATE:
QUANTITY CALCULATIONS ARE ON FILE AT THE DISTRICT 4 OFFICE, BUREAU OF PROJECT IMPLEMENTATION, DOCUMENTATION SECTION	

\*DGN-ONLY\*