

F.A.U. RTE.	SECTION	COUNTY	TOTAL SHEETS	SHEET NO.
6761	04-00057-06-WR	TAZEWELL	154	30
STA. 61+00 TO STA. 73+00				
FED. ROAD DIST. NO. 4 [ILLINOIS] FED. AID PROJECT				

PLAN	DATE	BY
SURVEYED		
ALIGNED		
CHECKED		
NOTE BOOK NO.		
NO.		

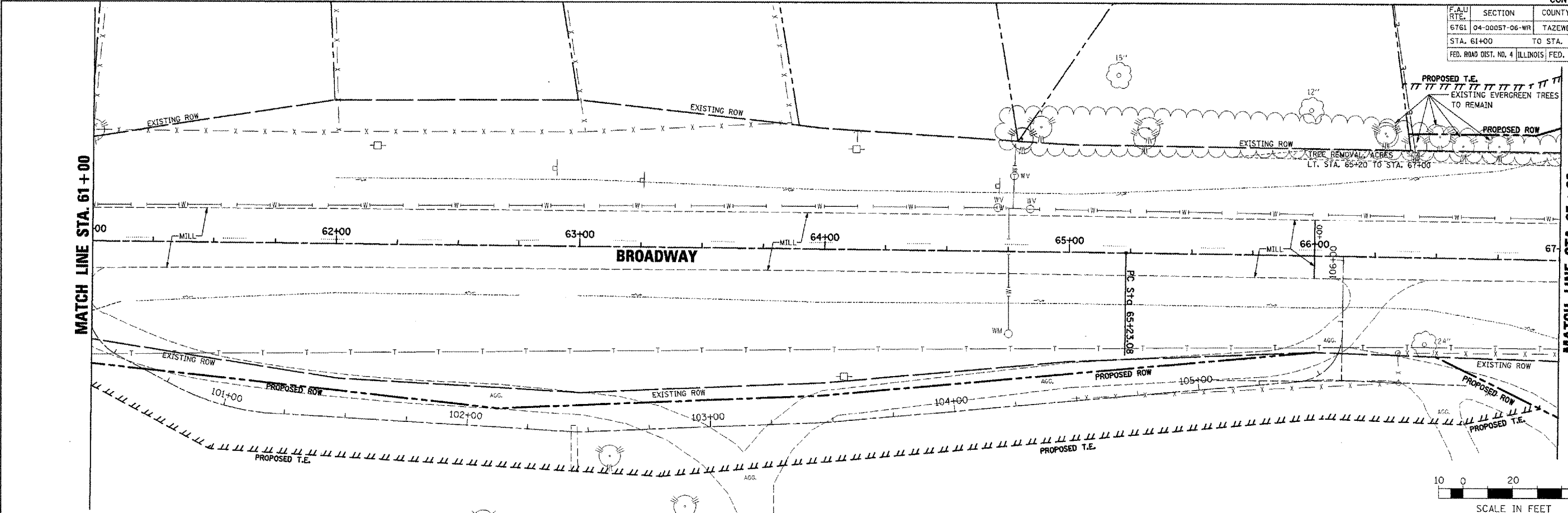

PROFILE	DATE	BY
SURVEYED		
GRADES CHECKED		
NOTE BOOK NO.		
NO.		

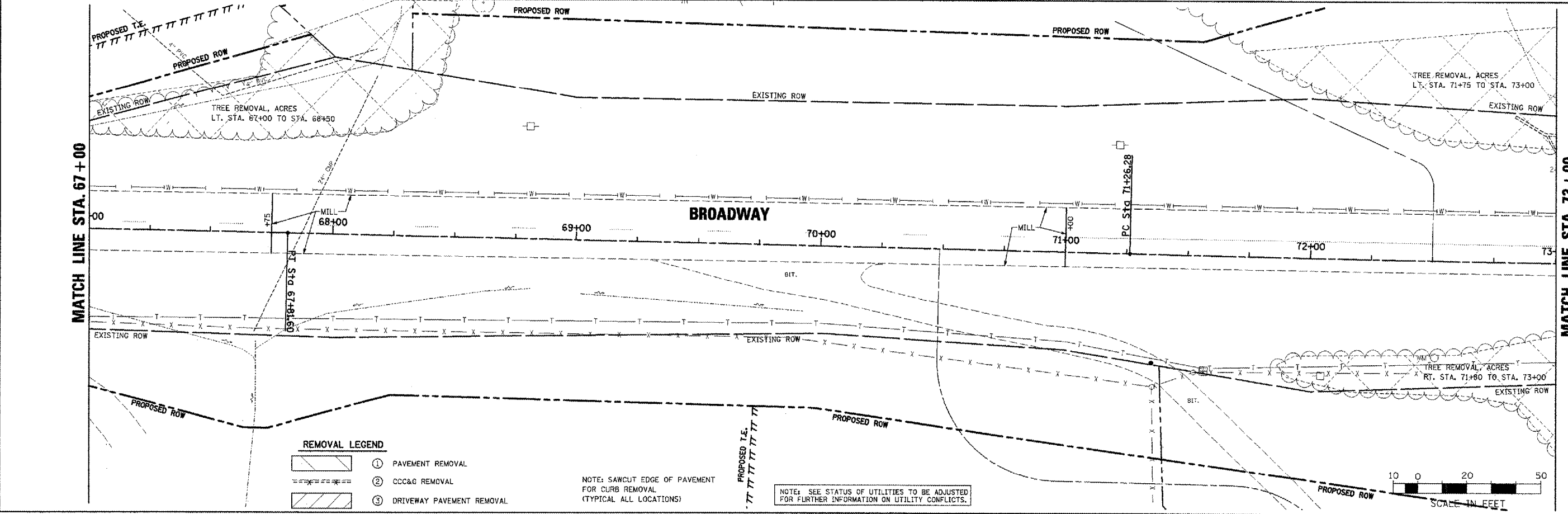

REMOVAL LEGEND

	① PAVEMENT REMOVAL
	② CCC&G REMOVAL
	③ DRIVEWAY PAVEMENT REMOVAL

NOTE: SAWCUT EDGE OF PAVEMENT FOR CURB REMOVAL (TYPICAL ALL LOCATIONS)

NOTE: SEE STATUS OF UTILITIES TO BE ADJUSTED FOR FURTHER INFORMATION ON UTILITY CONFLICTS.

BROADWAY - REMOVAL PLANS - STA. 61+00 TO STA. 73+00