

F.A.U. RTE.	SECTION	COUNTY	TOTAL SHEETS	SHEET NO.
6761	04-00057-06-WR	TAZEWELL	154	47
STA. 1+19.15		TO STA. 13+00		
FED. ROAD DIST. NO. 4		ILLINOIS FED. AID PROJECT		

LEGEND

- DRUMS WITH LIGHTS OR TYPE 1, TYPE 2 BARRICADES
- TYPE III BARRICADES, STD. BLR 17
- DENOTES WORK ZONE
- ① SHORT-TERM PAVEMENT MARKING
- ② TEMPORARY PAVEMENT MARKING - LINE 4" (WHITE)
- ③ TEMPORARY PAVEMENT MARKING - LINE 4" (DOUBLE YELLOW)
- ④ TEMPORARY PAVEMENT MARKING - LINE 24" (WHITE STOP BAR)

NOTE: PLACEMENT OF "END WORK ZONE SPEED LIMIT" SIGN MAY NEED TO BE ADJUSTED IN THE FIELD.

END WORK ZONE SPEED LIMIT
G-20-1103
48" X 30"
LT. STA. 4+00

DATE	BY	REVISION

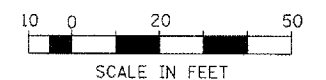
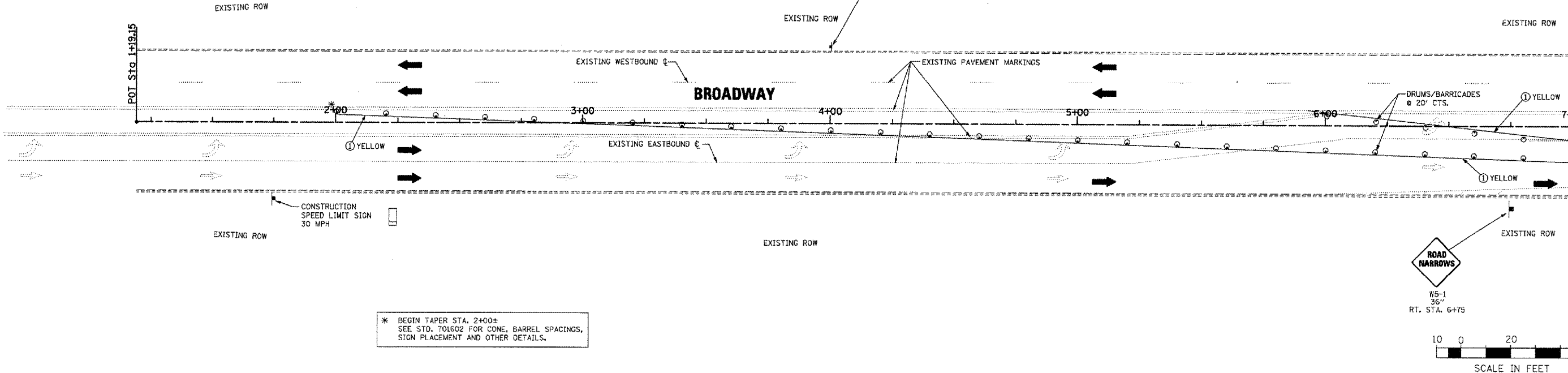

DATE	BY	REVISION

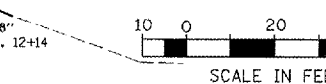
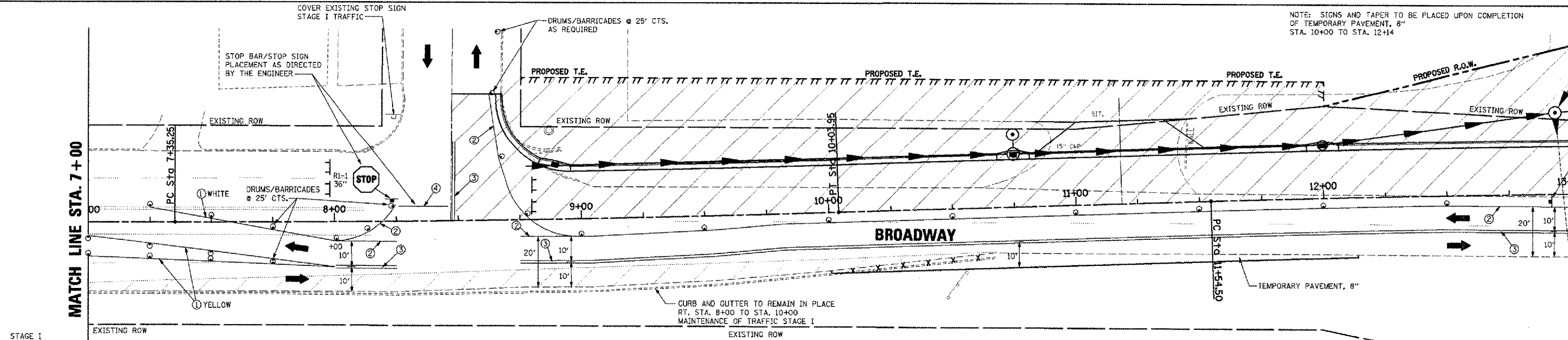

STAGE I DESCRIPTION: PAVEMENT WIDENING LT. SIDE TO STA. 33+00±
EARTHWORK AND DRAINAGE LT. SIDE TO STA. 40+00±

CONSTRUCTION

- UTILITY RELOCATION AND REMOVE EXISTING CCC&G AND INSTALL TEMP. WIDENING RT. STA. 9+76 TO STA. 12+00
- SIGNS, PAVEMENT MARKING REMOVAL, PAVEMENT MARKINGS, AND DRUMS AS REQUIRED FOR LANE TAPER AND LANE SHIFT
- EARTHWORK AND DRAINAGE ITEMS
- PAVEMENT WIDENING, CCC&G AND SHOULDER
- COLD MILL ORIGINAL PAVEMENT IN PREPARATION FOR STAGE II TRAFFIC
- LEVELING BINDER/BINDER COURSE IN PREPARATION FOR STAGE II TRAFFIC
- PAVEMENT MARKINGS IN PREPARATION OF STAGE II

TRAFFIC
HWY STD. 701326 OR 701501

LANE TAPER, LANE SHIFT AS SHOWN
ONE-WAY TRAFFIC AS REQUIRED
HWY STD. 701306 AND 701326

ONE WAY TRAFFIC AS REQUIRED
HWY STD. 701306

ONE WAY TRAFFIC AS REQUIRED
HWY STD. 701306

NOTE: SEE REMOVAL PLANS FOR PAVEMENT MARKING REMOVAL FOR MAINTENANCE OF TRAFFIC STAGING

STAGE I
STA. 8+00 TO STA. 10+00
STA. 12+14 TO STA. 34+00

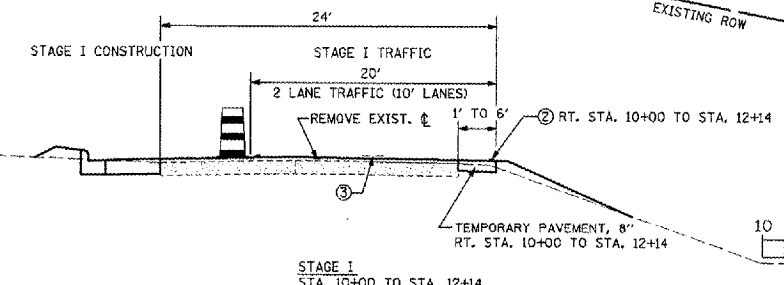

BROADWAY - MAINTENANCE OF TRAFFIC - STAGE I PLANS - STA. 1+19.15 TO STA. 13+00