

F.A.U. RTE.	SECTION	COUNTY	TOTAL SHEET NO.	SHEETS
6761	04-00057-06-WR	TAZEWELL	154	58
STA. 25+00		TO STA. 37+00		
FED. ROAD DIST. NO. 4 ILLINOIS FED. AID PROJECT				

STAGE III
DESCRIPTION: PAVEMENT WIDENING AND DRAINAGE WORK
LT. STA. 33+00 TO STA. 75+00±
SURFACE COURSE
STA. 8+00 TO STA. 78+50

CONSTRUCTION
1. INSTALL TAPER AND TRAFFIC CONTROL
2. REMOVE UNNECESSARY TRAFFIC CONTROL AND SIGNS FROM STAGE II
3. PROPOSED PAVEMENT WIDENING AND DRAINAGE WORK
LT. SIDE STA. 33+00 TO STA. 75+00±

EXISTING ROW

TRAFFIC
HWY STD. 701502 (CASE 1)

HWY STD. 701306 AND 701326 AS REQUIRED

STAGE III (CONTINUED)
DESCRIPTION: PAVEMENT WIDENING AND DRAINAGE WORK
LT. STA. 33+00 TO STA. 75+00±
SURFACE COURSE
STA. 8+00 TO STA. 78+50

CONSTRUCTION
4. PLACE SHORT TERM MARKING TAPE
5. CUT BUTT JOINTS
6. FINISH SURFACE COURSE ON PAVEMENT AND SHOULDERS
7. PERMANENT SEEDING AND PERMANENT PAVEMENT MARKINGS

TRAFFIC
HWY STD. 701306

G-20-1103
48" X 30"
RT. STA. 34+00
(RELOCATED FROM STAGE II)

END WORK ZONE SPEED LIMIT

NOTE: PLACEMENT OF "END WORK ZONE SPEED LIMIT" SIGN MAY NEED TO BE ADJUSTED IN THE FIELD DUE TO EXCAVATION ACTIVITIES.

350' TAPER
HWY. STD. 701502 (CASE 1)

YELLOW

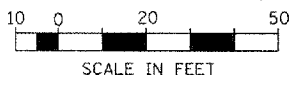

PLAN

DATE	
BY	
CHECKED	
DATE	
NO.	

REVISIONS

NO.	DATE	DESCRIPTION

PROFILE

DATE	
BY	
CHECKED	
DATE	
NO.	

REVISIONS

NO.	DATE	DESCRIPTION

PLOT DATE = 2/20/2010
PLOT SCALE = 1" = 20'
USER NAME = IDOT

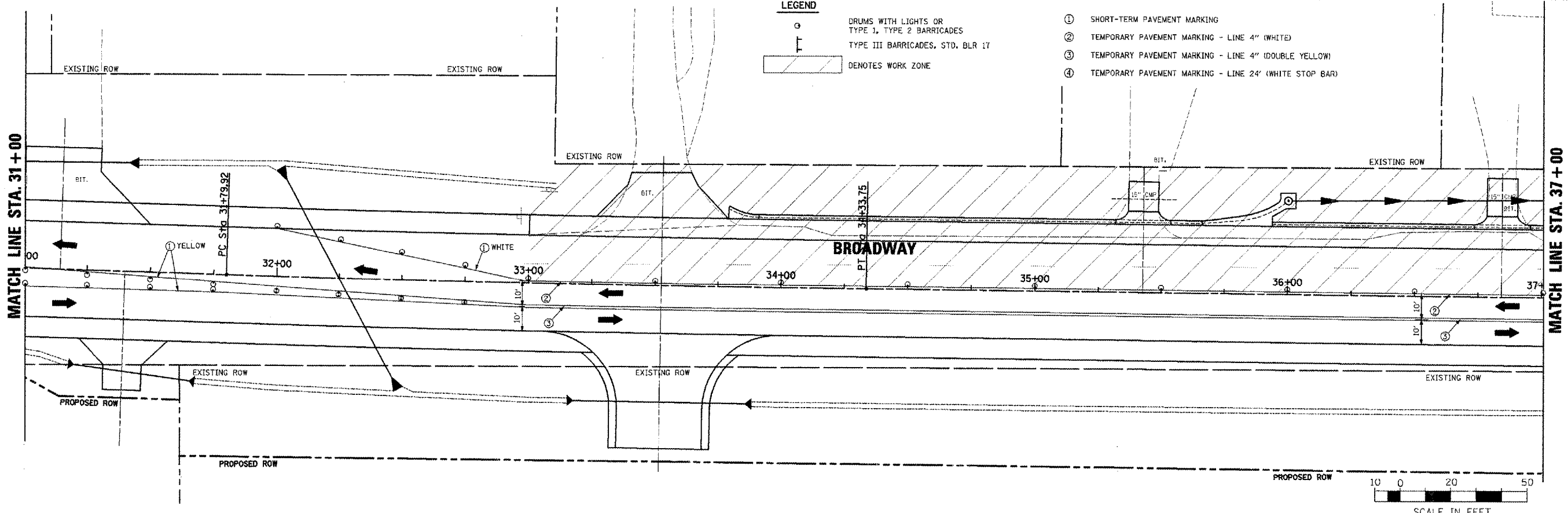
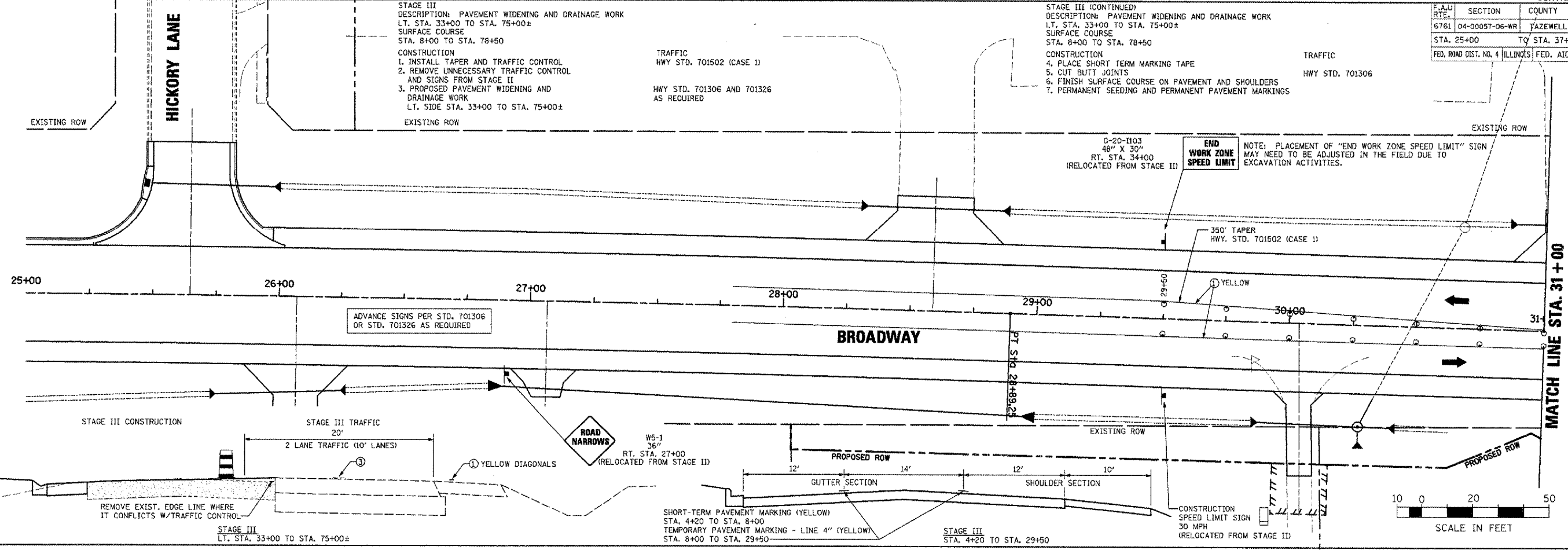

LEGEND

- DRUMS WITH LIGHTS OR TYPE 1, TYPE 2 BARRICADES
- TYPE III BARRICADES, STD. BLR 17
- ▨ DENOTES WORK ZONE
- ① SHORT-TERM PAVEMENT MARKING
- ② TEMPORARY PAVEMENT MARKING - LINE 4" (WHITE)
- ③ TEMPORARY PAVEMENT MARKING - LINE 4" (DOUBLE YELLOW)
- ④ TEMPORARY PAVEMENT MARKING - LINE 24" (WHITE STOP BAR)

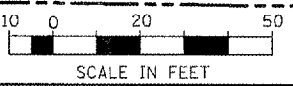

BROADWAY - MAINTENANCE OF TRAFFIC - STAGE III PLANS - STA. 25+00 TO STA. 37+00