

CONTRACT NO. 89347				
F.A.U. RTE.	SECTION	COUNTY	TOTAL SHEETS	SHEET NO.
6761	04-00057-06-WR	TAZEWELL	154	65
STA. 25+00		TO STA. 37+00		
FED. ROAD DIST. NO. 4 ILLINOIS FED. AID PROJECT				

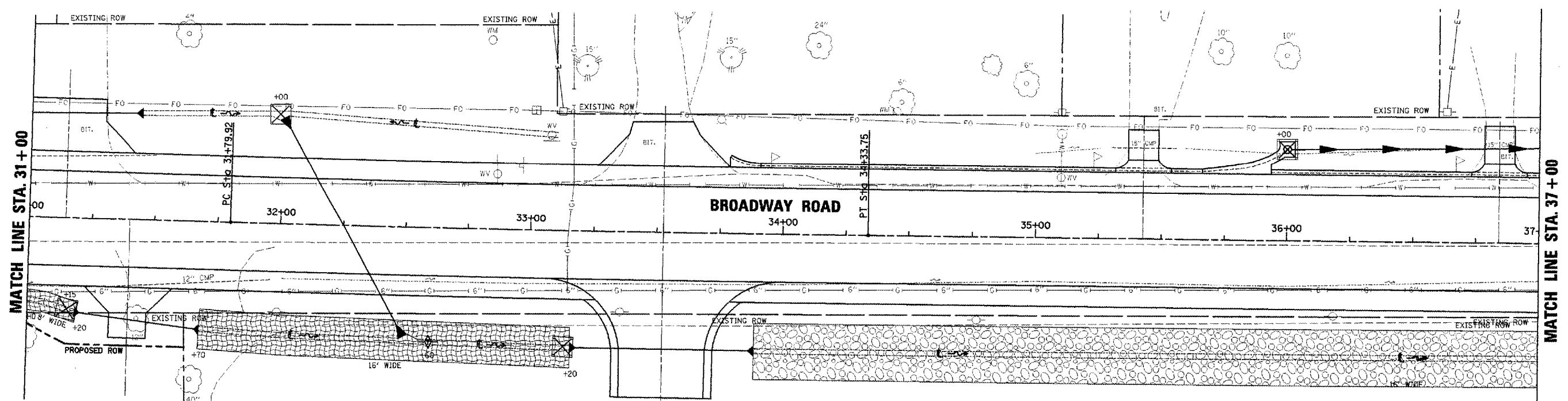
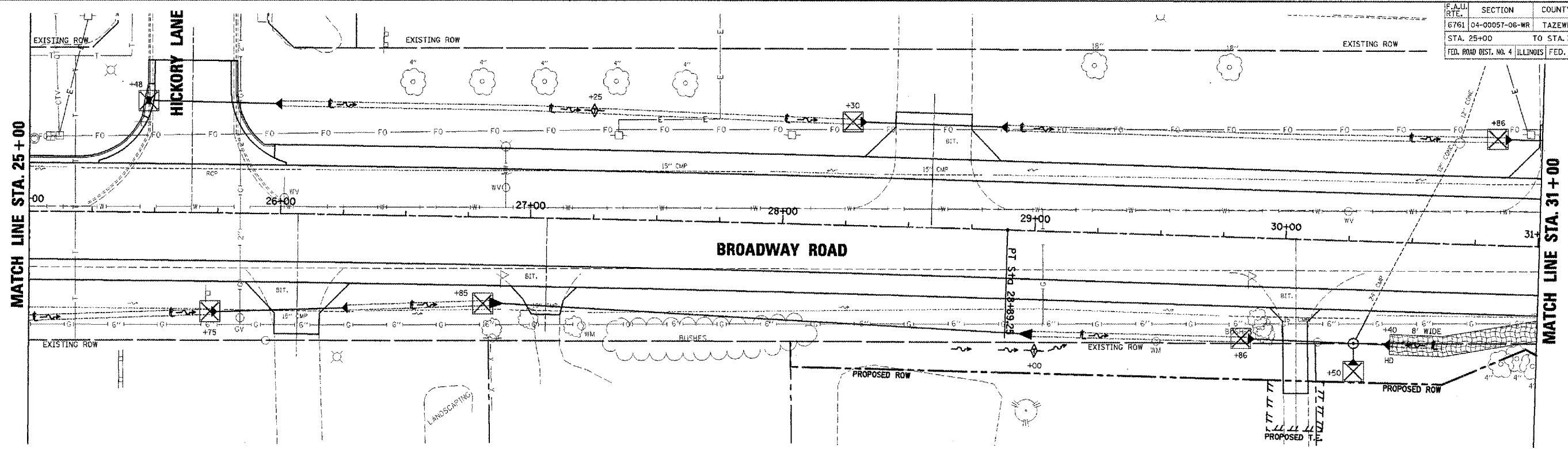

- TEMPORARY EROSION CONTROL LEGEND**
- TEMPORARY DITCH CHECK
  - INLET AND PIPE PROTECTION
  - EROSION CONTROL BLANKET
  - HEAVY DUTY EROSION CONTROL BLANKET
  - PERIMETER EROSION BARRIER
  - AGGREGATE DITCH (TO BE PLACED UPON COMPLETION OF DITCH CUT) (SEE DRAINAGE PLANS FOR MORE INFO)
  - STONE DUMPED RIPRAP (TO BE PLACED UPON COMPLETION OF DITCH CUT) (SEE DRAINAGE PLANS FOR MORE INFO)

	PERMANENT SEEDING		
	SEEDING CLASS 1A ACRE	SEEDING CLASS 2A ACRE	SEEDING CLASS 5A ACRE
LT. STA. 25+00 TO STA. 31+00	0.27	-	-
RT. STA. 25+00 TO STA. 31+00	0.32	-	-
LT. STA. 31+00 TO STA. 37+00	0.25	-	-
RT. STA. 31+00 TO STA. 31+65	0.02	-	-
RT. STA. 31+65 TO STA. 37+00	-	0.50	-

REVISIONS	
NAME	DATE

ILLINOIS DEPARTMENT OF TRANSPORTATION  
**BROADWAY ROAD IMPROVEMENTS**  
**EROSION CONTROL**  
**STA. 25+00 TO STA. 37+00**

SCALE: AS SHOWN  
DATE 12/07/2007

DRAWN BY: DLC  
CHECKED BY: REW

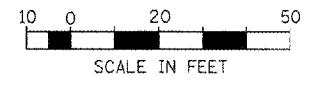

PLOT DATE = 2/18/2008  
FILE NAME = I:\2008\02\07\plan\plan\erosion\03 25-37.dgn  
PLOT SCALE = 28.4288 FT / IN.  
USER NAME = TD07