

SUMMARY OF QUANTITIES

ROUTE NO.	SECTION	COUNTY	TOTAL SHEETS	SHEET NO.
CH 11	*	EDGAR	160	4
FED. ROAD DIST. NO. 5		ILLINOIS	PROJECT	

\* 05-00092-01-PV

CODE NUMBER	DESCRIPTION	UNITS	80% FED 20% LOCAL 1000-2A QUANTITY
542D0226	PIPE CULVERTS, CLASS D, TYPE 1, 21"	FOOT	36
54213663	PRECAST REINFORCED CONCRETE FLARED END SECTION 18"	EACH	12
54213669	PRECAST REINFORCED CONCRETE FLARED END SECTION 24"	EACH	2
54213675	PRECAST REINFORCED CONCRETE FLARED END SECTION 30"	EACH	2
54213681	PRECAST REINFORCED CONCRETE FLARED END SECTION 36"	EACH	2
54213693	PRECAST REINFORCED CONCRETE FLARED END SECTION 48"	EACH	2
61100605	MISCELLANEOUS CONCRETE	CU YD	4
• 61101009	STORM SEWER PROTECTED, CLASS A, 8"	FOOT	258
• 61101011	STORM SEWER PROTECTED, CLASS A, 10"	FOOT	88
• 61101013	STORM SEWER PROTECTED, CLASS A, 12"	FOOT	90
• 61101020	STORM SEWER PROTECTED, CLASS A, 18"	FOOT	280
• 61101026	STORM SEWER PROTECTED, CLASS A, 24"	FOOT	187
Δ (63000025)	STEEL PLATE BEAM GUARD RAIL ATTACHED TO STRUCTURES	FOOT	25
• 63100045	TRAFFIC BARRIER TERMINAL, TYPE 2	EACH	2
Δ 63100167	TRAFFIC BARRIER TERMINAL, TYPE 1, SPECIAL (TANGENT)	EACH	2
63500205	REMOVE AND REPLACE DELINEATORS	EACH	14
66600105	FURNISHING AND ERECTING RIGHT-OF-WAY MARKERS	EACH	97
67000400	ENGINEERS FIELD OFFICE, TYPE A	CAL MO	5
67100100	MOBILIZATION	L SUM	1
• 67201000	SEALING ABANDONED WATER WELLS	EACH	1
70101860	TRAFFIC CONTROL AND PROTECTION STANDARD BLR 22 (SPECIAL)	L SUM	1
72000100	SIGN PANEL, TYPE 1	SQ FT	32
72900200	METAL POST, TYPE B	FOOT	58
Δ 78008210	POLYUREA PAVEMENT MARKING TYPE 1 LINE 4"	FOOT	33,910
Δ 78008270	POLYUREA PAVEMENT MARKING TYPE 1 LINE 24"	FOOT	132
Δ 78100100	RAISED REFLECTIVE PAVEMENT MARKER	EACH	184
X0301232	SURVEY MARKER VAULTS	EACH	5
X0974300	SIGN REMOVAL	EACH	5
XX001017	REMOVE RIGHT-OF-WAY MARKERS	EACH	1
XX002957	REMOVE AND RE-ERECT EXISTING SIGN	EACH	9
XX003949	CONSTRUCTION STAKING	L SUM	1
Z0030900	INSPECTION WELLS	EACH	16

Revised 4-3-08 Δ

• SEE SPECIAL PROVISIONS  
Δ SPECIALTY ITEMS

REVISIONS				SHILOH ROAD (CH 11) EDGAR COUNTY, ILLINOIS		DRAWN BY DATE RLK 7/07
No.	DATE	INITIALS		CHECKED BY DATE CAS 7/07	PROJECT No. 469	BOOK NUMBER 469
1					PROJECT No. 5245	SHEET No.
2						
3						
4						
5						
6						
7						
8						
9						
10						

**HOMER L. CHASTAIN & ASSOCIATES, LLP**  
CONSULTING ENGINEERS  
184-00127

DECATUR CHICAGO  
(317) 422-8644 (773) 714-0050

ROCKFORD  
(815) 489-0050

DATE	
BY	
REVISION	
NO.	
PLAN	
NO.	
NO.	
NO.	
NO.	

CHASTAIN  
 CONSULTING ENGINEERS  
 1000 N. LAUREL STREET  
 CHICAGO, ILL. 60610  
 (312) 467-1000

DATE	
BY	
REVISION	
NO.	
PROFILE	
NO.	
NO.	
NO.	
NO.	

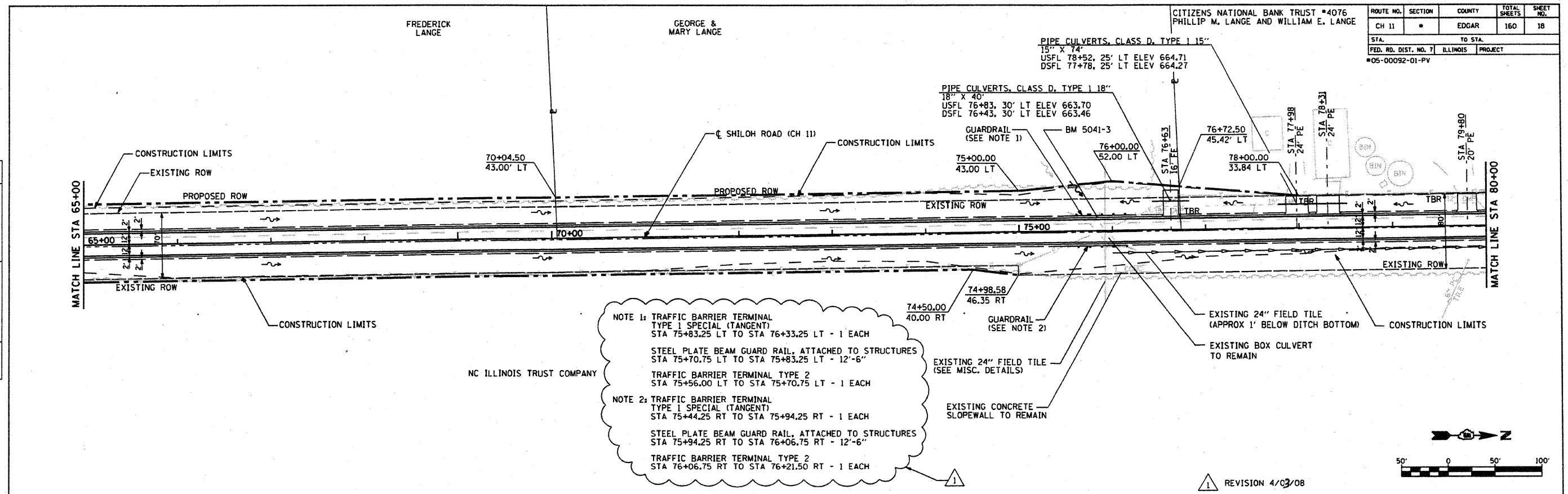

NOTE 1: TRAFFIC BARRIER TERMINAL TYPE 1 SPECIAL (TANGENT) STA 75+83.25 LT TO STA 76+33.25 LT - 1 EACH

STEEL PLATE BEAM GUARD RAIL, ATTACHED TO STRUCTURES STA 75+70.75 LT TO STA 75+83.25 LT - 12'-6"

TRAFFIC BARRIER TERMINAL TYPE 2 STA 75+56.00 LT TO STA 75+70.75 LT - 1 EACH

NOTE 2: TRAFFIC BARRIER TERMINAL TYPE 1 SPECIAL (TANGENT) STA 75+44.25 RT TO STA 75+94.25 RT - 1 EACH

STEEL PLATE BEAM GUARD RAIL, ATTACHED TO STRUCTURES STA 75+94.25 RT TO STA 76+06.75 RT - 12'-6"

TRAFFIC BARRIER TERMINAL TYPE 2 STA 76+06.75 RT TO STA 76+21.50 RT - 1 EACH

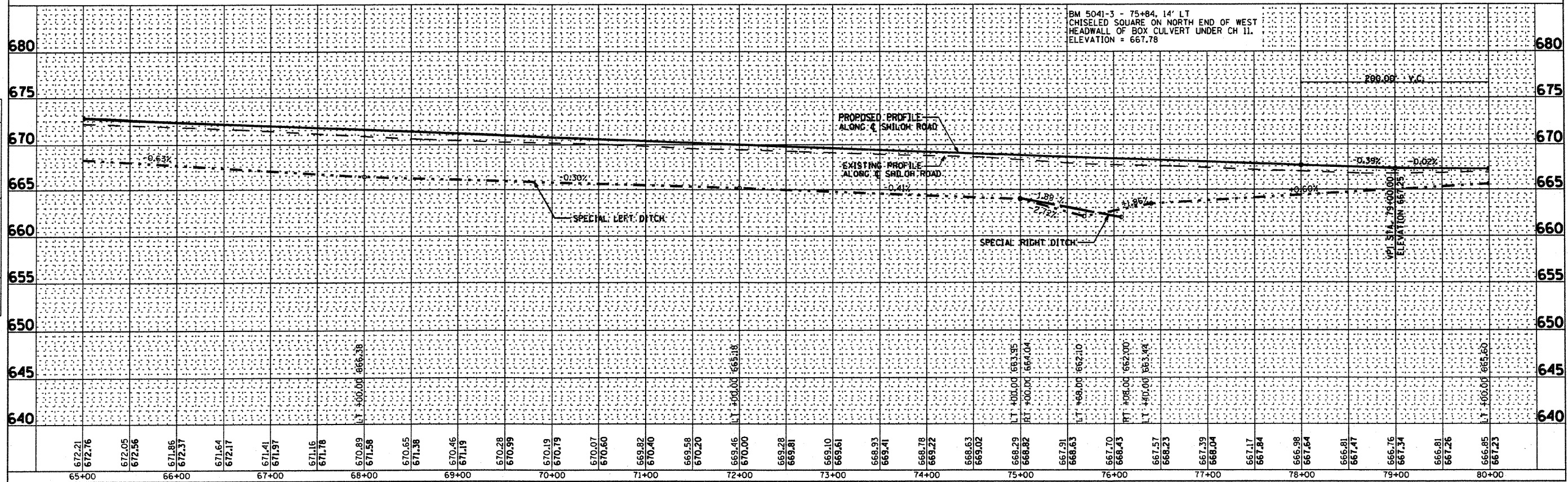

STA 65+00 TO STA 80+00 SHILOH ROAD (CH 11)