

DATE	
BY	
FINAL SURVEY	
NOTED	
PLOTTED	
TEMPLATE	
AREAS	
CHECKED	
NO.	

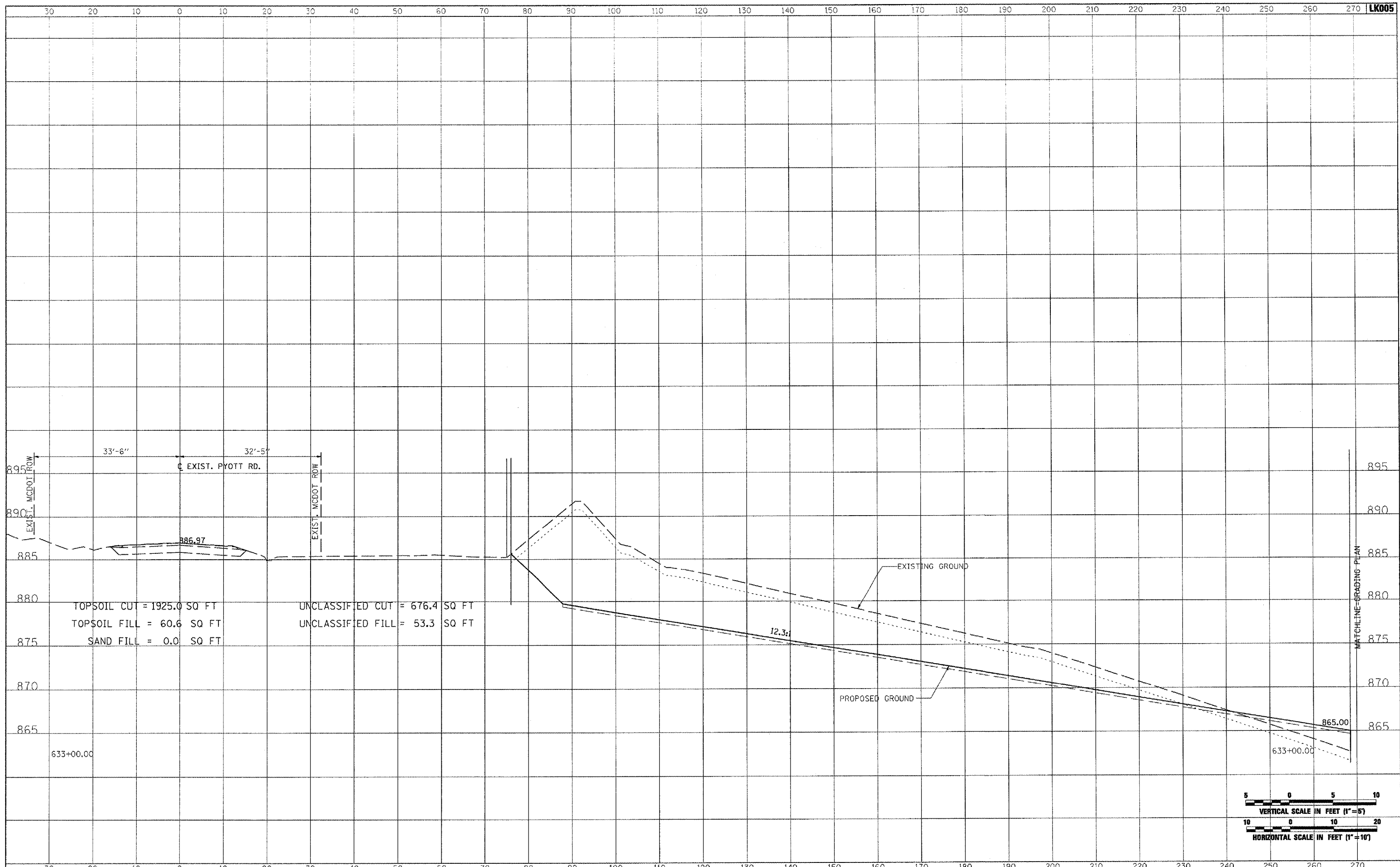

DATE	
BY	
ORIGINAL SURVEY	
NOTED	
PLOTTED	
TEMPLATE	
AREAS	
CHECKED	
NO.	



FILE NAME =	USER NAME = MoLou01058	DESIGNED - CBP	REVISED -	VILLAGE OF LAKE IN THE HILLS, ILLINOIS	CROSS SECTIONS EXISTING PYOTT ROAD			COUNTY	TOTAL SHEETS	SHEET NO.			
I:\05\Jobs\00941\0598021\Civil Part A\Sheets\CROSS SECTIONS_CurPyott.dwg		DRAWN - CBP	REVISED -		MCHENRY	120	99						
PLOT SCALE = 20.0000' / IN.		CHECKED - BLB	REVISED -										
PLOT DATE = 02/28/2008, 09:36 AM		DATE - 02/29/08	REVISED -										
					SCALE: AS SHOWN	SHEET NO.	OF	SHEETS	STA. 633+00.00	TO STA. 633+00.00	FEDERAL AIP, NO. 3-17-0112-BB	ILLINOIS	IDA NO. 30X-9671