

NOTES:

1. CONTRACTOR SHALL MAINTAIN EROSION CONTROL MEASURES UNTIL FINAL ACCEPTANCE IN ACCORDANCE WITH THE CONTRACT DOCUMENTS.
2. MAINTENANCE OF PERMANENT EROSION CONTROL MEASURES AFTER FINAL ACCEPTANCE BY VILLAGE OF LAKE IN THE HILLS.

Hanson Professional Services, Inc.
 Suite 200, 815 Commerce Drive
 Oak Brook, Illinois 60521
 © Copyright Hanson Professional Services, Inc. 2008



LEGEND

- CONSERVATION COVER
- SALT TOLERANT GRASS
- NATIVE MIX (NO FERTILIZER)
- DITCH BOTTOM EROSION CONTROL BLANKET
- CONCRETE CABLE BOTTOM
- RIPRAP
- FRACTURED STONE CONSTRUCTION ENTRANCE, PAID UNDER ITEM AR803017
- PERIMETER EROSION CONTROL BARRIER
- TEMPORARY DITCH CHECK
- FES PROTECTION

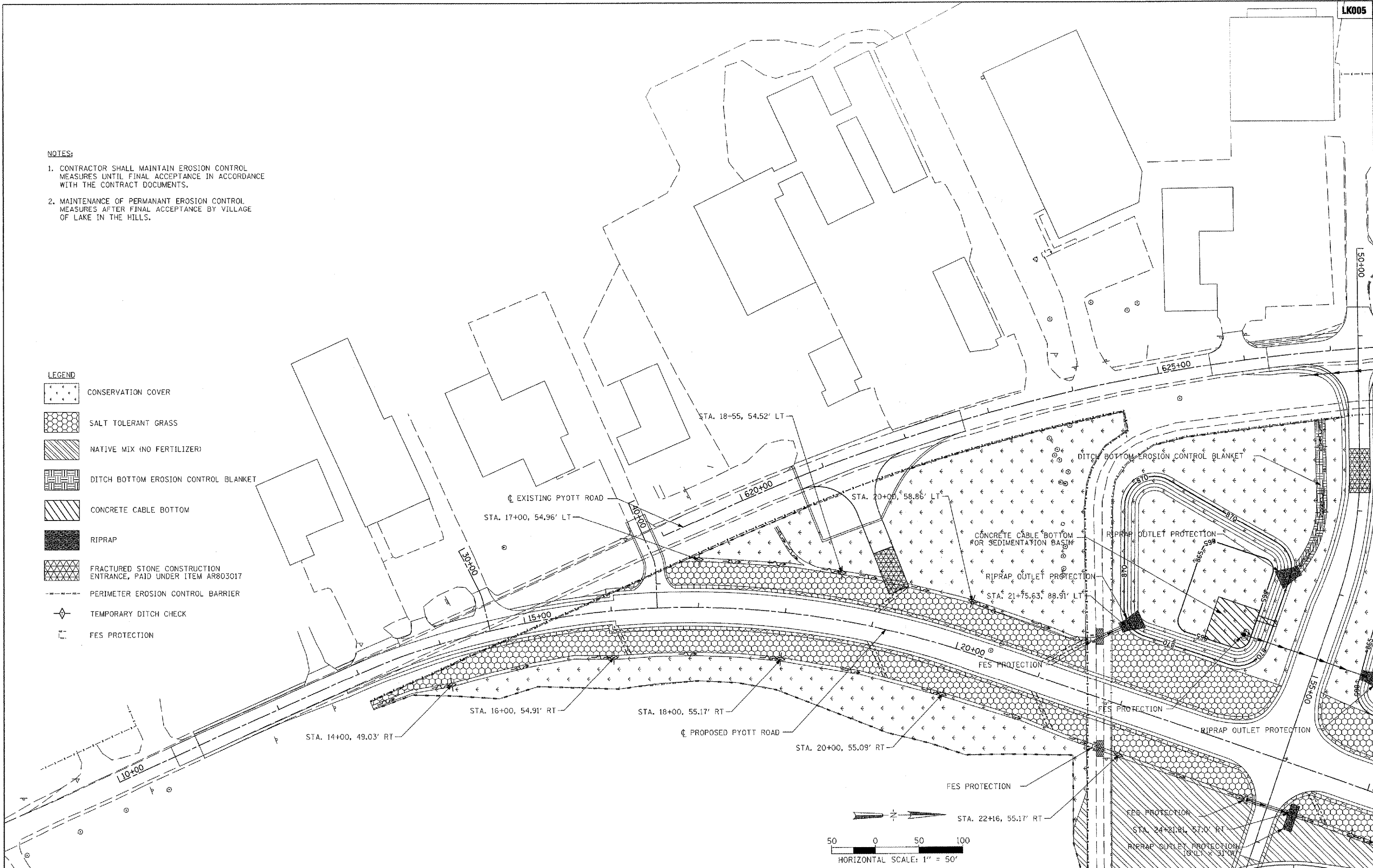

FILE NAME = I:\05Jobs\00041\0508021\Civil Part A\Sheet\05-C-ERCL.sht	USER NAME = McLau01058	DESIGNED - SJM	REVISED -	VILLAGE OF LAKE IN THE HILLS, ILLINOIS	EROSION CONTROL PLAN PYOTT ROAD		COUNTY	TOTAL SHEETS	SHEET NO.
PLOT SCALE = 1/8" = 1' / IN.	CHECKED - BLB	DATE - 02/29/08	REVISED -		MCHENRY	120	108		
PLOT DATE = 02/28/2008, 08:49 AM	DATE - 02/29/08	REVISED -	SCALE: 1"=50'		FEDERAL AIP NO. 3-17-0112-08 ILLINOIS IDA NO. 3CK-3671				