

HORIZONTAL AND VERTICAL CONTROL				
POINT #	NORTHING	EASTING	ELEVATION	DESCRIPTION
255	2016389.740	2581115.600	697.930	IRON PIN
305	2016209.025	2582637.650	715.591	IRON PIN
314	2018097.742	2583635.925	706.427	CHISELED "X"
316	2018123.703	2585272.240	725.570	CHISELED "X"
318	2014974.404	2581879.027	720.449	IRON PIN
319	2014810.122	2581182.919	723.902	IRON PIN

LEGEND

- NEW 16" P.C.C. APRON/TAXIWAY
- NEW BITUMINOUS APRON
- NEW BITUMINOUS SHOULDER
- EXISTING BUILDING
- NEW STORM SEWER
- NEW SANITARY SEWER
- FUTURE PAVEMENT/BUILDING
- EXISTING OVERHEAD ELECTRIC
- NEW FENCE
- EXISTING FENCE

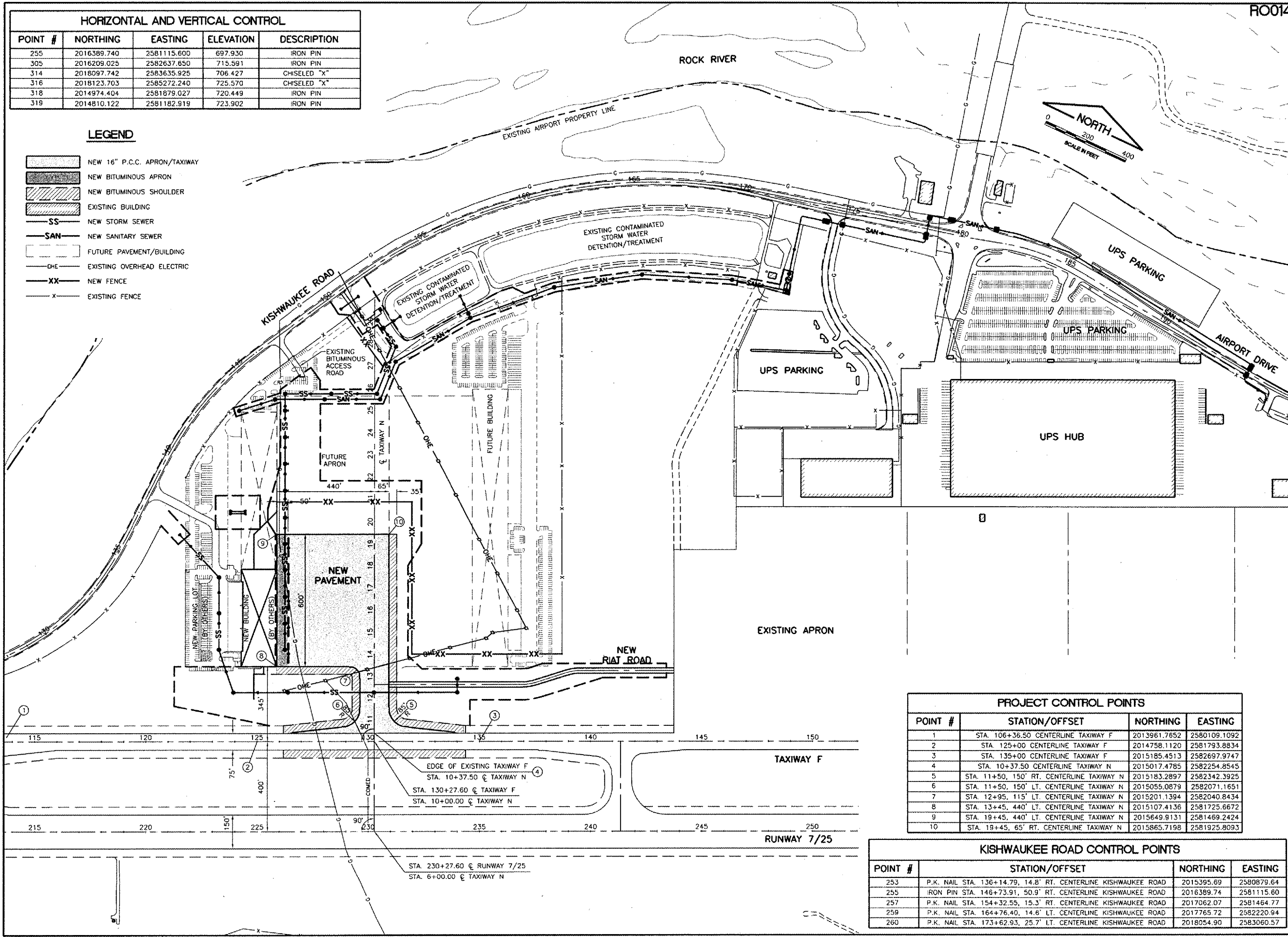

REVISIONS		
NUMBER	BY	DATE

0 1 2
 THIS BAR IS EQUAL TO 2"
 AT FULL SCALE (34X22).

CHICAGO ROCKFORD INTERNATIONAL AIRPORT
 ROCKFORD, ILLINOIS

SITE PLAN/
 HORIZONTAL AND VERTICAL CONTROL

PROJECT CONTROL POINTS			
POINT #	STATION/OFFSET	NORTHING	EASTING
1	STA. 106+36.50 CENTERLINE TAXIWAY F	2013961.7652	2580109.1092
2	STA. 125+00 CENTERLINE TAXIWAY F	2014758.1120	2581793.8834
3	STA. 135+00 CENTERLINE TAXIWAY F	2015185.4513	2582697.9747
4	STA. 10+37.50 CENTERLINE TAXIWAY N	2015017.4785	2582254.8545
5	STA. 11+50, 150' RT. CENTERLINE TAXIWAY N	2015183.2897	2582342.3925
6	STA. 11+50, 150' LT. CENTERLINE TAXIWAY N	2015055.0879	2582071.1651
7	STA. 12+95, 115' LT. CENTERLINE TAXIWAY N	2015201.1394	2582040.8434
8	STA. 13+45, 440' LT. CENTERLINE TAXIWAY N	2015107.4136	2581725.6672
9	STA. 19+45, 440' LT. CENTERLINE TAXIWAY N	2015649.9131	2581469.2424
10	STA. 19+45, 65' RT. CENTERLINE TAXIWAY N	2015865.7198	2581925.8093

KISHWAUKEE ROAD CONTROL POINTS			
POINT #	STATION/OFFSET	NORTHING	EASTING
253	P.K. NAIL STA. 136+14.79, 14.8' RT. CENTERLINE KISHWAUKEE ROAD	2015395.69	2580879.64
255	IRON PIN STA. 146+73.91, 50.9' RT. CENTERLINE KISHWAUKEE ROAD	2016389.74	2581115.60
257	P.K. NAIL STA. 154+32.55, 15.3' RT. CENTERLINE KISHWAUKEE ROAD	2017062.07	2581464.77
259	P.K. NAIL STA. 164+76.40, 14.6' LT. CENTERLINE KISHWAUKEE ROAD	2017765.72	2582220.94
260	P.K. NAIL STA. 173+62.93, 25.7' LT. CENTERLINE KISHWAUKEE ROAD	2018054.90	2583060.57

© Copyright CMT, Inc.

CMT
 CRAWFORD, MURPHY & TILLY, INC.
 CONSULTING ENGINEERS
 License No. 184-000813

Chicago Rockford International Airport

DESIGN BY: DKP
 DRAWN BY: JRO
 CHECKED BY: CAL
 APPROVED BY:
 DATE: 02/29/08
 JOB No: 07258-06
 ILLINOIS PROJECT: RFD-3787
 A.I.P. PROJECT: 3-17-0088-XX
FINAL SUBMITTAL
 SHEET 3 OF 83 SHEETS