

MATCHLINE STA. 18+75

RO014

K:\Rockford\072586 NW Air Cargo Dev\Draw\Sheet
 FILE: Nw-acord-1.dwg
 LAYOUT: Layout1
 UPDATE BY: Jeremy Linke
 SURVEY BOOK #
 DATE: Thursday, April 03, 2008 11:25:32 AM
 XREF DWG: tbcint.dwg
 nwc-base.dwg
 etopo.dwg
 topo.DWG
 newfillwest.DWG
 etopo by others.dwg

THE INFORMATION SHOWN ON THESE PLANS HAS BEEN OBTAINED FROM AVAILABLE RECORDS AND FIELD SURVEYS. NEITHER THE OWNER NOR THE ENGINEER ASSUMES ANY RESPONSIBILITY WITH RESPECT TO THE ACCURACY OR SUFFICIENCY OF THE INFORMATION PRESENTED HEREIN AND THERE IS NO GUARANTEE, EITHER EXPRESSED OR IMPLIED, THAT THE CONDITIONS INDICATED ARE REPRESENTATIVE OF THOSE TO BE ENCOUNTERED IN THE FIELD. IT SHALL BE THE CONTRACTOR'S RESPONSIBILITY TO VISIT THE SITE AND ACQUAINT HIMSELF WITH THE EXISTING CONDITIONS.

LEGEND

[Symbol]	EXISTING BITUMINOUS PAVEMENT TO BE REMOVED
[Symbol]	EXISTING UNDERDRAIN
[Symbol]	EXISTING INLET/MANHOLE/HEADWALL
[Symbol]	EXISTING STORM SEWER
[Symbol]	EXISTING UNDERDRAIN CLEANOUT/INSPECTION HOLE
[Symbol]	EXISTING BASE MOUNTED MEDIUM INTENSITY TAXIWAY LIGHT
[Symbol]	EXISTING FLARED END SECTION
[Symbol]	EXISTING DUCT/CONDUIT (NUMBER OF WAYS)
[Symbol]	EXISTING TAXIWAY CIRCUIT
[Symbol]	EXISTING OVERHEAD ELECTRIC CABLES.
[Symbol]	EXISTING STRUCTURE/LIGHT TO BE REMOVED
[Symbol]	EXISTING FENCE
[Symbol]	EXISTING SANITARY SEWER
[Symbol]	EXISTING GAS LINE
[Symbol]	EXISTING ELECTRIC CABLE
[Symbol]	EXISTING COMED ELECTRIC CABLE
[Symbol]	EXISTING ELECTRIC TRANSFORMER
[Symbol]	EXISTING WATERMAIN
[Symbol]	EXISTING TELEPHONE CABLE
[Symbol]	EXISTING CONTOUR
[Symbol]	NEW GRADING LIMITS

NOTES

- CONTRACTOR SHALL INSTALL AND MAINTAIN ANY TEMPORARY LIGHT CABLE REQUIRED TO KEEP REMAINDER OF TAXIWAY F EDGE LIGHTING CIRCUIT IN SERVICE (COST INCIDENTAL TO LIGHT REMOVAL).
- THE EXISTING PAVEMENT TO BE REMOVED SHALL BE SAWED FULL DEPTH AROUND PERIMETER OF THE REMOVAL LIMITS. COST OF SAWCUTTING AND DISPOSAL OF PAVEMENT SHALL BE CONSIDERED INCIDENTAL TO THE ITEM.
- THE TAXIWAY LIGHTS AND TRANSFORMER TO BE REMOVED SHALL BE TURNED OVER TO THE AIRPORT. LIGHT CAN CONCRETE BASES SHALL BE DISPOSED OF OFF SITE.
- IN AREAS WHERE UNDERDRAIN, PIPE OR CONDUIT BEING REMOVED IS BELOW LIMITS OF PROPOSED PAVEMENTS, TRENCH SHALL BE BACKFILLED WITH COMPACTED CRUSHED AGGREGATE BACKFILL (208). COST OF BACKFILLING SHALL BE INCIDENTAL TO UNDERDRAIN, PIPE OR CONDUIT REMOVAL.
- IF ANY PROTECTION, BRACING, ETC. IS REQUIRED BY THE RESPECTIVE UTILITY, THE CONTRACTOR SHALL COMPLY WITH UTILITY REQUIREMENTS. THE COST OF ANY SUCH WORK SHALL BE INCIDENTAL TO THE CONTRACT.
- ANY RE-GRADING OR RE-COMPACTING OF EXISTING AGGREGATE BASE REQUIRED PRIOR TO BITUMINOUS PAVEMENT REPLACEMENT SHALL BE INCIDENTAL TO PAVEMENT REMOVAL.
- REMOVAL OF EXISTING AGGREGATE BASE BENEATH BITUMINOUS PAVEMENT TO BE REMOVED SHALL BE CONSIDERED INCIDENTAL TO UNCLASSIFIED EXCAVATION.
- BITUMINOUS MILLINGS SHALL BE PLACED AS SUBGRADE ON NEW RIAT RD.

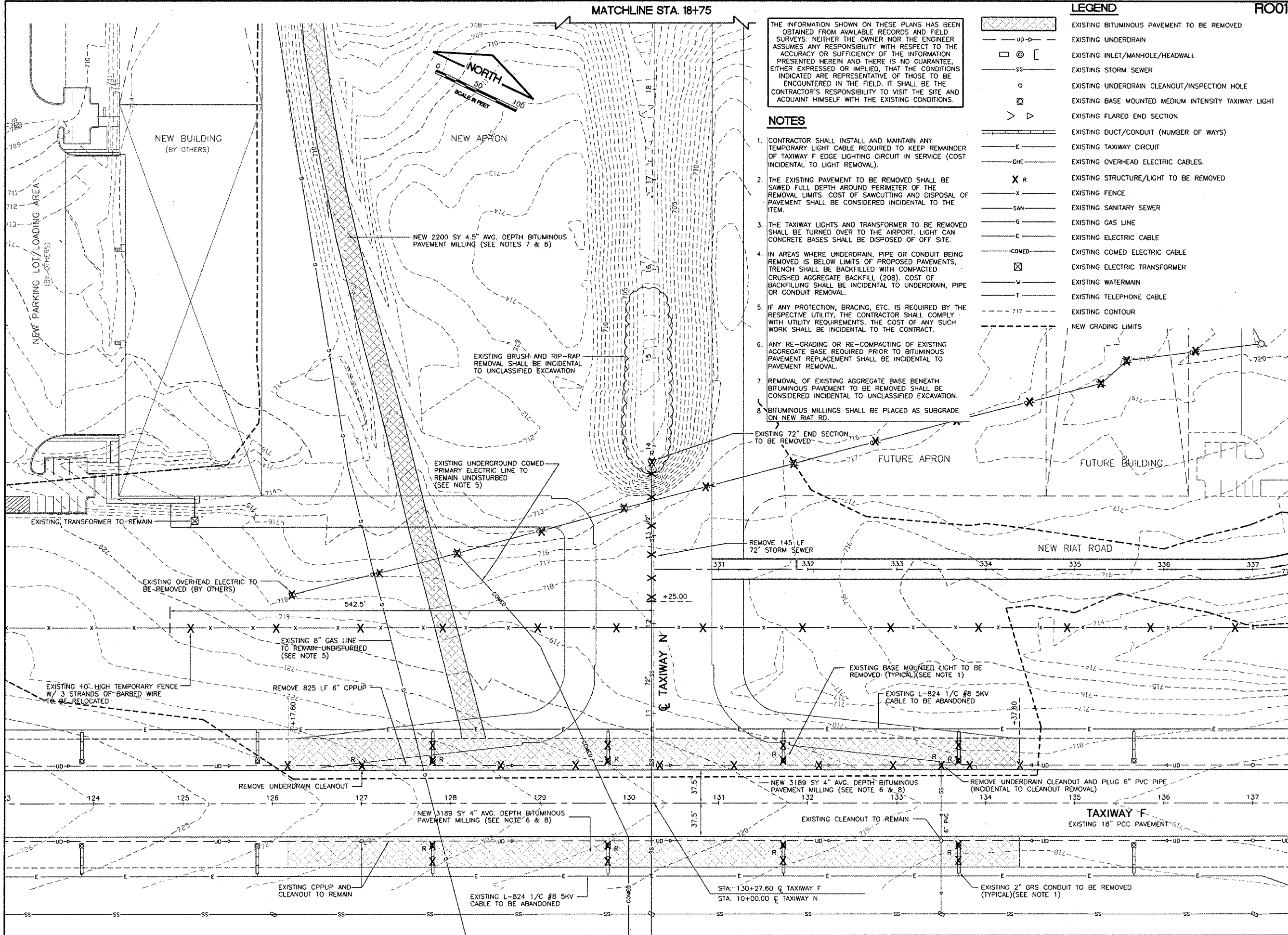

REVISIONS

NUMBER	BY	DATE

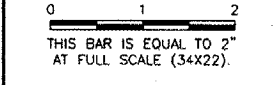

CHICAGO ROCKFORD INTERNATIONAL AIRPORT
 ROCKFORD, ILLINOIS
EXISTING CONDITIONS/PROPOSED REMOVALS
 SHEET 1

CMT
 CRAWFORD, MURPHY & TILLY, INC.
 CONSULTING ENGINEERS
 License No. 164-000513

Chicago Rockford International Airport

DESIGN BY:	CAL
DRAWN BY:	JRO
CHECKED BY:	CAL
APPROVED BY:	
DATE:	02/29/08
JOB No:	07258-06
ILLINOIS PROJECT:	RFD-3787
A.I.P. PROJECT:	3-17-0088-XX
FINAL SUBMITTAL	
SHEET 10 OF 83 SHEETS	