

REVISIONS		
NUMBER	BY	DATE

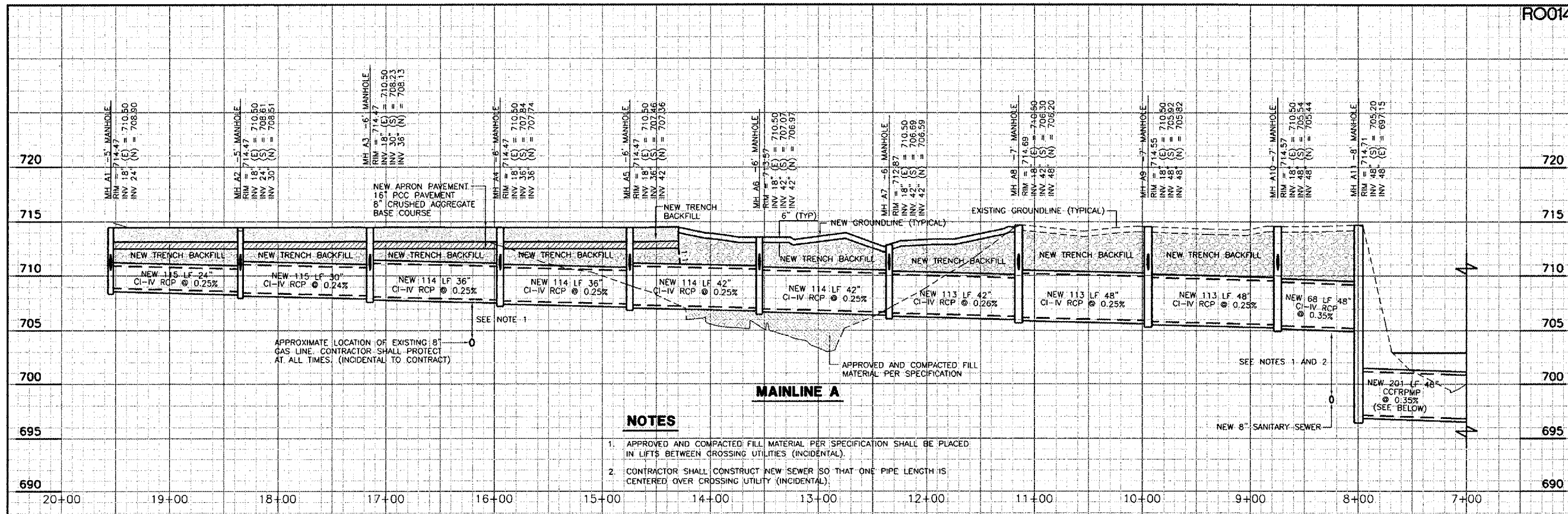

- NOTES**
1. APPROVED AND COMPACTED FILL MATERIAL PER SPECIFICATION SHALL BE PLACED IN LIFTS BETWEEN CROSSING UTILITIES (INCIDENTAL).
 2. CONTRACTOR SHALL CONSTRUCT NEW SEWER SO THAT ONE PIPE LENGTH IS CENTERED OVER CROSSING UTILITY (INCIDENTAL).

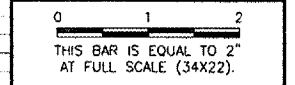
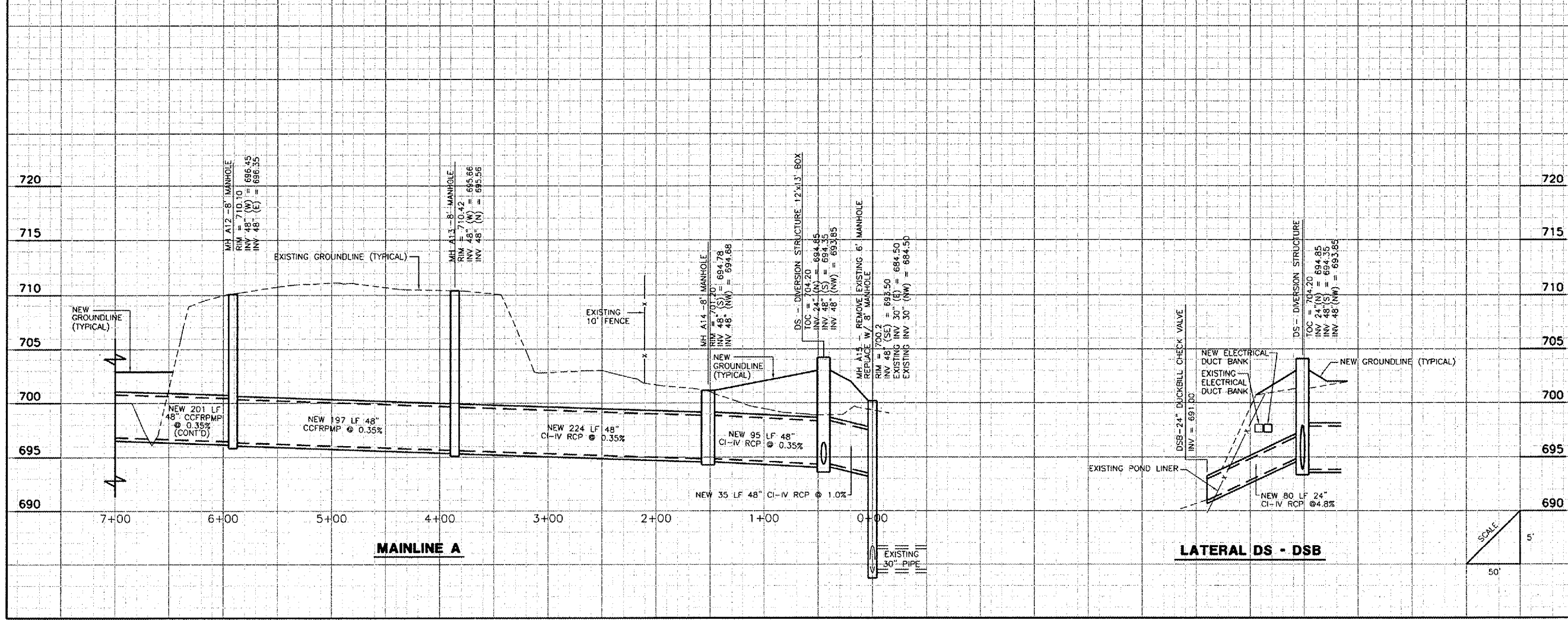

**CHICAGO ROCKFORD INTERNATIONAL AIRPORT
 ROCKFORD, ILLINOIS**

DRAINAGE PROFILES - SHEET 1

Copyright CMT, Inc.

CMT
 CRAWFORD, MURPHY & TILLY, INC.
 CONSULTING ENGINEERS
 License No. 84-006613

Chicago Rockford International Airport

DESIGN BY:	JRL
DRAWN BY:	JRO
CHECKED BY:	JRL
APPROVED BY:	
DATE:	02/29/08
JOB No:	07258-06
ILLINOIS PROJECT:	RFD-3787
A.I.P. PROJECT:	3-17-0088-XX
FINAL SUBMITTAL	
SHEET 23 OF 83 SHEETS	