

RO014
 K:\rockford\072586 NW Air Cargo Dev\Draw\Sheet
 FILE: Nw-pp-san-2.dwg
 LAYOUT: Layout1
 UPDATE BY: Jeremy Linke
 SURVEY BOOK #
 DATE: Thursday, April 03, 2008 11:33:42 AM
 XREF DWG: tbcint.dwg
 nwc-base.dwg
 tbrprgrd.dwg
 etopo.dwg
 topo.DWG
 newfillwest.DWG
 etopo by others.dwg

| REVISIONS | | |
|-----------|----|------|
| NUMBER | BY | DATE |
| | | |
| | | |
| | | |

0 1 2
 THIS BAR IS EQUAL TO 2"
 AT FULL SCALE (34X22).

CHICAGO ROCKFORD INTERNATIONAL AIRPORT
 ROCKFORD, ILLINOIS
 SANITARY PLAN AND PROFILE
 SHEET 2

© Copyright CMT, Inc.
CMT
 CRAMFORD, MURPHY & TILLY, INC.
 CONSULTING ENGINEERS
 License No. 184-000613
 Chicago Rockford International Airport

| | |
|------------------------|--------------|
| DESIGN BY: | CAL |
| DRAWN BY: | JRO |
| CHECKED BY: | CAL |
| APPROVED BY: | |
| DATE: | 02/29/08 |
| JOB No: | 07258-06 |
| ILLINOIS PROJECT: | RFD-3787 |
| A.I.P. PROJECT: | 3-17-0088-XX |
| FINAL SUBMITTAL | |
| SHEET 70 OF 83 SHEETS | |

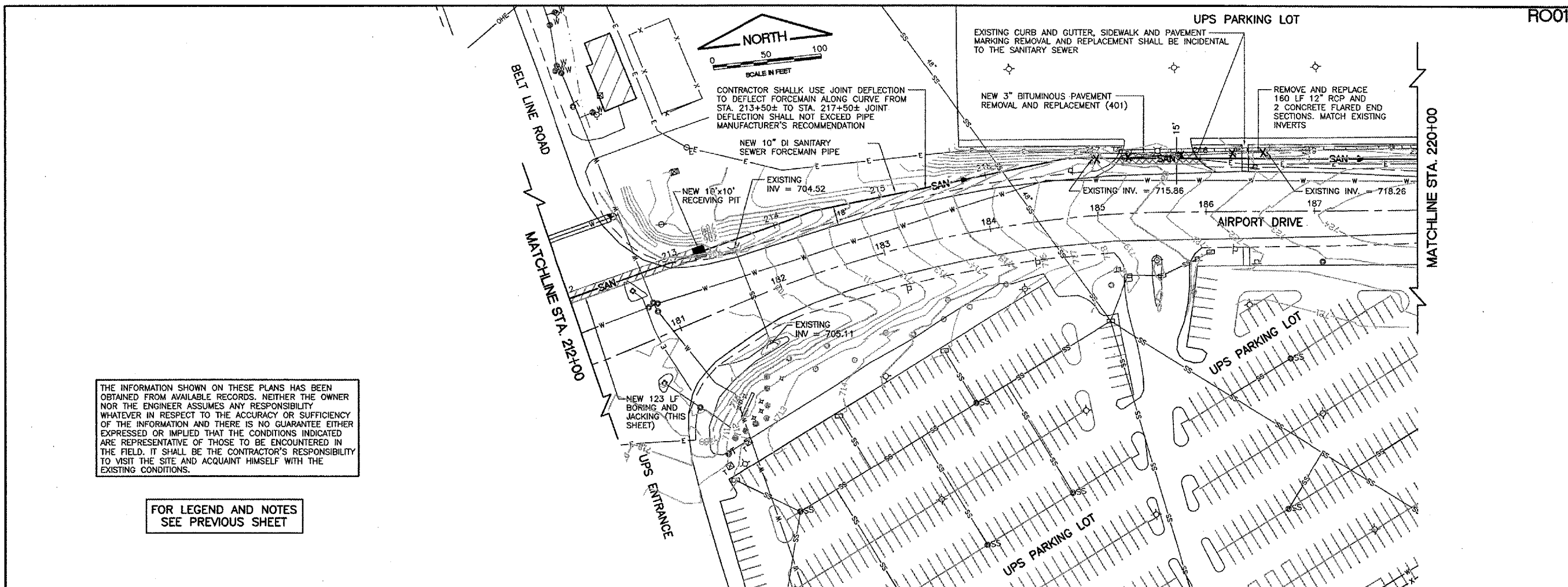

THE INFORMATION SHOWN ON THESE PLANS HAS BEEN OBTAINED FROM AVAILABLE RECORDS. NEITHER THE OWNER NOR THE ENGINEER ASSUMES ANY RESPONSIBILITY WHATSOEVER IN RESPECT TO THE ACCURACY OR SUFFICIENCY OF THE INFORMATION AND THERE IS NO GUARANTEE EITHER EXPRESSED OR IMPLIED THAT THE CONDITIONS INDICATED ARE REPRESENTATIVE OF THOSE TO BE ENCOUNTERED IN THE FIELD. IT SHALL BE THE CONTRACTOR'S RESPONSIBILITY TO VISIT THE SITE AND ACQUAINT HIMSELF WITH THE EXISTING CONDITIONS.

FOR LEGEND AND NOTES
 SEE PREVIOUS SHEET

