

- NOTES:**
1. REFER TO TRAFFIC CONTROL STANDARDS 701006, 701011 & 701501-06 FOR DETAILS.
 2. EXISTING TRAIL SHALL REMAIN OPEN DURING CONSTRUCTION OF PROPOSED IMPROVEMENTS.

WYOMING DEPOT

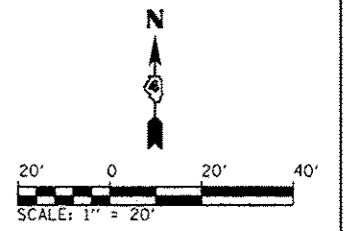

LEGEND

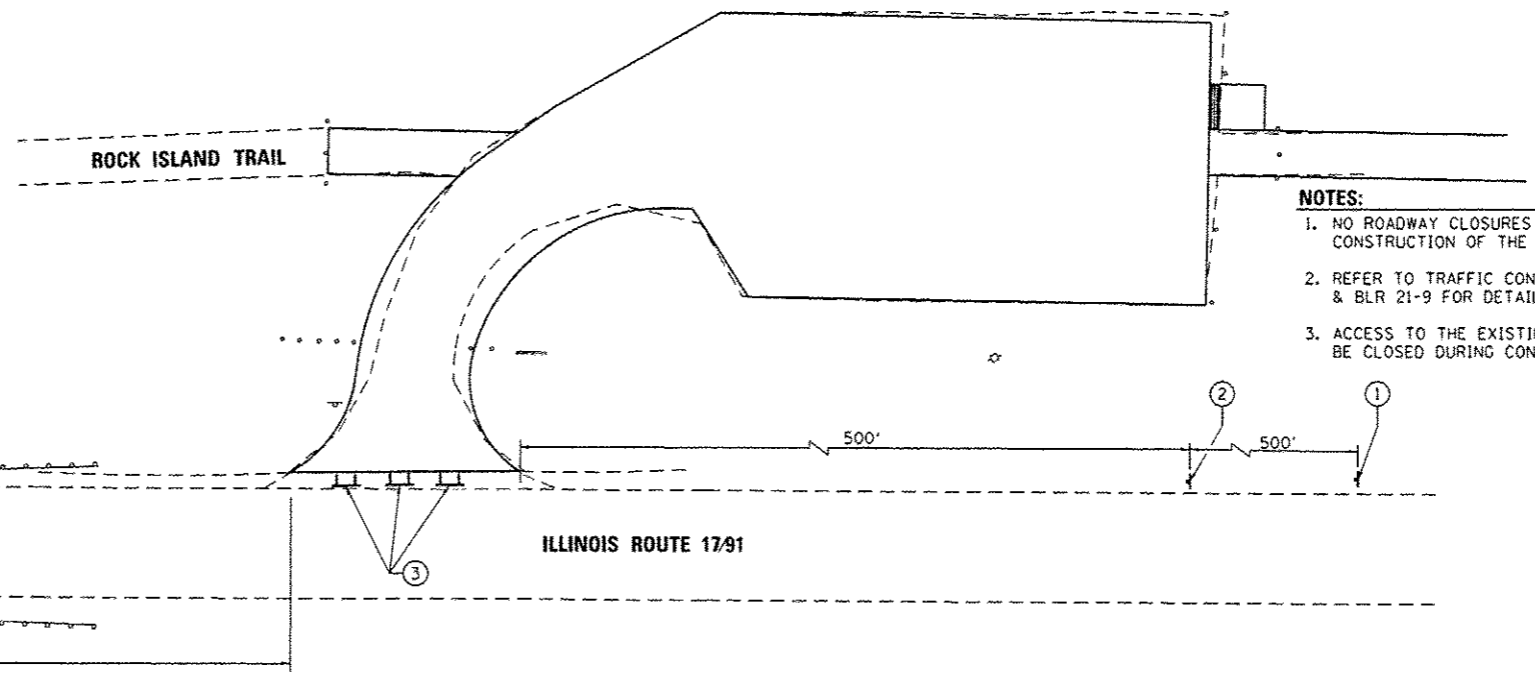
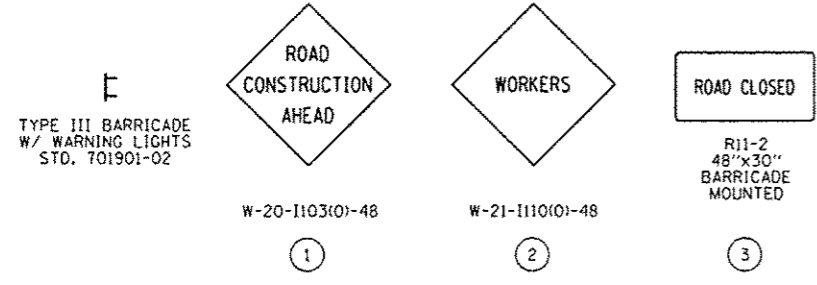

- NOTES:**
1. NO ROADWAY CLOSURES OF ILLINOIS ROUTE 17/91 ARE ALLOWED DURING CONSTRUCTION OF THE PROPOSED IMPROVEMENTS.
 2. REFER TO TRAFFIC CONTROL STANDARDS 701001, 701006-03, 701301-04 & BLR 21-9 FOR DETAILS OF SIGN AND BARRICADE LOCATION.
 3. ACCESS TO THE EXISTING TOULON TRAIL HEAD PARKING AREA SHALL BE CLOSED DURING CONSTRUCTION.

TOULON TRAIL HEAD

FILE NAME = L:\1007\110648\WD.B\Draw\CADD_Sheets\Traffic Control Plan_Toulon\Wyoming.dgn	USER NAME = Kristin Simmons	DESIGNED - KLT	REVISED -	STATE OF ILLINOIS DEPARTMENT OF TRANSPORTATION	TRAFFIC CONTROL PLAN - TOULON TRAIL HEAD / WYOMING DEPOT ROCK ISLAND TRAIL STATE PARK			F.A. RTE.	SECTION	COUNTY	TOTAL SHEETS	SHEET NO.	
Default	PLOT SCALE = 40.0000 1/2 in.	DRAWN - GLD	REVISED -		SCALE: 1" = 20'	SHEET	OF	SHEETS	STA.	TO STA.	PEORIA/STARK	37	32
	PLOT DATE = 2/9/2013	CHECKED - SPH	REVISED -								CONTRACT NO. 46256		
		DATE - 2/11/2013	REVISED -								ILLINOIS FED. AID PROJECT		