

**GENERAL NOTES:**

- UNLESS MODIFIED BY THE PROJECT SPECIFICATIONS, ALL WORK SHALL BE DONE IN ACCORDANCE WITH THE "STANDARD SPECIFICATIONS FOR ROAD AND BRIDGE CONSTRUCTION", ADOPTED BY THE ILLINOIS DEPARTMENT OF TRANSPORTATION ON JAN. 1, 2012; THE LATEST ADDITION OF THE "MANUAL ON UNIFORM TRAFFIC CONTROL DEVICES FOR STREETS AND HIGHWAYS", AND THE "SUPPLEMENTAL SPECIFICATIONS AND RECURRING SPECIAL PROVISIONS" ADOPTED JAN. 1, 2013.
- THE CONTRACTOR SHALL TAKE REASONABLE PRECAUTIONS TO PROTECT PUBLIC AND PRIVATE PROPERTY. IF AT ANY TIME, HE/SHE DAMAGES OR DESTROYS PUBLIC OR PRIVATE PROPERTY, THE CONTRACTOR SHALL, AT HIS OWN EXPENSE, RESTORE SUCH PROPERTY TO A CONDITION EQUAL TO THAT EXISTING BEFORE SUCH DAMAGE. PUBLIC ROADWAYS, PRIVATE ENTRANCES AND EMPLOYEE ENTRANCES SHALL REMAIN ACCESSIBLE AND FREE OF CONSTRUCTION DEBRIS. ANY MATERIAL TO BE STAGED OR STOCKPILED SHALL BE COORDINATED WITH THE OWNER'S REPRESENTATIVE.
- THE CONTRACTOR SHALL BE RESPONSIBLE FOR PROTECTING UTILITY PROPERTY FROM CONSTRUCTION OPERATIONS AS OUTLINED IN ARTICLE 107.31 OF THE STANDARD SPECIFICATIONS. THE CONTRACTOR SHALL CONTACT JULIE AT LEAST 48 HOURS PRIOR TO EXCAVATION TO DETERMINE WHICH UTILITIES ARE IN THE AREA.
- GRADING SHALL BE DONE BY HAND AROUND LIGHT POLES, UTILITY POLES, SIGN POSTS, SHRUBS, TREES OR OTHER NATURAL OR MAN-MADE OBJECTS WHERE SHALLOW FILLS OR CUTS ARE ADJACENT TO THE ITEMS. IT IS THE INTENT THAT THE LIMITS OF CONSTRUCTION BE SUCH AS TO PRESERVE IN THE ORIGINAL STATE AS MUCH AREA AS POSSIBLE. THE DECISION AS TO ITEMS TO REMAIN IN PLACE SHALL BE DIRECTED BY THE ENGINEER. THIS WORK WILL NOT BE PAID FOR SEPARATELY BUT SHALL BE INCLUDED IN THE CONTRACT UNIT PRICE PER CUBIC YARD FOR EARTH EXCAVATION (WIDENING), AND NO ADDITIONAL COMPENSATION WILL BE ALLOWED.
- PLAN DIMENSIONS AND DETAILS RELATIVE TO EXISTING PLANS ARE SUBJECT TO NOMINAL CONSTRUCTION VARIATIONS. THE CONTRACTOR SHALL FIELD VERIFY EXISTING DIMENSIONS AND DETAILS AFFECTING NEW CONSTRUCTION AND MAKE NECESSARY APPROVED ADJUSTMENTS PRIOR TO CONSTRUCTION OR ORDERING OF MATERIALS. SUCH VARIATIONS SHALL NOT BE CAUSE FOR ADDITIONAL COMPENSATION FOR A CHANGE IN SCOPE OF WORK; HOWEVER, THE CONTRACTOR WILL BE PAID FOR THE QUANTITY ACTUALLY FURNISHED AT THE UNIT PRICE BID FOR THE WORK.
- THE FOLLOWING RATES OF APPLICATION HAVE BEEN USED IN CALCULATING PLAN QUANTITIES:
 

|                          |                                |
|--------------------------|--------------------------------|
| GRANULAR MATERIALS       | 2.05 TONS / CU YD (PUGGED)     |
| STONE RIPRAP / ROCK FILL | 1.89 TONS / CU YD (NON-PUGGED) |
|                          | 1.50 TONS / CU YD              |
- THE CONTRACTOR WILL NOT BE ALLOWED TO SET UP A YARD OR FIELD OFFICE ON STATE PROPERTY WITHOUT WRITTEN PERMISSION FROM THE DEPARTMENT.
- THE CONTRACTOR SHALL NOTIFY THE ENGINEER AND ILLINOIS DEPARTMENT OF NATURAL RESOURCES SPRING LAKE SITE SUPERINTENDENT STAN WEIMER, AT PHONE NUMBER 309-968-7315 AT LEAST TWO WEEKS IN ADVANCE OF MOVING EQUIPMENT, MATERIALS, OR WORK FORCES TO THE SITE.
- WHERE PROPOSED CONSTRUCTION ABUTS EXISTING APPURTENCES, A SAW CUT SHALL BE MADE TO ACHIEVE A NEAT CONSTRUCTION JOINT. SAW CUTTING WILL NOT BE PAID FOR SEPARATELY, BUT SHALL BE INCLUDED IN THE UNIT PRICE FOR THE ITEM BEING CONSTRUCTED.
- SEEDING SHALL BE DONE ON ALL AREAS THAT ARE DISTURBED BY CONSTRUCTION OPERATIONS AS DIRECTED BY THE ENGINEER. SEEDING SHALL BE PAID FOR ONLY WITHIN THE PROPOSED CONSTRUCTION LIMITS. ALL AREAS DISTURBED BY THE CONTRACTOR OUTSIDE THE PROPOSED CONSTRUCTION LIMITS SHALL BE SEED, AS DIRECTED BY THE ENGINEER, AT THE CONTRACTOR'S EXPENSE.
- WHERE SECTION OR SUB-SECTION CORNERS OR PROPERTY MARKERS ARE ENCOUNTERED THE ENGINEER SHALL BE NOTIFIED BEFORE SUCH MARKERS ARE REMOVED. THE CONTRACTOR SHALL PROTECT AND PRESERVE ALL PROPERTY MARKERS UNTIL AN AUTHORIZED SURVEYOR HAS WITNESSED OR REFERENCED THEIR LOCATION.
- ANY REFERENCE WITHIN THESE PLANS TO A STANDARD SHALL BE INTERPRETED TO MEAN THE EDITION INDICATED BY THE SUB-NUMBER LISTED ON THIS SHEET OR THE COPY INCLUDED IN THESE PLANS.

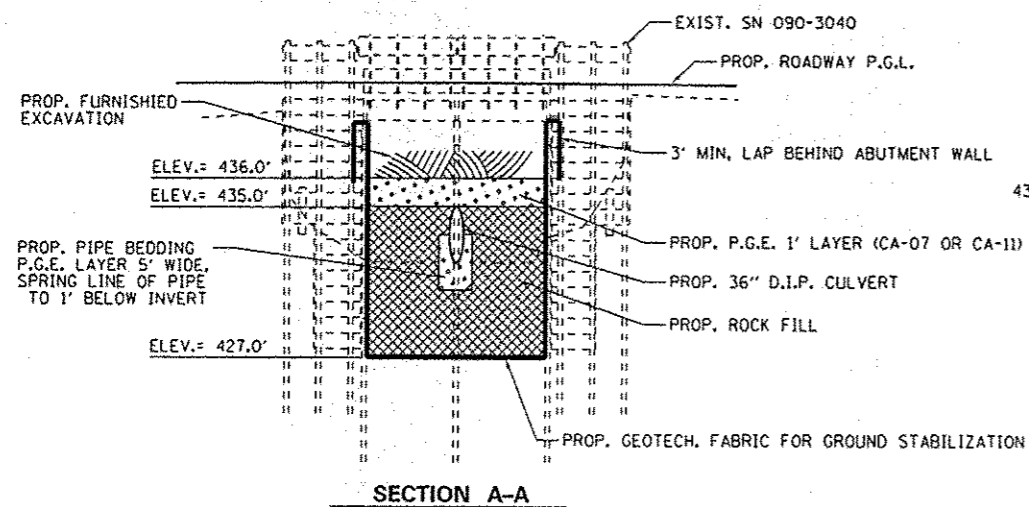
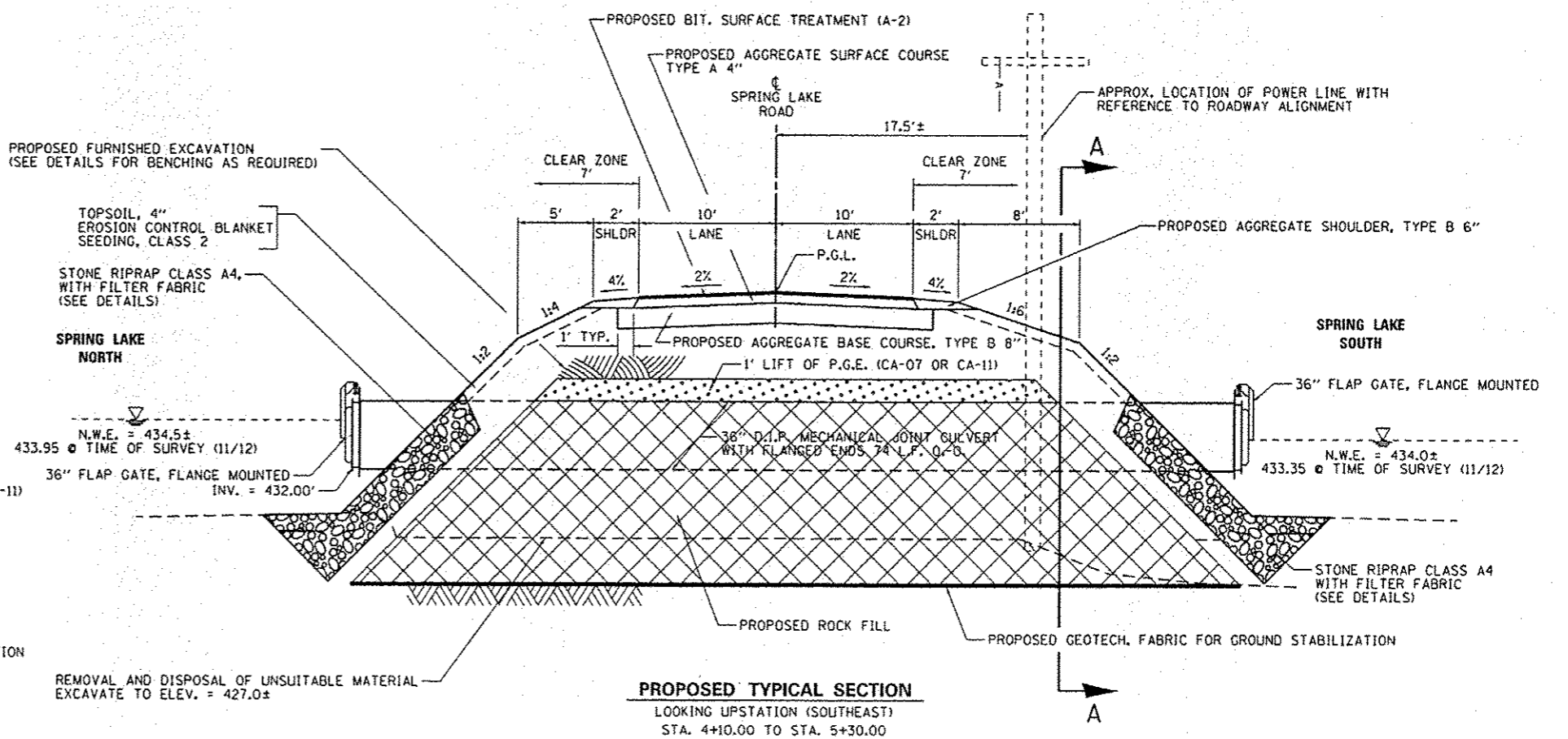
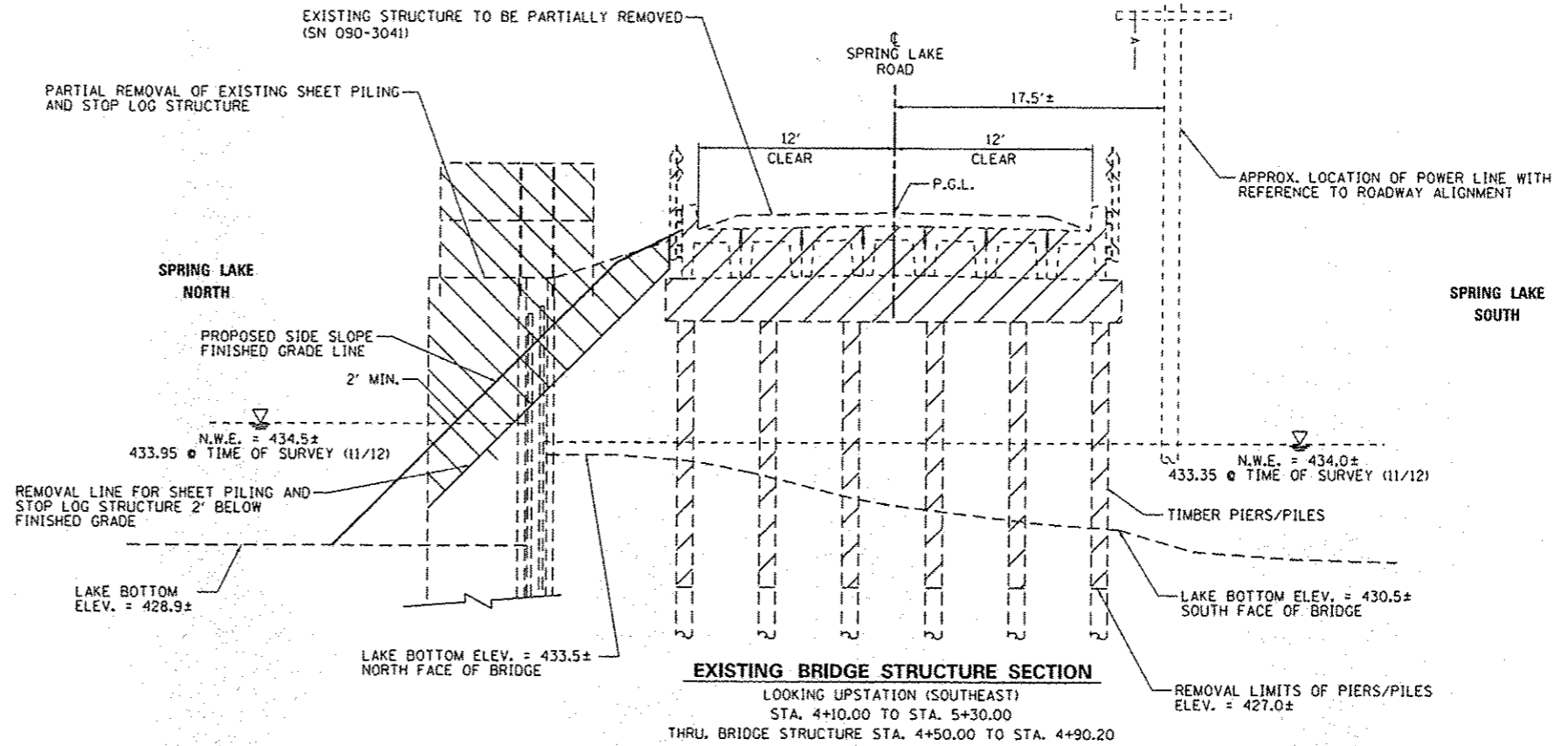

|  |             |               |         |   |  |  |  |           |            |          |              |           |
|--|-------------|---------------|---------|---|--|--|--|-----------|------------|----------|--------------|-----------|
| FILE NAME  | USER NAME   | DESIGNED      | REVISED | STATE OF ILLINOIS DEPARTMENT OF TRANSPORTATION      |  |  |  | F.A. RTE. | SECTION    | COUNTY   | TOTAL SHEETS | SHEET NO. |
| L:\1007\1186610\14\Draw\CADD\Sheets\022-WD-14-CN-TYPICAL.dgn | Jim Michael | CWW           |         | GENERAL NOTES, TYPICAL SECTION & PAVEMENT STRUCTURE |  |  |  | 459       | PARK ROADS | TAZEWELL | 10           | 2         |
|  |             | DRAWN         | REVISED | SPRING LAKE STATE PARK                              |  |  |  |           |            |          |              |           |
|  |             | RAH           |         | SCALE: SHEET NO. OF SHEETS STA. TO STA.             |  |  |  |           |            |          |              |           |
|  |             | CHECKED       | REVISED | CONTRACT NO. 46261                                  |  |  |  |           |            |          |              |           |
|  |             | JMM           |         | ILLINOIS FED. AID PROJECT                           |  |  |  |           |            |          |              |           |
|  |             | DATE          | REVISED |   |  |  |  |           |            |          |              |           |
|  |             | FEBRUARY 2013 |         |   |  |  |  |           |            |          |              |           |