

LEGEND	
	PROPOSED PAVEMENT
	TEMPORARY PAVEMENT PLACED IN THIS STAGE
	TEMPORARY PAVEMENT WEDGE
	DIRECTION OF TRAFFIC
	TYPE II BARRICADES OR DRUMS
	CHANNELIZATION DRUM
	TYPE III BARRICADE LOCATION
	FLASHING YELLOW LIGHT
	VERTICAL PANEL WITH STEADY BURNING LIGHT
	TRAFFIC SIGN

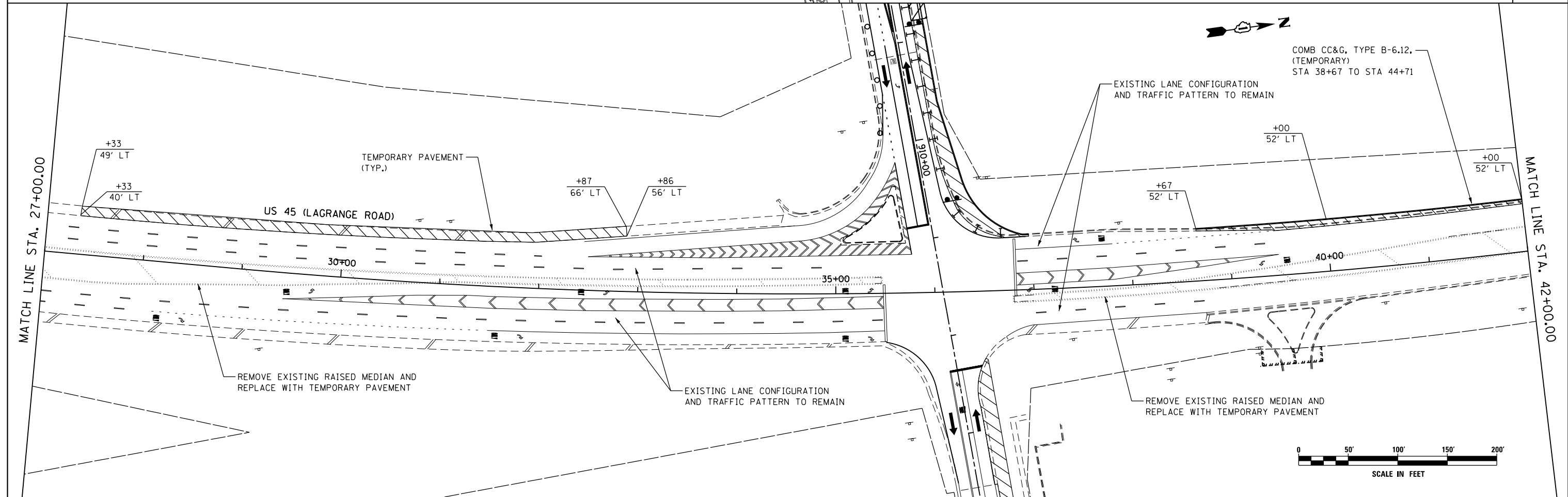
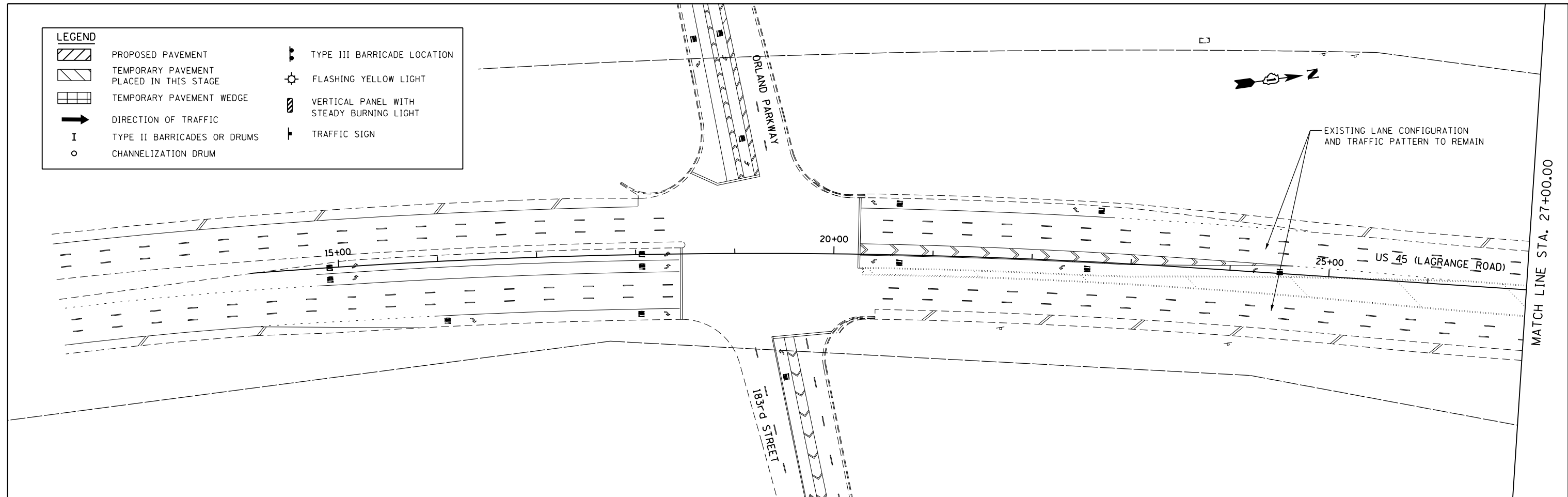

**APEX**  
CONSULTING ENGINEERS, LLC  
111 E. Wacker Drive, Suite 520  
Chicago, IL 60601  
Phone (312) 977-9660 Fax (312) 977-9661

FILE NAME = D:\160F05-KEA-SHT-MOT-PRE STG1.01.dgn	USER NAME = Nicholas.Talarico	DESIGNED - KES	REVISED -
		DRAWN - KCS	REVISED -
		CHECKED - PJO	REVISED -
		DATE - 03/13/13	REVISED -

**STATE OF ILLINOIS  
DEPARTMENT OF TRANSPORTATION**

**MAINTENANCE OF TRAFFIC  
MAINLINE - PRE-STAGE 1**

SCALE: 1"=50' SHEET NO. 1 OF 6 SHEETS STA. BEGIN TO STA. 42+00.00

F.A. RTE. 330	SECTION 103R-3	COUNTY COOK	TOTAL SHEETS 932	SHEET NO. 119
<b>MT-01</b>		CONTRACT NO. 60F05		
ILLINOIS FED. AID PROJECT				