

ADVANCE SIGNING FOR EASTBOUND 167TH STREET  
(SPACING MAY VARY DUE TO FIELD CONDITIONS)

\* INDICATES PAVEMENT MARKING TO REMAIN FROM PREVIOUS STAGE

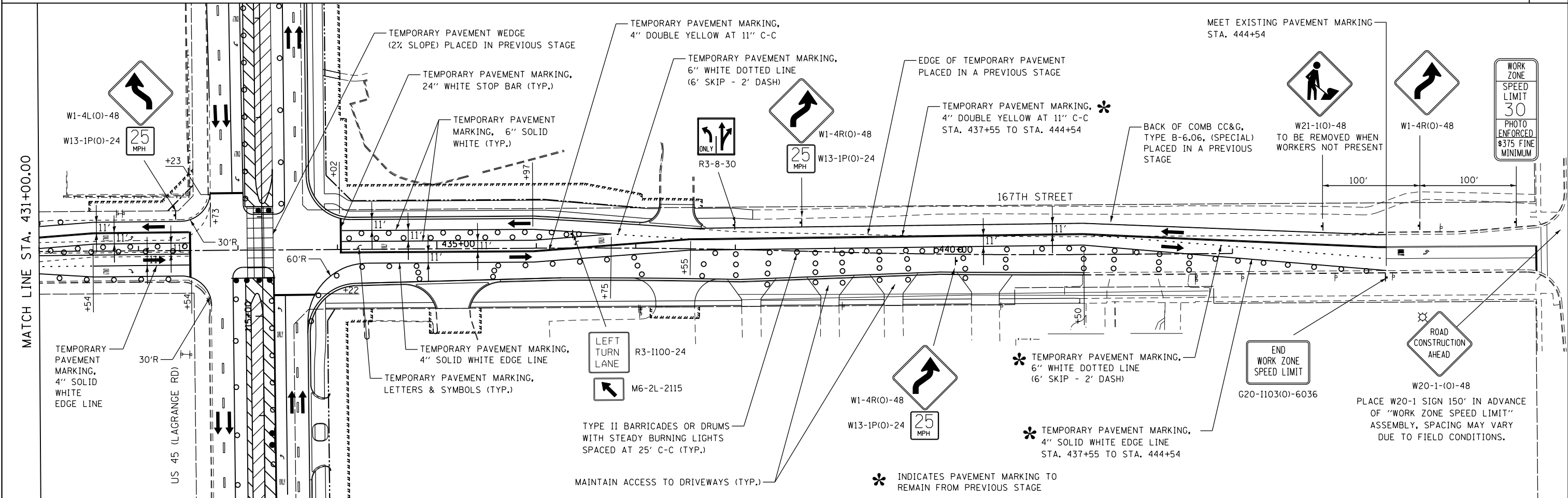

\* INDICATES PAVEMENT MARKING TO REMAIN FROM PREVIOUS STAGE

FILE NAME = D160F05-KEA-SHT-MOT-STG2.203.dgn	USER NAME = Nicholas.Talarico	DESIGNED - KES	REVISED -	STATE OF ILLINOIS DEPARTMENT OF TRANSPORTATION	MAINTENANCE OF TRAFFIC 167TH STREET - STAGE 2	F.A.P. R.T.E. = 330	SECTION = 103R-3	COUNTY = COOK	TOTAL SHEETS = 932	SHEET NO. = 165
	PLOT SCALE = 100.00' / in.	CHECKED - PJO	REVISED -			SCALE: 1"=50'	SHEET NO. 1 OF 1 SHEETS	STA. 423+00 TO STA. 446+00	CONTRACT NO. 60F05	
PLOT DATE = 3/14/2013	DATE = 03/13/13	REVISED -	REVISED -							