

ADVANCE SIGNING FOR EASTBOUND 167TH STREET  
(SPACING MAY VARY DUE TO FIELD CONDITIONS)

\* INDICATES PAVEMENT MARKING TO REMAIN FROM PREVIOUS STAGE

MATCH LINE STA. 431+00.00

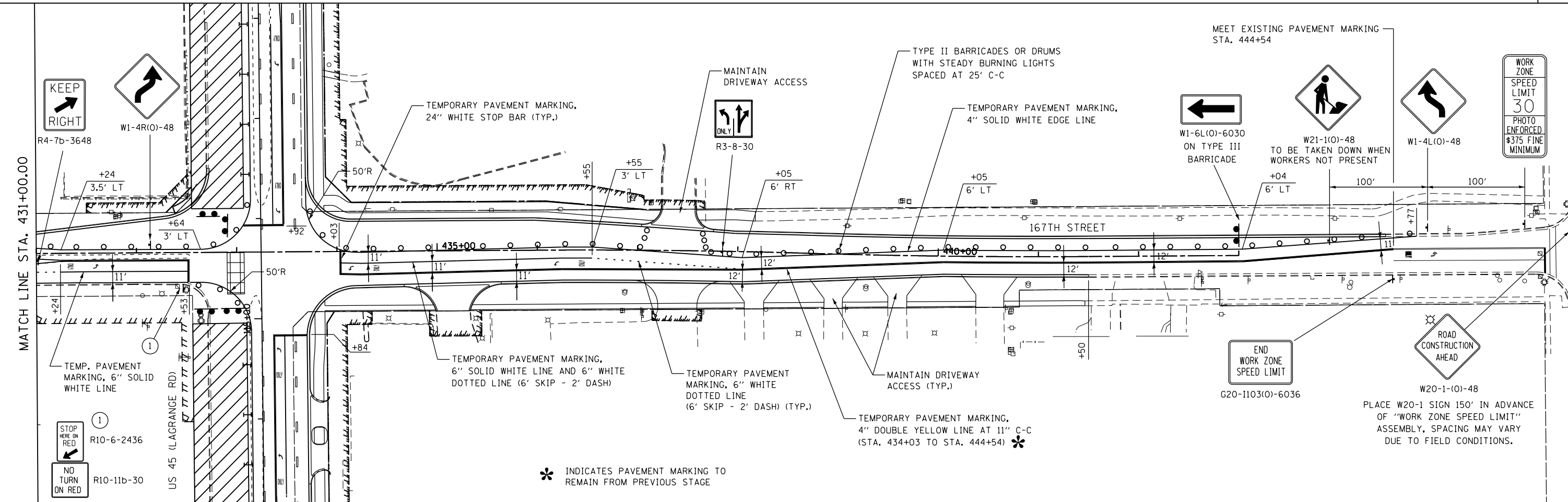

\* INDICATES PAVEMENT MARKING TO REMAIN FROM PREVIOUS STAGE

FILE NAME = D:\60F05-KEA-SHT-MOT-STG3B.203.dgn

USER NAME = Nicholas.Talarico  
DESIGNED - KES  
DRAWN - KCS  
PLOT SCALE = 100.00' / in.  
CHECKED - PJO  
PLOT DATE = 3/14/2013

REVISOR  
REVISED -  
REVISED -  
REVISED -  
REVISED -

DATE - 03/13/13

**STATE OF ILLINOIS  
DEPARTMENT OF TRANSPORTATION**

**MAINTENANCE OF TRAFFIC  
167TH STREET - STAGE 3B**

SCALE: 1"=50' SHEET NO. 1 OF 1 SHEETS STA. 423+00 TO STA. 446+00

F.A.P. R.E.	SECTION	COUNTY	TOTAL SHEETS	SHEET NO.
330	103R-3	COOK	932	182
<b>MT-64</b>		<b>CONTRACT NO. 60F05</b>		
ILLINOIS FED. AID PROJECT				