

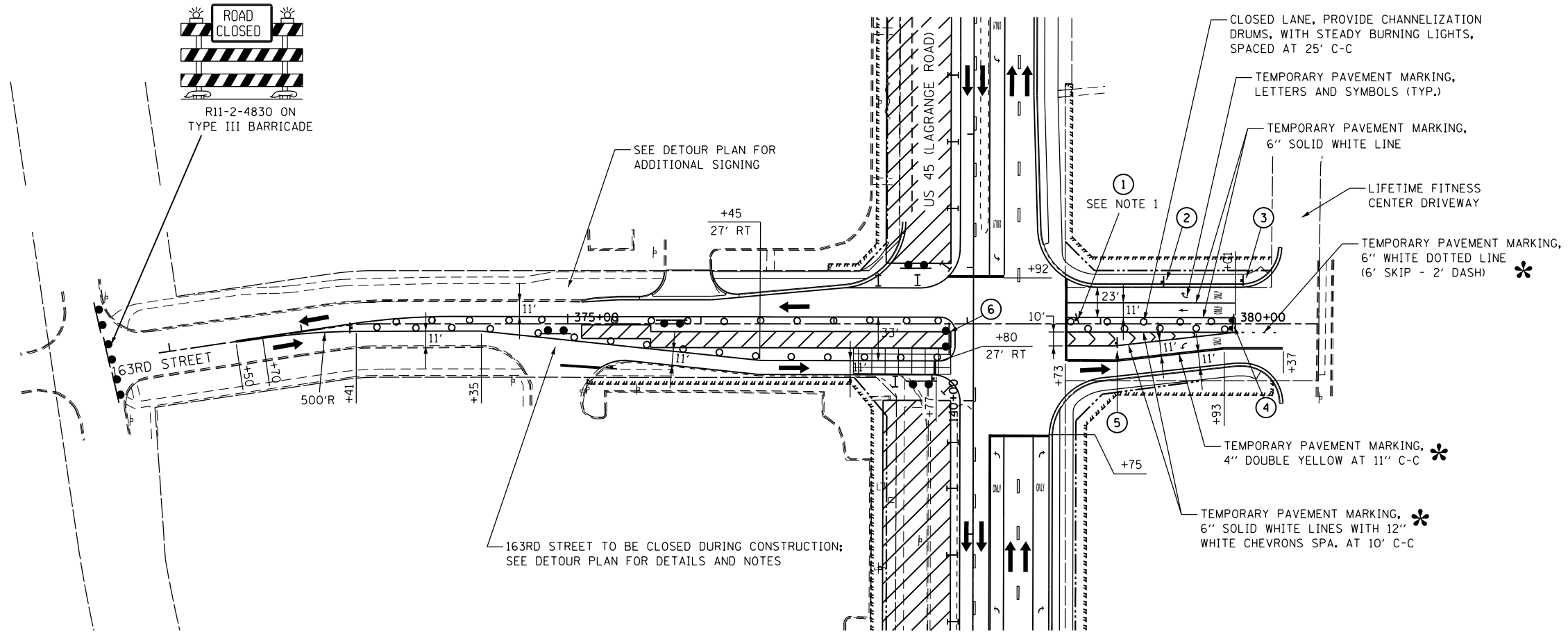







R11-2-4830 ON TYPE III BARRICADE

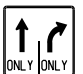

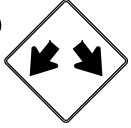
SIGN LEGEND

- ①  R3-2-30
- ②  R3-8-30
- ③  W20-1-(0)-48
- ④  W12-1(0)-48 ON TYPE III BARRICADE
- ⑤  R3-8-2430
- ⑥  R4-7b-3648
- ⑦  R6-2R-2430

NOTES

1. THE R3-2-30 (NO LEFT TURN SIGN) IS INTENDED FOR TRAFFIC IN THE THROUGH ONLY AND RIGHT TURN LANES. THE SIGN SHALL BE ANGLED SLIGHTLY SO THAT IT IS NOT VISIBLE TO THE LEFT TURN LANE TRAFFIC.

* INDICATES PAVEMENT MARKING TO REMAIN FROM PREVIOUS STAGE

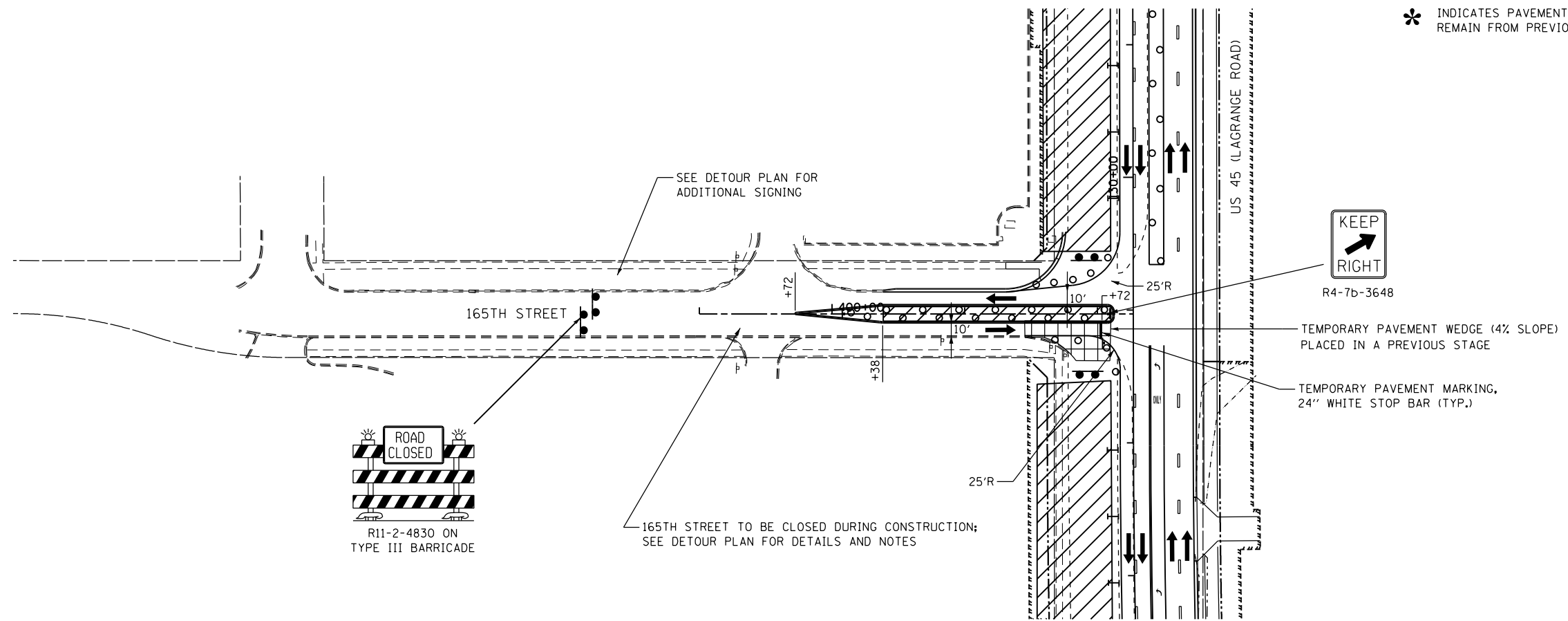

R11-2-4830 ON TYPE III BARRICADE

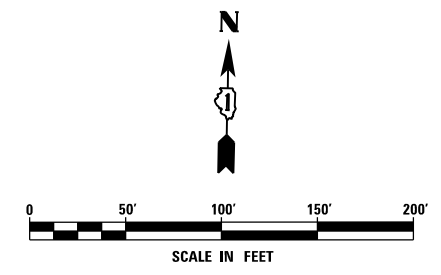

| | | | | | | | | | | | | |
|--|-------------------------------|----------------|-----------|---|--|--------------------|-------------------|----------------|-------------------------|------------------|--------------|--|
| FILE NAME = D160F05-KEA-SHT-MOT-STG3B_204.dgn | USER NAME = Nicholas.Talarico | DESIGNED - KES | REVISED - | STATE OF ILLINOIS DEPARTMENT OF TRANSPORTATION | MAINTENANCE OF TRAFFIC 163RD AND 165TH STREETS - STAGE 3B | F.A.P. RTE. 330 | SECTION 103R-3 | COUNTY COOK | TOTAL SHEETS 932 | SHEET NO. 183 | | |
| PLOT SCALE = 100.00' / in. | | | | | | CHECKED - PJO | MT-65 | | CONTRACT NO. 60F05 | | | |
| PLOT DATE = 3/14/2013 | | | | | | DATE - 03/13/13 | SCALE: 1"=50' | | SHEET NO. 1 OF 1 SHEETS | | STA. TO STA. | |
| ILLINOIS FED. AID PROJECT | | | | | | | | | | | | |