

ADVANCE SIGNING FOR EASTBOUND 179TH STREET
(SPACING MAY VARY DUE TO FIELD CONDITIONS)

* INDICATES PAVEMENT MARKING TO REMAIN FROM PREVIOUS STAGE

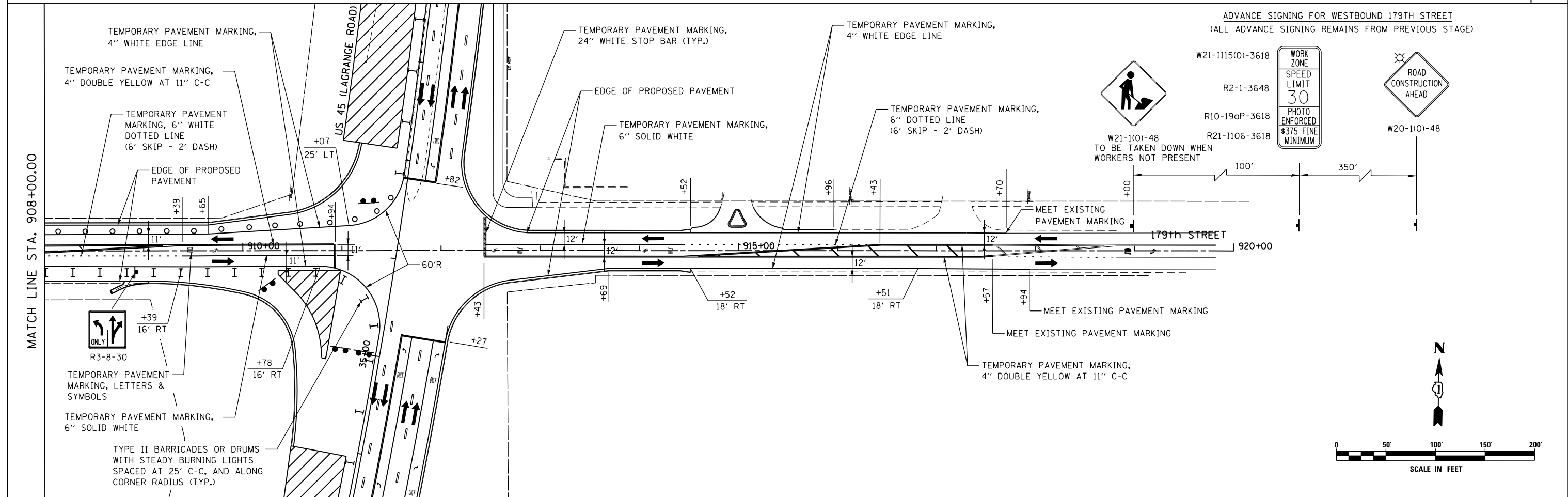

ADVANCE SIGNING FOR WESTBOUND 179TH STREET
(ALL ADVANCE SIGNING REMAINS FROM PREVIOUS STAGE)

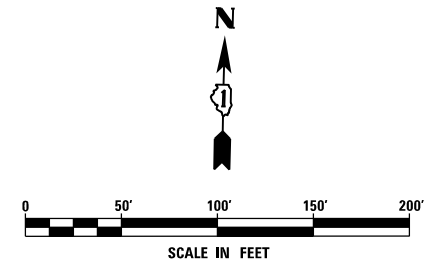

FILE NAME = D160F05-KEA-SHT-MOT-STG3C.201.dgn	USER NAME = Nicholas.Talarico	DESIGNED - KES	REVISED -	STATE OF ILLINOIS DEPARTMENT OF TRANSPORTATION	MAINTENANCE OF TRAFFIC 179TH STREET - STAGE 3C	F.A.P. RTE. = 330	SECTION = 103R-3	COUNTY = COOK	TOTAL SHEETS = 932	SHEET NO. = 184		
	PLOT SCALE = 100.00' / in.	CHECKED - PJO	REVISED -			MT-66		CONTRACT NO. 60F05		ILLINOIS FED. AID PROJECT		
	PLOT DATE = 3/14/2013	DATE = 03/13/13	REVISED -			SCALE: 1"=50'	SHEET NO. 1 OF 1 SHEETS	STA. 897+00	TO STA. 920+00			