

SEE ABOVE
 MATCH LINE STA. 908+00.00

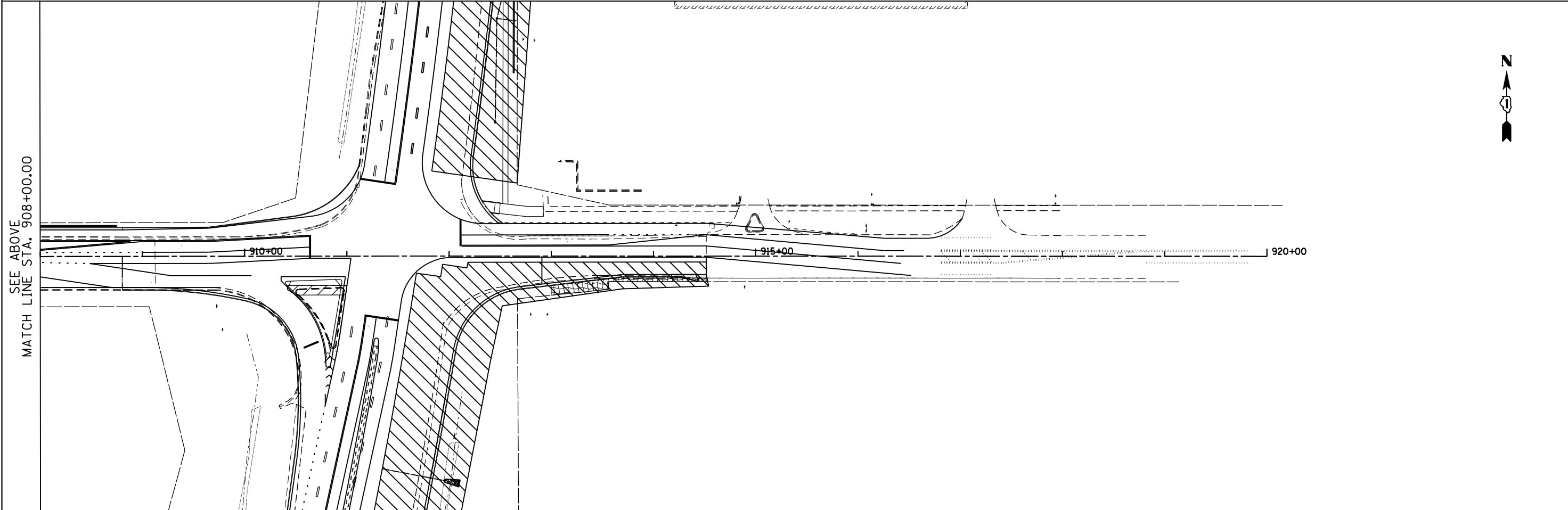

NOTE: SEE SHEET ER-01 FOR LEGEND AND NOTES.

MATCH LINE STA. 908+00.00
 SEE BELOW



FILE NAME = D160F05-SHT-ER0536.dgn	USER NAME = Anthony.Plutz	DESIGNED - L.N.	REVISED -
		DRAWN - M.P.	REVISED -
		CHECKED - W.H.I.	REVISED -
		DATE - 03/13/13	REVISED -

PLOT SCALE = 100.000000' / 1" =	
PLOT DATE = 3/15/2013	

**STATE OF ILLINOIS
 DEPARTMENT OF TRANSPORTATION**

**EROSION AND SEDIMENT CONTROL PLAN - SOUTH CONTRACT
 179TH STREET - STAGE 1**

SCALE: 1"=50' SHEET NO. 1 OF 1 SHEETS STA. 908+00.00 TO STA. 920+00.00

F. # RTE.	SECTION	COUNTY	TOTAL SHEETS	SHEET NO.
330	103R-3	COOK	932	226
ER-36			CONTRACT NO. 60F05	
ILLINOIS FED. AID PROJECT				