

SEE ABOVE
MATCH LINE STA. 908+00.00

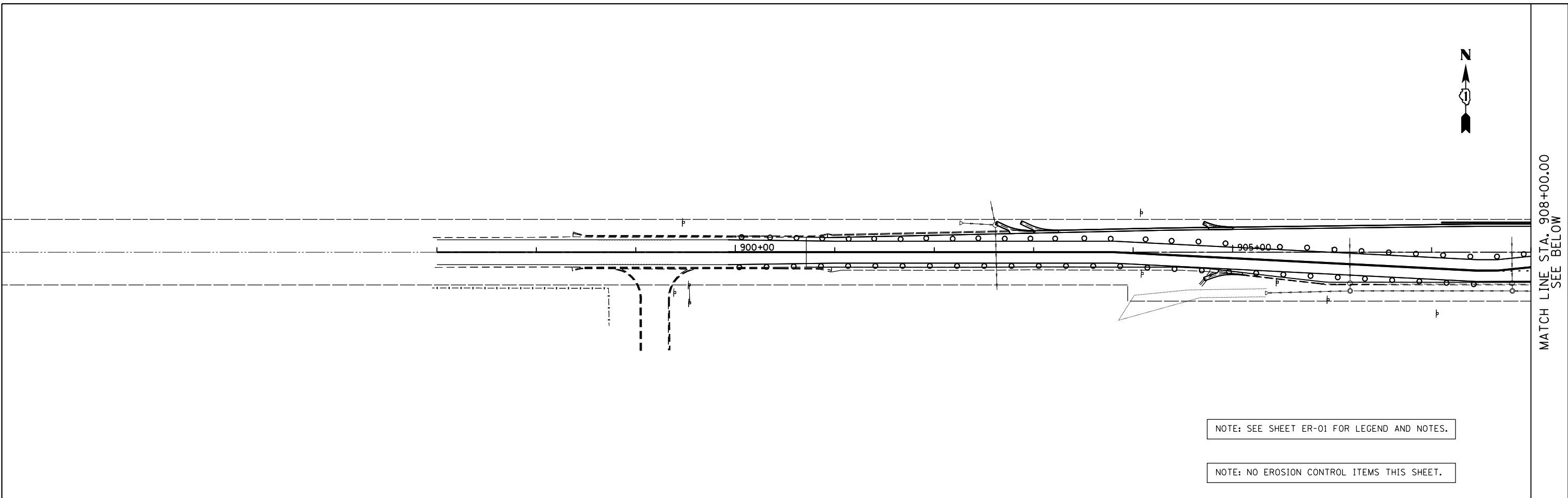
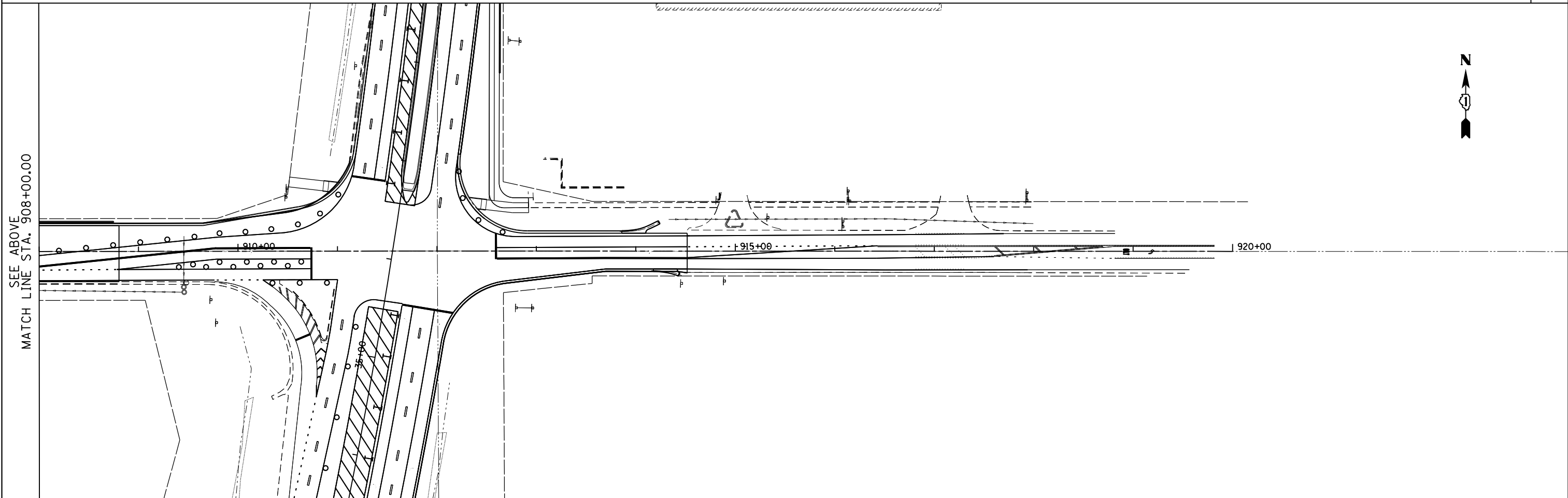

MATCH LINE STA. 908+00.00
SEE BELOW

NOTE: SEE SHEET ER-01 FOR LEGEND AND NOTES.

NOTE: NO EROSION CONTROL ITEMS THIS SHEET.

FILE NAME =
D160F05-SHT-ER0546_179th.st.dgn

USER NAME = Anthony.Plutz
PLOT SCALE = 100.000000' / 1" / in.
PLOT DATE = 3/15/2013

DESIGNED - L.N.
DRAWN - M.P.
CHECKED - W.H.I.
DATE - 03/13/13

REVISED -
REVISED -
REVISED -
REVISED -

**STATE OF ILLINOIS
DEPARTMENT OF TRANSPORTATION**

**EROSION AND SEDIMENT CONTROL PLAN - SOUTH CONTRACT
179TH STREET - STAGE II**

SCALE: 1"=50' SHEET NO. 1 OF 1 SHEETS STA. 897+00.00 TO STA.920+00.00

F.F. # RTE.	SECTION	COUNTY	TOTAL SHEETS	SHEET NO.
330	103R-3	COOK	932	236
ER-46			CONTRACT NO. 60F05	
ILLINOIS FED. AID PROJECT				