

REMOVING CATCH BASINS
 51+56.2, 18.9 LT
 53+63.6, 14.4 RT
 53+63.8, 52.4 LT
 54+08.1, 19.0 LT
 55+78.1, 14.4 RT
 55+78.3, 52.3 LT

REMOVING MANHOLES
 53+48.8, 58.3 LT
 55+64.5, 58.8 LT

FLARED END SECTION REMOVAL
 53+39.3, 76.9 LT

STORM SEWER REMOVAL - 12"
 STA. 51+48.5 TO 51+56.2 - 6'
 STA. 53+48.8 TO 53+63.8 - 12'
 STA. 53+63.8 TO 53+63.6 - 63'
 STA. 53+63.7 TO 54+08.1 - 42'
 STA. 55+64.5 TO 55+78.3 - 11'
 STA. 55+78.3 TO 55+78.1 - 63'

STORM SEWER REMOVAL - 15"
 STA. 53+39.3 TO 53+48.8 - 19'
 STA. 55+64.3 TO 58+94.9 - 325'

STORM SEWER REMOVAL - 21"
 STA. 53+48.8 TO 55+64.5 - 211'

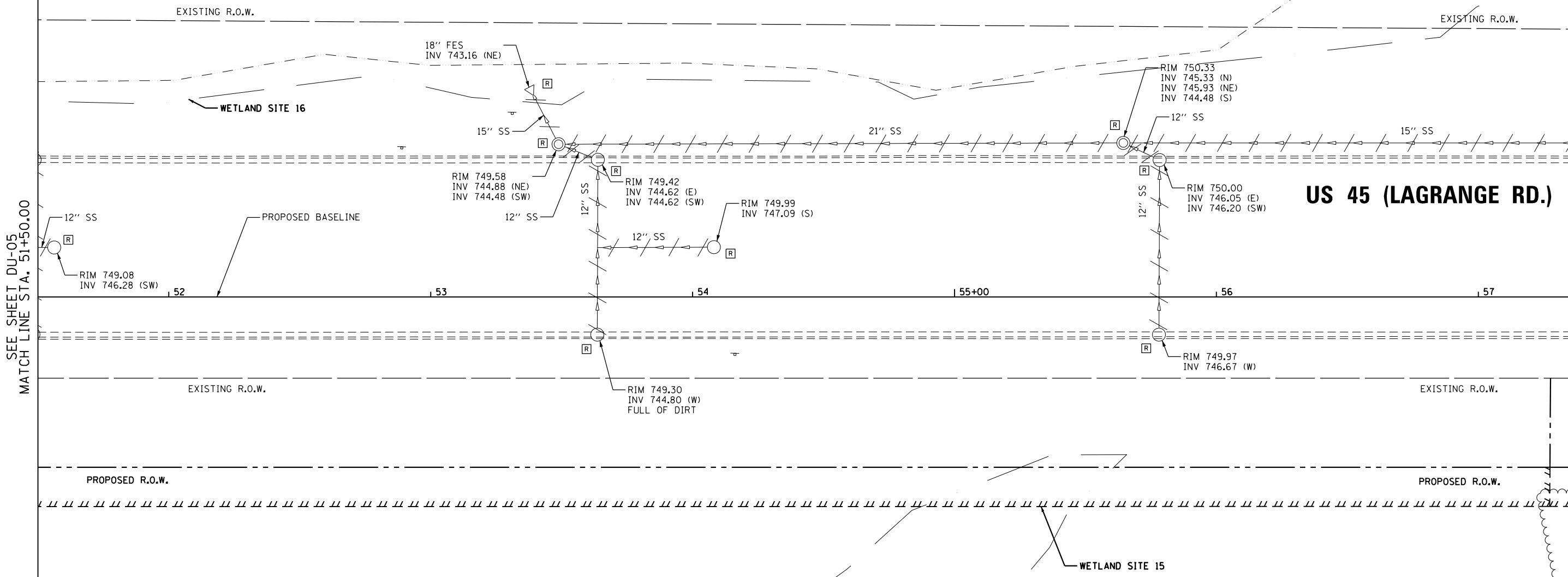

SEE SHEET DU-05
 MATCH LINE STA. 51+50.00

MATCH LINE STA. 57+50.00
 SEE SHEET DU-07

NOTE:
 1. SEE DRAWING DN-01 FOR DRAINAGE LEGEND AND NOTES.
 2. SEE DRAWINGS DS-01 THROUGH DS-11 FOR STRUCTURE AND PIPE INFORMATION

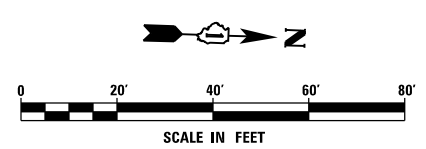

URS
 100 S. WACKER DR.
 SUITE 600
 CHICAGO, IL 60606
 TEL (312) 939-1000
 FAX (312) 939-4998

FILE NAME = D160F05-KEA-SHT-DRAINEX06.dgn	USER NAME = Frank.Stallone	DESIGNED - MGS	REVISED -	STATE OF ILLINOIS DEPARTMENT OF TRANSPORTATION	EXISTING DRAINAGE PLAN - US 45 (LAGRANGE ROAD)	F.A.P. RTE. = 330	SECTION = 103R-3	COUNTY = COOK	TOTAL SHEETS = 932	SHEET NO. = 262
	PLOT SCALE = 40.0001' / in.	CHECKED - JRS	REVISED -			SCALE: 1"=20'	SHEET 6 OF 35 SHEETS	STA. 51+50.00 TO STA. 57+50.00	DU-06 CONTRACT NO. 60F05	
SHT.PLAN	PLOT DATE = 3/14/2013	DATE = 03/13/13	REVISED -							