

REMOVING CATCH BASINS
 69+62.9, 18.9 LT
 69+69.4, 13.1 RT
 69+69.8, 52.3 LT
 72+66.0, 18.8 LT
 72+72.6, 12.9 RT
 72+72.9, 52.2 LT

CONCRETE HEADWALL REMOVAL
 75+11.4, 66.5 LT
 75+12.3, 29.2 RT

STORM SEWER REMOVAL - 12"
 STA. 69+69.4 TO 69+69.8 - 61'
 STA. 69+69.8 TO 69+82.6 - 10'
 STA. 69+62.9 TO 69+69.6 - 5'
 STA. 72+72.6 TO 72+72.9 - 60'
 STA. 72+72.9 TO 72+90.5 - 16'
 STA. 72+66.0 TO 72+72.7 - 5'

STORM SEWER REMOVAL - 15"
 STA. 74+06.0 TO 75+09.7 - 104'

PIPE CULVERT REMOVAL
 STA. 75+09.6 TO 75+10.7 - 96'
 STA. 75+13.2 TO 75+13.9 - 95'

WETLAND SITE 12

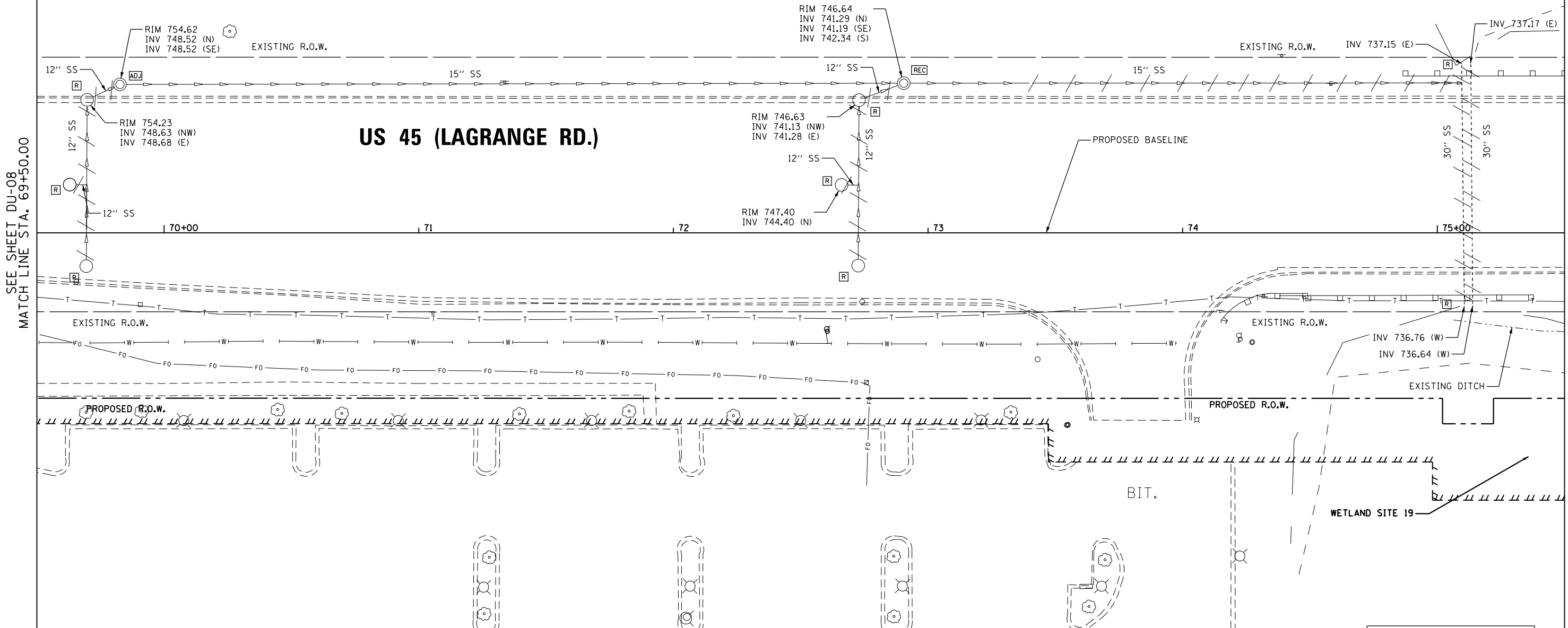

SEE SHEET DU-08
 MATCH LINE STA. 69+50.00

MATCH LINE STA. 75+50.00
 SEE SHEET DU-10

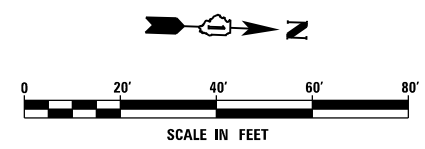

NOTE:
 1. SEE DRAWING DN-01 FOR DRAINAGE LEGEND AND NOTES.
 2. SEE DRAWINGS DS-01 THROUGH DS-11 FOR STRUCTURE AND PIPE INFORMATION

URS
 100 S. WACKER DR.
 SUITE 600
 CHICAGO, IL 60606
 TEL (312) 935-1000
 FAX (312) 935-4998

FILE NAME = D160F05-KEA-SHT-DRAINEX09.dgn	USER NAME = Frank.Stallone	DESIGNED - MGS	REVISED -	STATE OF ILLINOIS DEPARTMENT OF TRANSPORTATION	EXISTING DRAINAGE PLAN - US 45 (LAGRANGE ROAD)			F.A.P. RTE. 330	SECTION 103R-3	COUNTY COOK	TOTAL SHEETS 932	SHEET NO. 265
SHT.PLAN	PLOT SCALE = 40.0001' / in.	CHECKED - JRS	REVISED -		SCALE: 1"=20'	SHEET 9 OF 35 SHEETS	STA. 69+50.00 TO STA. 75+50.00	DU-09		CONTRACT NO. 60F05		
	PLOT DATE = 3/14/2013	DATE - 03/13/13	REVISED -		ILLINOIS FED. AID PROJECT							