

REMOVING CATCH BASINS  
 76+73.1, 52.1 LT  
 76+73.2, 14.6 RT  
 78+71.9, 14.4 RT  
 78+75.1, 52.2 LT  
 80+66.2, 19.1 LT  
 80+73.0, 14.7 RT  
 80+74.9, 52.0 LT

STORM SEWER REMOVAL - 12"  
 STA. 76+73.2 TO 76+73.1 - 63'  
 STA. 76+73.1 TO 76+84.6 - 9'  
 STA. 78+71.9 TO 78+75.1 - 63'  
 STA. 78+75.1 TO 78+81.2 - 4'  
 STA. 80+73.0 TO 80+74.9 - 63'  
 STA. 80+74.9 TO 80+79.3 - 6'  
 STA. 80+66.2 TO 80+74.0 - 6'

PIPE CULVERT REMOVAL  
 STA. 79+51.2 TO 79+52.3 - 15'  
 STA. 79+53.0 TO 79+54.2 - 15'

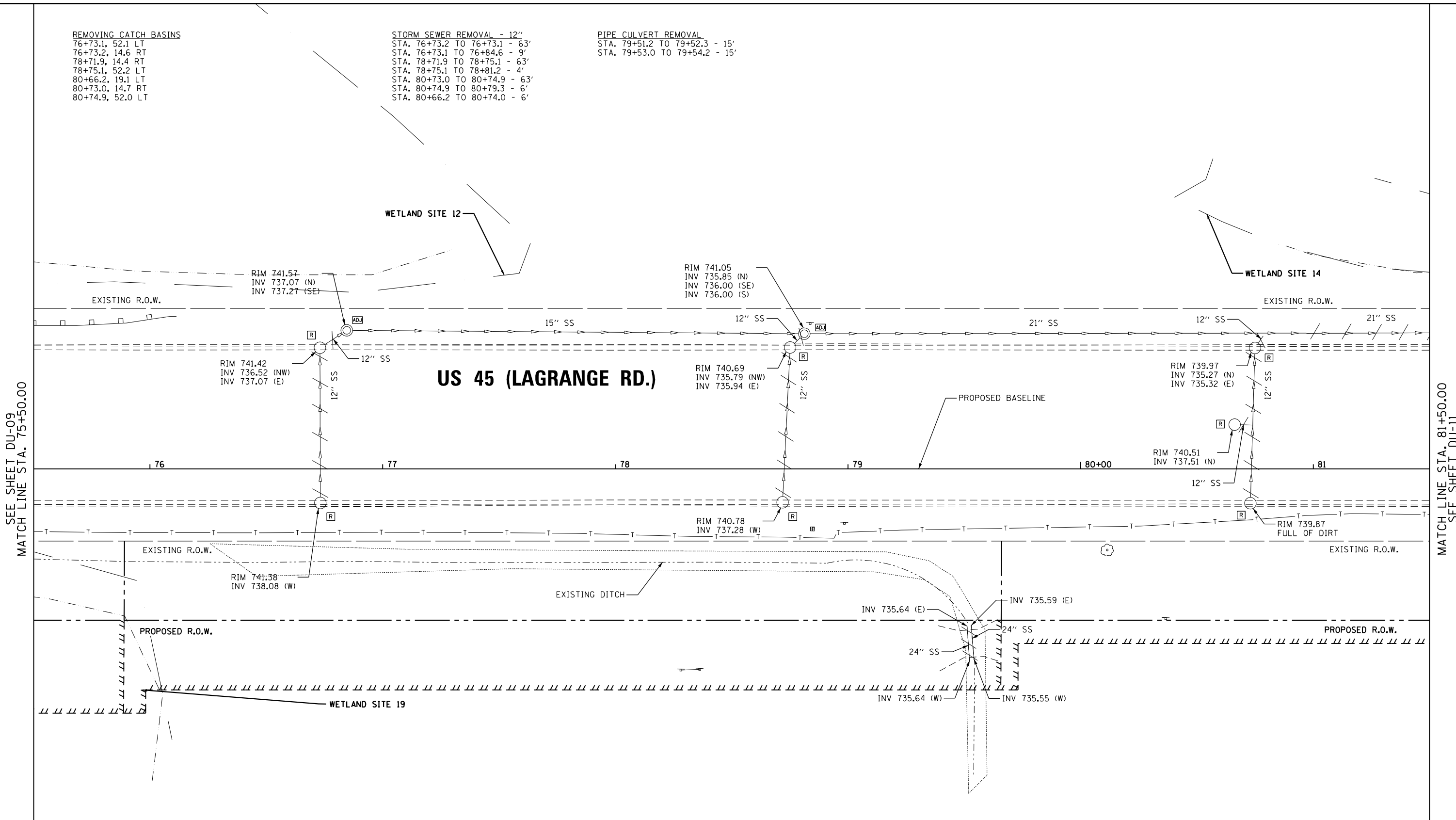

SEE SHEET DU-09  
 MATCH LINE STA. 75+50.00

MATCH LINE STA. 81+50.00  
 SEE SHEET DU-11

**US 55 (LAGRANGE RD.)**

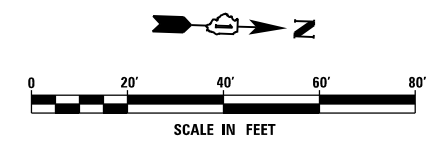

NOTE:  
 1. SEE DRAWING DN-01 FOR DRAINAGE LEGEND AND NOTES.  
 2. SEE DRAWINGS DS-01 THROUGH DS-11 FOR STRUCTURE AND PIPE INFORMATION

**URS**  
 100 S. WACKER DR.  
 SUITE 600  
 CHICAGO, IL 60606  
 TEL (312) 939-1000  
 FAX (312) 939-4998

FILE NAME = D160F05-KEA-SHT-DRAINEX10.dgn	USER NAME = Frank.Stallone	DESIGNED - MGS	REVISED -
		DRAWN - REW	REVISED -
		CHECKED - JRS	REVISED -
SHT.PLAN	PLOT DATE = 3/14/2013	DATE - 03/13/13	REVISED -

**STATE OF ILLINOIS  
 DEPARTMENT OF TRANSPORTATION**

**EXISTING DRAINAGE PLAN - US 55 (LAGRANGE ROAD)**

SCALE: 1"=20' SHEET 10 OF 35 SHEETS STA. 75+50.00 TO STA. 81+50.00

F.A.P. RTE. 330	SECTION 103R-3	COUNTY COOK	TOTAL SHEETS 932	SHEET NO. 266
<b>DU-10</b>			<b>CONTRACT NO. 60F05</b>	
ILLINOIS FED. AID PROJECT				