

REMOVING CATCH BASINS  
 82+73.2, 14.6 RT  
 82+75.3, 52.1 LT  
 82+82.8, 21.4 RT  
 84+65.7, 19.0 LT  
 84+74.6, 52.1, LT  
 84+75.3, 26.6 RT  
 85+97.5, 51.1 RT  
 86+32.5, 52.1 RT  
 86+71.6, 30.0 RT  
 86+72.0, 14.6 RT  
 86+74.0, 52.0 LT

FLARED END SECTION REMOVAL  
 84+47.0, 48.6 RT  
 84+62.1, 72.0 RT

CONCRETE HEADWALL REMOVAL  
 81+87.2, 28.4 RT  
 81+89.1, 67.5 LT

REMOVING MANHOLES  
 85+78.9, 21.2 RT

STORM SEWER REMOVAL - 12"  
 STA. 82+75.3 TO 82+73.2 - 63'  
 STA. 82+73.2 TO 82+82.8 - 8'  
 STA. 84+75.3 TO 84+74.6 - 75'  
 STA. 84+65.7 TO 84+74.9 - 7'  
 STA. 85+97.5 TO 86+32.5 - 31'  
 STA. 86+32.5 TO 86+71.6 - 41'  
 STA. 86+71.6 TO 86+72.2 - 7'  
 STA. 86+74.0 TO 86+72.0 - 63'  
 STA. 86+72.0 TO 86+76.0 - 6'

STORM SEWER REMOVAL - 15"  
 STA. 82+82.8 TO 84+75.3 - 189'  
 STA. 84+75.3 TO 85+78.9 - 99'  
 STA. 85+78.9 TO 88+82.6 - 299'

STORM SEWER REMOVAL - 24"  
 STA. 84+47.0 TO 84+46.1 - 28'  
 STA. 84+62.1 TO 84+62.3 - 3'

STORM SEWER REMOVAL - 21"  
 STA. 81+34.1 TO 81+88.9 - 55'

PIPE CULVERT REMOVAL  
 STA. 81+87.2 TO 81+89.1 - 96'

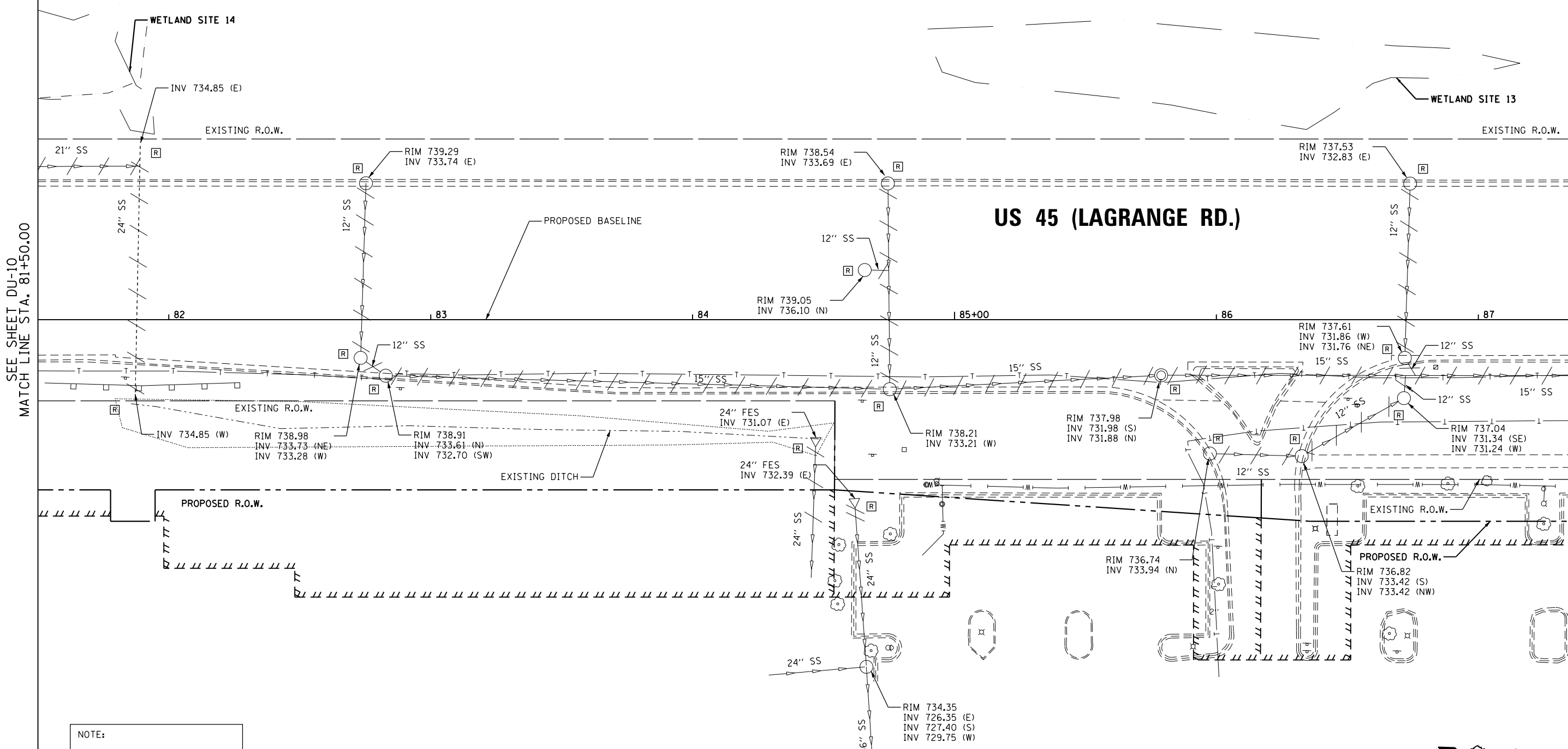

SEE SHEET DU-10  
 MATCH LINE STA. 81+50.00

MATCH LINE STA. 87+50.00  
 SEE SHEET DU-12

**US 45 (LAGRANGE RD.)**

NOTE:  
 1. SEE DRAWING DN-01 FOR DRAINAGE LEGEND AND NOTES.  
 2. SEE DRAWINGS DS-01 THROUGH DS-11 FOR STRUCTURE AND PIPE INFORMATION

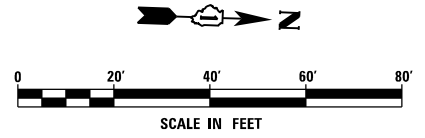

100 S. WACKER DR.  
 SUITE 600  
 CHICAGO, IL 60606  
 TEL (312) 939-1000  
 FAX (312) 939-4998



FILE NAME = D:\60F05-KEA-SHT-DRAINEX11.dgn  
 SHT.PLAN

USER NAME = Frank.Stallone  
 PLOT SCALE = 40.0001' / in.  
 PLOT DATE = 3/14/2013

DESIGNED - MGS  
 DRAWN - REW  
 CHECKED - JRS  
 DATE - 03/13/13

REVISED -  
 REVISED -  
 REVISED -  
 REVISED -

**STATE OF ILLINOIS  
 DEPARTMENT OF TRANSPORTATION**

**EXISTING DRAINAGE PLAN - US 45 (LAGRANGE ROAD)**

SCALE: 1"=20' SHEET 11 OF 35 SHEETS STA. 81+50.00 TO STA. 87+50.00

F.A.P. RTE.	SECTION	COUNTY	TOTAL SHEETS	SHEET NO.
330	103R-3	COOK	932	267
<b>DU-11</b>		CONTRACT NO. 60F05		
ILLINOIS FED. AID PROJECT				