

REMOVING CATCH BASINS
 101+26.9, 19.2 LT
 101+31.5, 52.4 LT
 101+34.0, 14.1 RT
 103+53.1, 14.2 RT
 103+53.4, 52.4 LT
 104+94.9, 52.3 LT
 104+97.1, 14.1 RT
 105+04.9, 52.4 LT
 105+06.5, 19.2 LT
 105+07.1, 14.3 RT

REMOVING MANHOLES
 101+41.6, 22.1 RT

CONCRETE HEADWALL REMOVAL
 105+16.4, 27.1 RT
 105+17.6, 65.5 LT

STORM SEWER REMOVAL - 12"
 STA. 101+26.9 TO 101+32.8 - 4'
 STA. 101+31.5 TO 101+34.0 - 64'
 STA. 101+34.0 TO 101+34.8 - 6'
 STA. 103+53.4 TO 103+53.1 - 63'
 STA. 103+53.1 TO 103+53.3 - 6'
 STA. 104+94.9 TO 104+97.1 - 62'
 STA. 104+94.9 TO 105+04.9 - 6'
 STA. 104+96.0 TO 105+06.5 - 8'
 STA. 104+97.1 TO 105+07.1 - 6'
 STA. 104+97.1 TO 104+97.2 - 6'

STORM SEWER REMOVAL - 24"
 STA. 98+44.8 TO 101+41.6 - 292'

STORM SEWER REMOVAL - 27"
 STA. 101+41.6 TO 105+16.5 - 372'

PIPE CULVERT REMOVAL
 STA. 105+16.4 TO 105+17.6 - 93'
 STA. 105+16.4 TO 105+17.6 - 93'

NOTE: INSTREAM WORK TO BE SUBMITTED BY CONTRACTOR

SEE SHEET DU-13
 MATCH LINE STA. 99+50.00

MATCH LINE STA. 105+50.00
 SEE SHEET DU-15

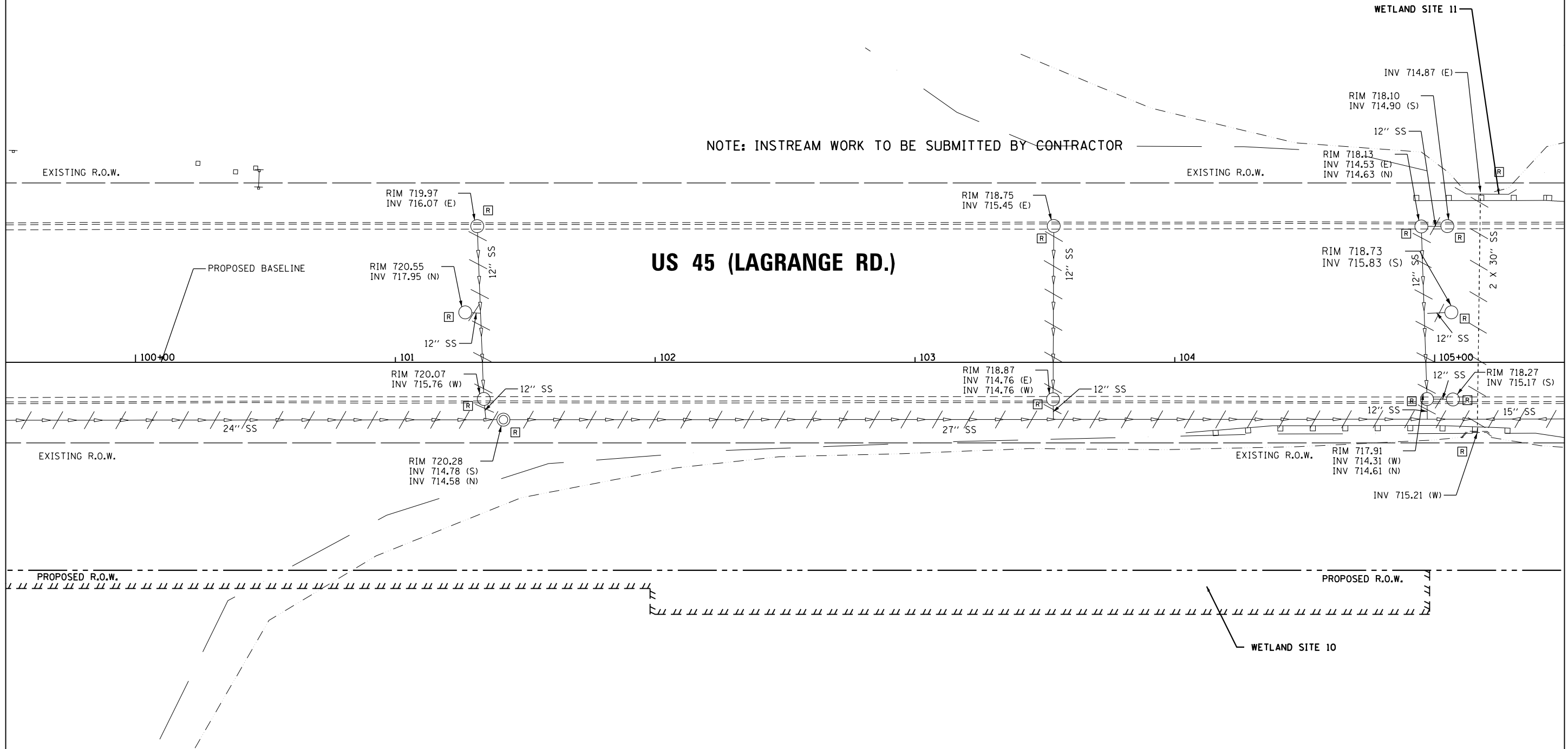

NOTE:
 1. SEE DRAWING DN-01 FOR DRAINAGE LEGEND AND NOTES.
 2. SEE DRAWINGS DS-01 THROUGH DS-11 FOR STRUCTURE AND PIPE INFORMATION

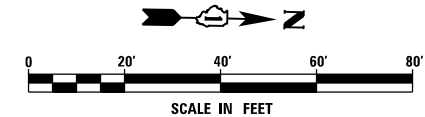

100 S. WACKER DR.
 SUITE 600
 CHICAGO, IL 60606
 TEL (312) 939-1000
 FAX (312) 939-4998



FILE NAME = D160F05-KEA-SHT-DRAINEX14.dgn	USER NAME = Frank.Stallone	DESIGNED - MGS	REVISED -
		DRAWN - REW	REVISED -
		CHECKED - JRS	REVISED -
SHT.PLAN	PLOT DATE = 3/14/2013	DATE - 03/13/13	REVISED -

STATE OF ILLINOIS
 DEPARTMENT OF TRANSPORTATION

EXISTING DRAINAGE PLAN - US 55 (LAGRANGE ROAD)

SCALE: 1"=20' SHEET 14 OF 35 SHEETS STA. 99+50.00 TO STA. 105+50.00

F.A.P. RTE.	SECTION	COUNTY	TOTAL SHEETS	SHEET NO.
330	103R-3	COOK	932	270
DU-14			CONTRACT NO. 60F05	
ILLINOIS FED. AID PROJECT				