

REMOVING INLETS
 129+67.6, 33.8 RT
 129+69.5, 33.1 LT
 133+33.1, 33.0 LT
 133+33.4, 33.4 RT
 135+32.1, 32.9 LT
 135+35.3, 33.6 RT

REMOVING MANHOLES
 129+56.9, 39.1 RT
 133+08.3, 39.7 RT
 135+21.6, 40.0 RT

REMOVING CATCH BASINS
 131+29.9, 42.7 LT

STORM SEWER REMOVAL - 12"
 STA. 129+56.5 TO 129+67.6 - 8'
 STA. 129+67.6 TO 129+69.5 - 65'
 STA. 129+69.5 TO 131+29.9 - 158'
 STA. 133+08.3 TO 133+33.4 - 32'
 STA. 133+33.4 TO 133+33.1 - 64'
 STA. 135+21.6 TO 135+35.3 - 12'
 STA. 135+35.3 TO 135+32.1 - 65'

STORM SEWER REMOVAL - 15"
 STA. 129+56.9 TO 133+08.3 - 347'
 STA. 133+08.3 TO 135+21.6 - 208'

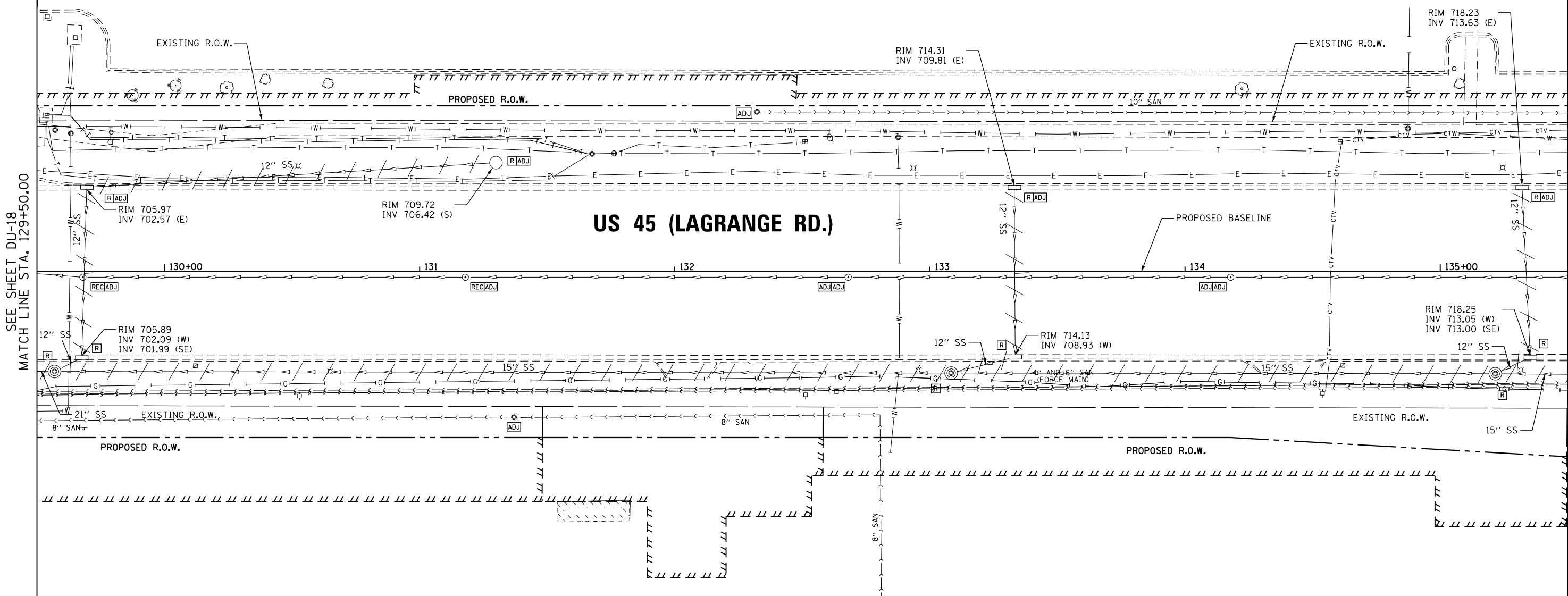

SEE SHEET DU-18
 MATCH LINE STA. 129+50.00

MATCH LINE STA. 135+50.00
 SEE SHEET DU-20

US 45 (LAGRANGE RD.)

NOTE:
 1. SEE DRAWING DN-01 FOR DRAINAGE LEGEND AND NOTES.
 2. SEE DRAWINGS DS-01 THROUGH DS-11 FOR STRUCTURE AND PIPE INFORMATION

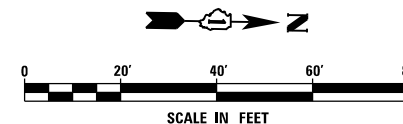

100 S. WACKER DR.
 SUITE 600
 CHICAGO, IL 60606
 TEL (312) 939-1000
 FAX (312) 939-4998

URS

FILE NAME = D160F05-KEA-SHT-DRAINEX19.dgn	USER NAME = Frank.Stallone	DESIGNED - MGS	REVISED -
		DRAWN - REW	REVISED -
		CHECKED - JRS	REVISED -
SHT.PLAN	PLOT DATE = 3/14/2013	DATE - 03/13/13	REVISED -

**STATE OF ILLINOIS
 DEPARTMENT OF TRANSPORTATION**

EXISTING DRAINAGE PLAN - US 45 (LAGRANGE ROAD)

SCALE: 1"=20' SHEET 19 OF 35 SHEETS STA. 129+50.00 TO STA. 135+50.00

F.A.P. RTE. 330	SECTION 103R-3	COUNTY COOK	TOTAL SHEETS 932	SHEET NO. 275
DU-19			CONTRACT NO. 60F05	
ILLINOIS FED. AID PROJECT				