

REMOVING INLETS
 147+52.5, 33.3 LT
 147+52.8, 33.3 RT
 150+23.5, 33.5 RT
 150+23.7, 32.9 LT
 152+02.3, 32.8 LT
 152+05.2, 33.6 RT

REMOVING CATCH BASINS
 151+19.6, 2.3 LT
 151+79.6, 0.3 RT

REMOVING MANHOLES
 147+63.5, 41.4 RT
 152+12.4, 39.0 LT

FLARED END SECTION REMOVAL
 149+85.4, 61.6 RT

CONCRETE HEADWALL REMOVAL
 149+85.2, 47.1 RT
 CONCRETE HEADWALL REMOVAL
 TO BE INCLUDED IN COST OF
 PIPE REMOVAL

STORM SEWER REMOVAL - 12"
 STA. 147+52.5 TO 147+52.8 - 65'
 STA. 147+52.8 TO 147+63.5 - 10'
 STA. 149+85.4 TO 149+86.8 - 21'
 STA. 149+93.3 TO 150+23.7 - 30'
 STA. 150+23.7 TO 150+23.5 - 64'
 STA. 151+19.6 TO 151+79.6 - 58'
 STA. 151+79.6 TO 152+03.9 - 24'
 STA. 152+05.2 TO 152+02.3 - 65'
 STA. 152+02.3 TO 152+12.4 - 8'

STORM SEWER REMOVAL - 15"
 STA. 147+63.5 TO 149+81.6 - 215'

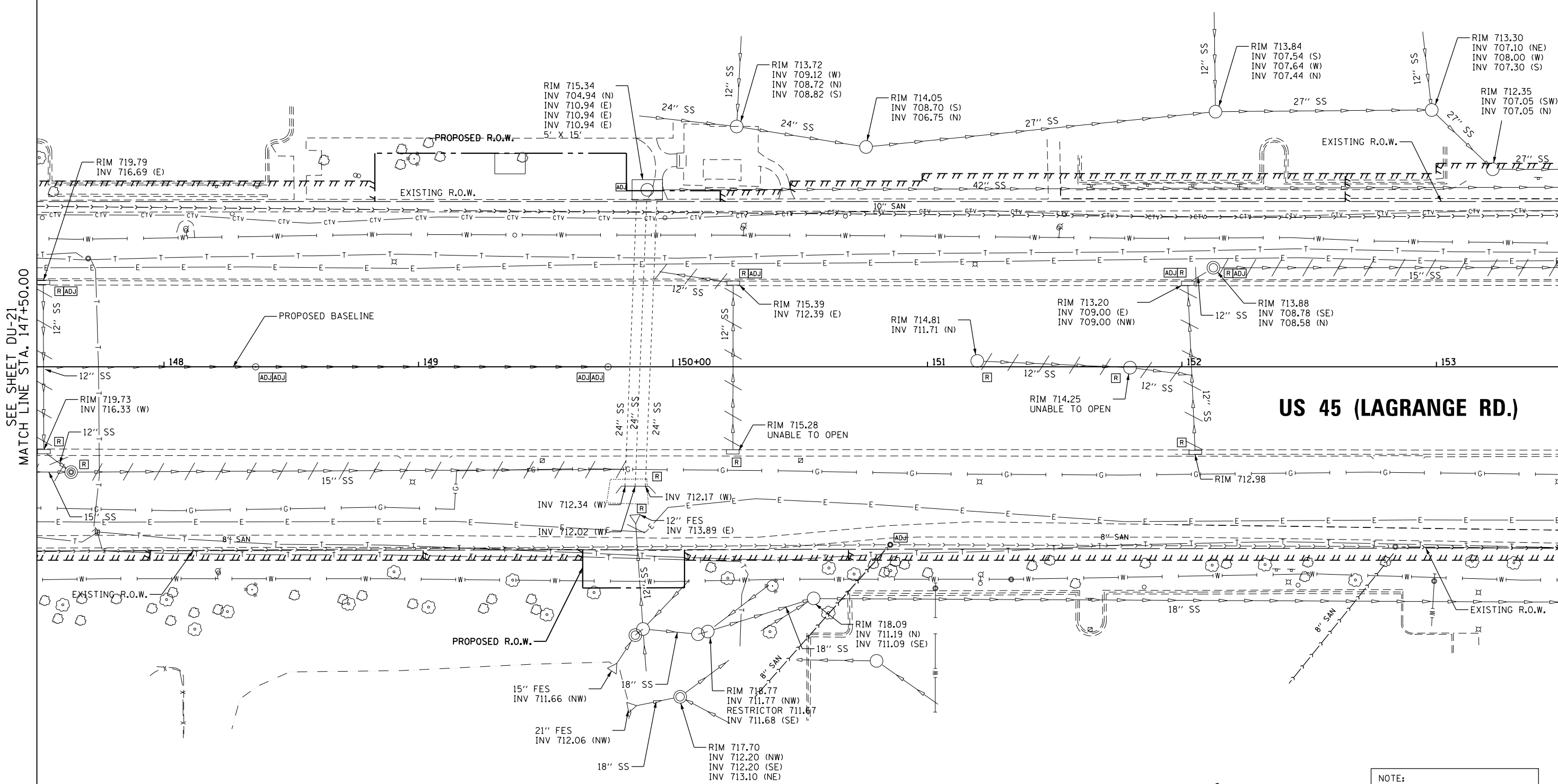

SEE SHEET DU-21
 MATCH LINE STA. 147+50.00

MATCH LINE STA. 153+50.00
 SEE SHEET DU-23

US 55 (LAGRANGE RD.)

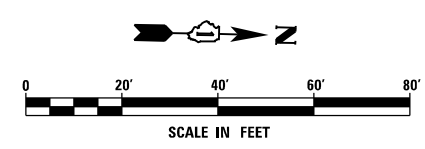

NOTE:
 1. SEE DRAWING DN-01 FOR DRAINAGE LEGEND AND NOTES.
 2. SEE DRAWINGS DS-01 THROUGH DS-11 FOR STRUCTURE AND PIPE INFORMATION

URS
 100 S. WACKER DR.
 SUITE 600
 CHICAGO, IL 60606
 TEL (312) 939-1000
 FAX (312) 939-4998

FILE NAME = D160F05-KEA-SHT-DRAINEX22.dgn	USER NAME = Frank.Stallone	DESIGNED - MGS	REVISED -	STATE OF ILLINOIS DEPARTMENT OF TRANSPORTATION	EXISTING DRAINAGE PLAN - US 55 (LAGRANGE ROAD)			F.A.P. RTE. 330	SECTION 103R-3	COUNTY COOK	TOTAL SHEETS 932	SHEET NO. 278
PLOT SCALE = 40.0001' / in.	CHECKED - JRS	DRAWN - REW	REVISED -		SCALE: 1"=20'	SHEET 22 OF 35 SHEETS	STA. 147+50.00 TO STA. 153+50.00	DU-22		CONTRACT NO. 60F05		
PLOT DATE = 3/14/2013	DATE - 03/13/13	REVISOR -	REVISED -		ILLINOIS FED. AID PROJECT							
SHT. PLAN												