

REMOVING INLETS
 160+80.0, 37.4 RT
 160+96.6, 41.7 LT
 162+45.4, 47.0 RT
 162+56.9, 46.3 LT

FLARED END SECTION REMOVAL
 160+06.0, 46.0 LT
 160+09.5, 46.0 LT

REMOVING MANHOLES
 160+09.6, 48.0 RT

STORM SEWER REMOVAL - 12"
 STA. 160+80.2 TO 160+86.5 - 37'
 STA. 160+87.6 TO 160+96.4 - 37'
 STA. 160+97.3 TO 161+07.5 - 17'
 STA. 162+45.5 TO 162+46.4 - 7'
 STA. 162+55.8 TO 162+56.8 - 8'
 STA. 162+55.3 TO 162+56.7 - 7'

STORM SEWER REMOVAL - 24"
 STA. 160+16.0 TO 160+46.3 - 20'

PIPE CULVERT REMOVAL
 STA. 160+06.0 TO 160+09.6 - 89'
 STA. 160+09.5 TO 160+16.0 - 99'

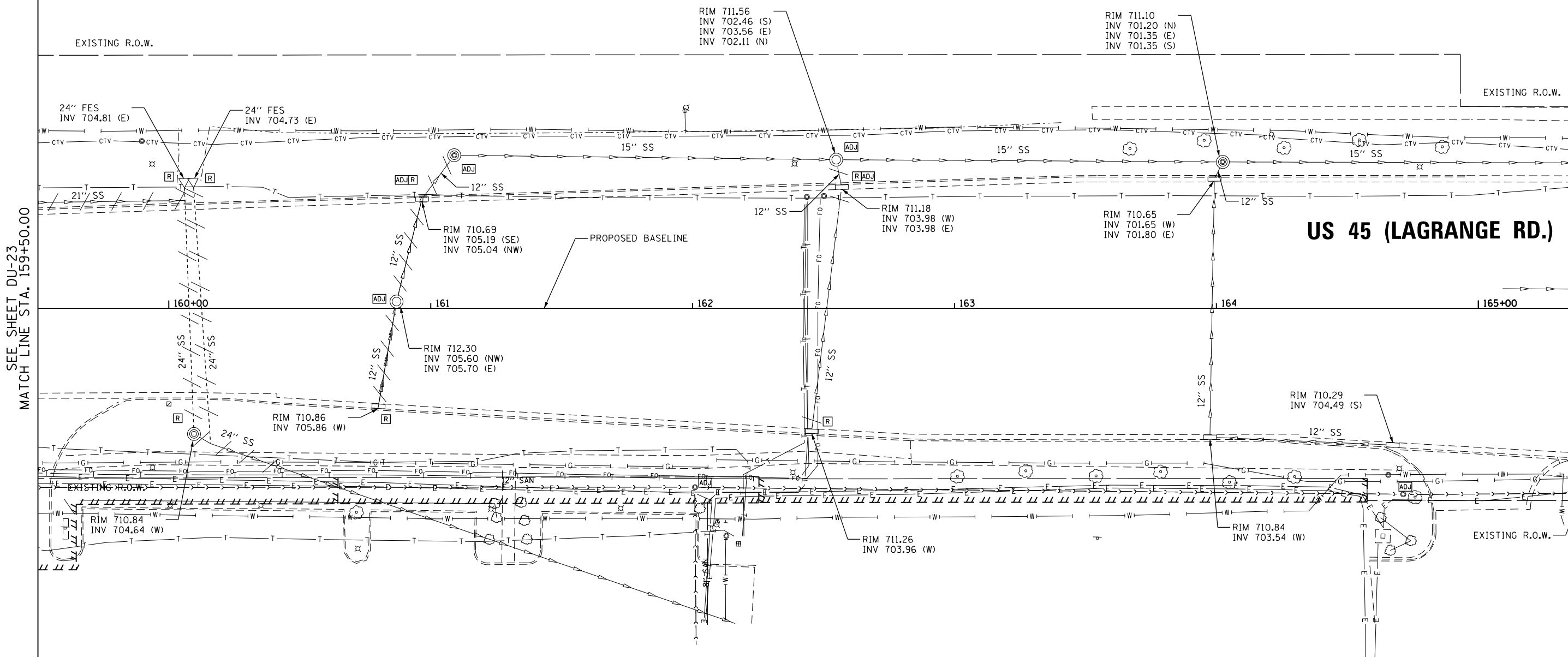

SEE SHEET DU-23
 MATCH LINE STA. 159+50.00

MATCH LINE STA. 165+50.00
 SEE SHEET DU-25

US 45 (LAGRANGE RD.)

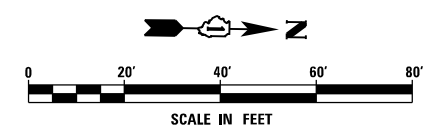

NOTE:
 1. SEE DRAWING DN-01 FOR DRAINAGE LEGEND AND NOTES.
 2. SEE DRAWINGS DS-01 THROUGH DS-11 FOR STRUCTURE AND PIPE INFORMATION

URS
 100 S. WACKER DR.
 SUITE 600
 CHICAGO, IL 60606
 TEL (312) 939-1000
 FAX (312) 939-4998

FILE NAME = D:\160F05-KEA-SHT-DRAINEX24.dgn	USER NAME = Frank.Stallone	DESIGNED - MGS	REVISED -
PLOT SCALE = 40.00' / in.	CHECKED - JRS	DRAWN - REW	REVISED -
PLOT DATE = 3/14/2013	DATE - 03/13/13		REVISED -

**STATE OF ILLINOIS
 DEPARTMENT OF TRANSPORTATION**

EXISTING DRAINAGE PLAN - US 45 (LAGRANGE ROAD)

SCALE: 1"=20' SHEET 24 OF 35 SHEETS STA. 159+50.00 TO STA. 165+50.00

F.A.P. RTE.	SECTION	COUNTY	TOTAL SHEETS	SHEET NO.
330	103R-3	COOK	932	280
DU-24			CONTRACT NO. 60F05	
ILLINOIS FED. AID PROJECT				