

CATCH BASINS TO BE ADJUSTED  
 436+13.5, 31.3 RT  
 440+96.0, 19.5 RT  
 440+98.4, 18.7 LT

MANHOLES TO BE ADJUSTED  
 441+16.8, 32.5 LT

REMOVING MANHOLES  
 436+09.1, 25.5 LT  
 439+77.5, 31.0 LT

REMOVING CATCH BASINS  
 436+14.2, 10.3 LT  
 439+41.6, 21.9 RT  
 439+52.1, 16.2 LT

STORM SEWER REMOVAL - 12"  
 STA. 436+09.1 TO 436+14.2 - 12'  
 STA. 439+43.0 TO 439+76.0 - 59'  
 STA. 439+52.1 TO 439+67.8 - 14'

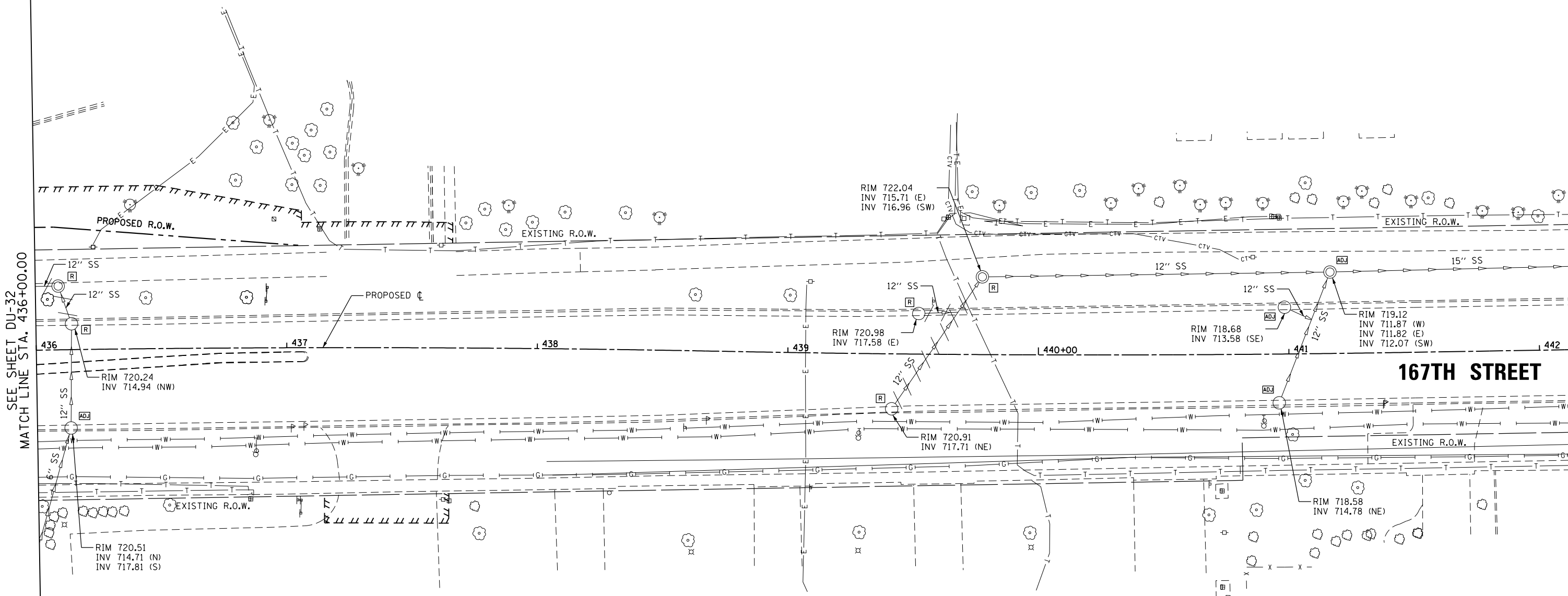

SEE SHEET DU-32  
 MATCH LINE STA. 436+00.00

**167TH STREET**

NOTE:  
 1. SEE DRAWING DN-01 FOR DRAINAGE LEGEND AND NOTES.  
 2. SEE DRAWINGS DS-01 THROUGH DS-11 FOR STRUCTURE AND PIPE INFORMATION

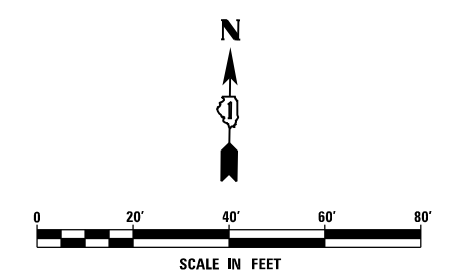

URS  
 100 S. WACKER DR.  
 SUITE 600  
 CHICAGO, IL 60606  
 TEL (312) 935-1000  
 FAX (312) 935-4998

FILE NAME = D160F05-KEA-SHT-DRAINEX33.dgn	USER NAME = Frank.Stallone	DESIGNED - MGS	REVISED -	<b>STATE OF ILLINOIS DEPARTMENT OF TRANSPORTATION</b>	<b>EXISTING DRAINAGE PLAN - 167TH STREET</b>			F.A.P. RTE. 330	SECTION 103R-3	COUNTY COOK	TOTAL SHEETS 932	SHEET NO. 289
SHT.PLAN	PLOT SCALE = 40.0001' / in.	CHECKED - JRS	REVISED -		SCALE: 1"=20'	SHEET 33 OF 35 SHEETS	STA. 436+00.00 TO STA. END	<b>DU-33</b> CONTRACT NO. 60F05				
	PLOT DATE = 3/14/2013	DATE - 03/13/13	REVISED -		ILLINOIS FED. AID PROJECT							