

REMOVING INLETS
401+50.4, 17.3 RT
401+52.0, 17.1 LT

REMOVING CATCH BASINS
401+73.9, 37.8 RT

STORM SEWER REMOVAL - 12"
STA. 401+50.4 TO 401+52.0 - 33'

STORM SEWER REMOVAL - 15"
STA. 401+31.0 TO 401+50.4 - 18'
STA. 401+50.4 TO 401+73.9 - 28'

SEE DU-18 FOR US 45 EXISTING DRAINAGE

PROPOSED R.O.W.

PROPOSED R.O.W.

US 45 (LAGRANGE RD.)

165TH STREET

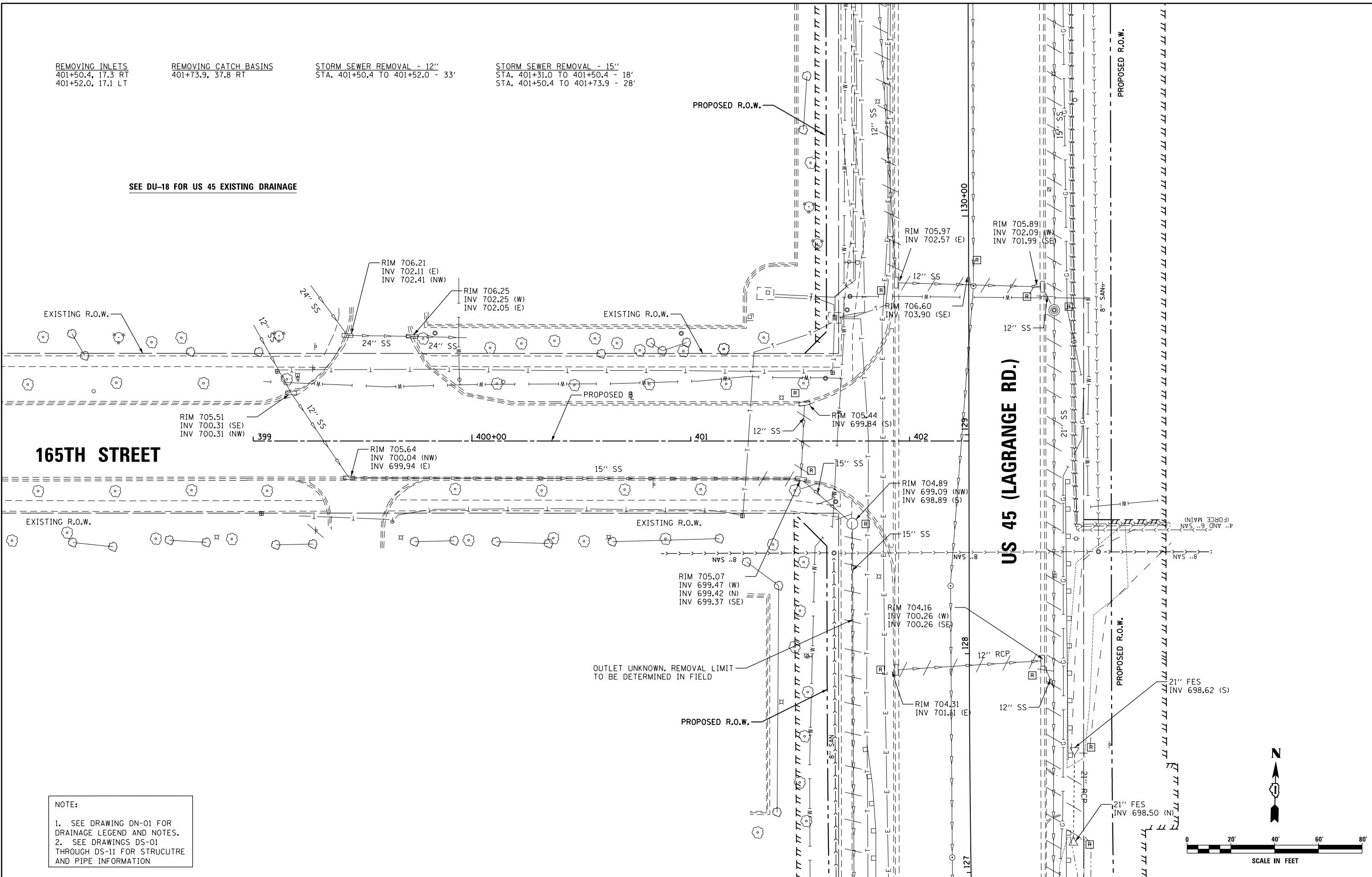

RIM 705.51
INV 700.31 (SE)
INV 700.31 (NW)

RIM 705.64
INV 700.04 (NW)
INV 699.94 (E)

RIM 706.25
INV 702.25 (W)
INV 702.05 (E)

RIM 706.21
INV 702.11 (E)
INV 702.41 (NW)

RIM 705.97
INV 702.57 (E)

RIM 705.89
INV 702.09 (NW)
INV 701.99 (SE)

RIM 706.60
INV 703.90 (SE)

RIM 705.44
INV 699.84 (S)

RIM 704.89
INV 699.09 (NW)
INV 698.89 (S)

RIM 705.07
INV 699.47 (W)
INV 699.42 (N)
INV 699.37 (SE)

RIM 704.16
INV 700.26 (W)
INV 700.26 (SE)

RIM 704.31
INV 701.41 (E)

21" FES
INV 698.62 (S)

21" FES
INV 698.50 (N)

OUTLET UNKNOWN, REMOVAL LIMIT
TO BE DETERMINED IN FIELD

NOTE:
1. SEE DRAWING DN-01 FOR DRAINAGE LEGEND AND NOTES.
2. SEE DRAWINGS DS-01 THROUGH DS-11 FOR STRUCTURE AND PIPE INFORMATION

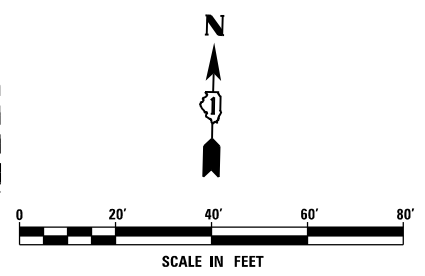

URS
100 S. WACKER DR.
SUITE 600
CHICAGO, IL 60606
TEL (312) 935-1000
FAX (312) 935-4998

FILE NAME = D160F05-KEA-SHT-DRAINEX34.dgn	USER NAME = Frank.Stallone	DESIGNED - MGS	REVISED -
SHT_PLAN	PLOT DATE = 3/14/2013	DRAWN - REW	REVISED -
		CHECKED - JRS	REVISED -
		DATE - 03/13/13	REVISED -

STATE OF ILLINOIS
DEPARTMENT OF TRANSPORTATION

EXISTING DRAINAGE PLAN - 165TH STREET
SCALE: 1"=20' SHEET 34 OF 35 SHEETS STA. TO STA.

F.A.P. RTE. 330	SECTION 103R-3	COUNTY COOK	TOTAL SHEETS 932	SHEET NO. 290
DU-34		CONTRACT NO. 60F05		
ILLINOIS FED. AID PROJECT				