

CATCH BASINS TO BE ADJUSTED
 375+27.4, 16.6 RT
 375+28.0, 17.2 LT
 380+05.5, 13.2 LT
 380+10.7, 30.5 RT

REMOVING CATCH BASINS
 380+10.0, 15.6 LT
 377+05.0, 25.0 LT

REMOVING MANHOLES
 377+32.8, 33.0 LT

REMOVING INLETS
 375+49.8, 27.6 RT
 376+30.4, 17.5 LT

US 45 (LAGRANGE RD.)

163RD STREET

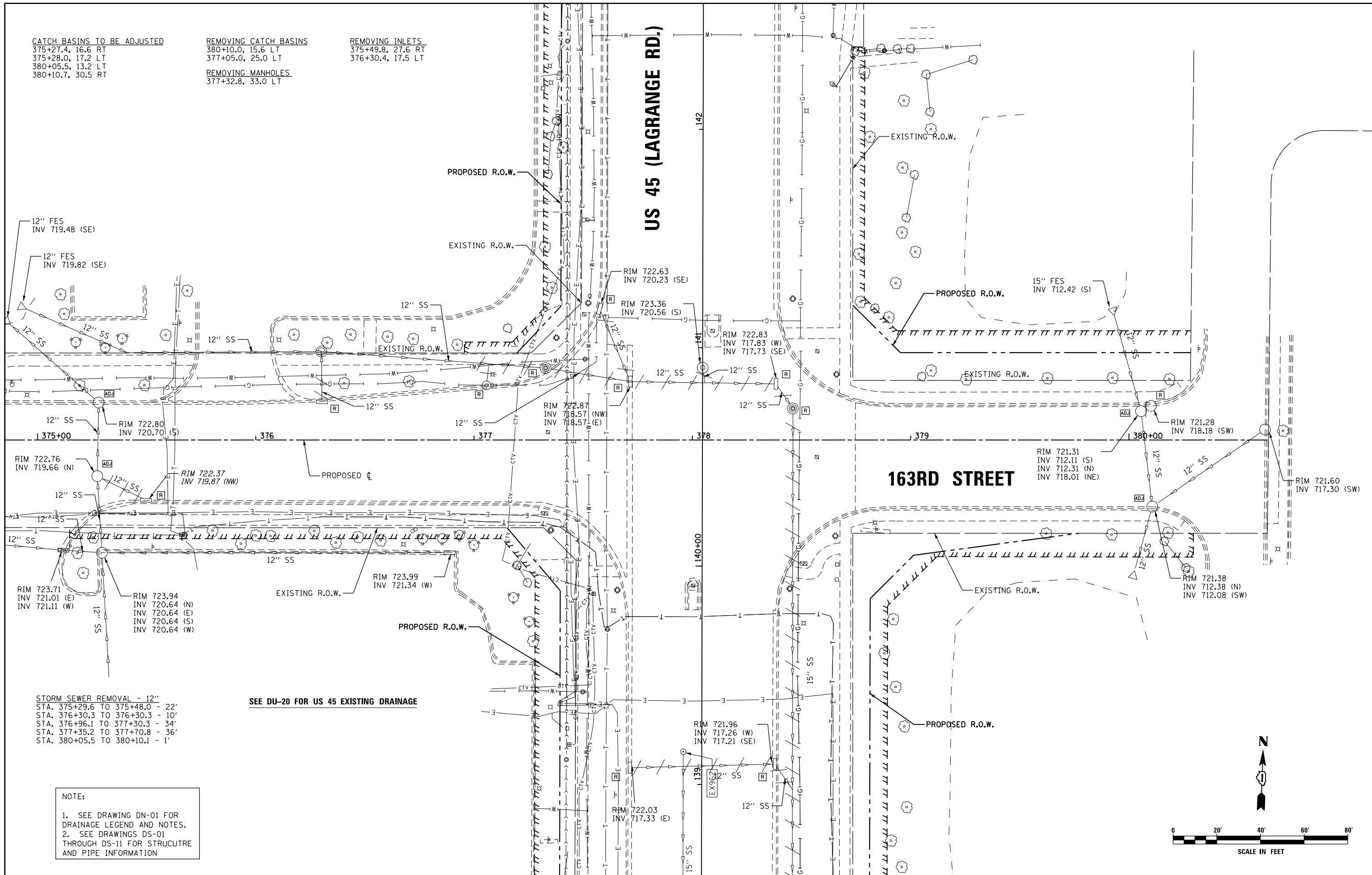

STORM SEWER REMOVAL - 12"
 STA. 375+29.6 TO 375+48.0 - 22'
 STA. 376+30.3 TO 376+30.3 - 10'
 STA. 376+96.1 TO 377+30.3 - 34'
 STA. 377+35.2 TO 377+70.8 - 36'
 STA. 380+05.5 TO 380+10.1 - 1'

SEE DU-20 FOR US 45 EXISTING DRAINAGE

NOTE:

- SEE DRAWING DN-01 FOR DRAINAGE LEGEND AND NOTES.
- SEE DRAWINGS DS-01 THROUGH DS-11 FOR STRUCTURE AND PIPE INFORMATION

URS
 100 S. WACKER DR.
 SUITE 600
 CHICAGO, IL 60606
 TEL (312) 935-1000
 FAX (312) 935-4998

FILE NAME = D160F05-KEA-SHT-DRAINEX35.dgn
 SHT.PLAN

USER NAME = Frank.Stallone
 PLOT SCALE = 40.0001' / in.
 PLOT DATE = 3/14/2013

DESIGNED - MGS
 DRAWN - REW
 CHECKED - JRS
 DATE - 03/13/13

REVISED -
 REVISED -
 REVISED -
 REVISED -

**STATE OF ILLINOIS
 DEPARTMENT OF TRANSPORTATION**

EXISTING DRAINAGE PLAN - 163RD STREET

SCALE: 1"=20' SHEET 35 OF 35 SHEETS STA. TO STA.

F.A.P. RTE.	SECTION	COUNTY	TOTAL SHEETS	SHEET NO.
330	103R-3	COOK	932	291
DU-35			CONTRACT NO. 60F05	
ILLINOIS FED. AID PROJECT				