

STATE BANK
OF COUNTRYSIDE

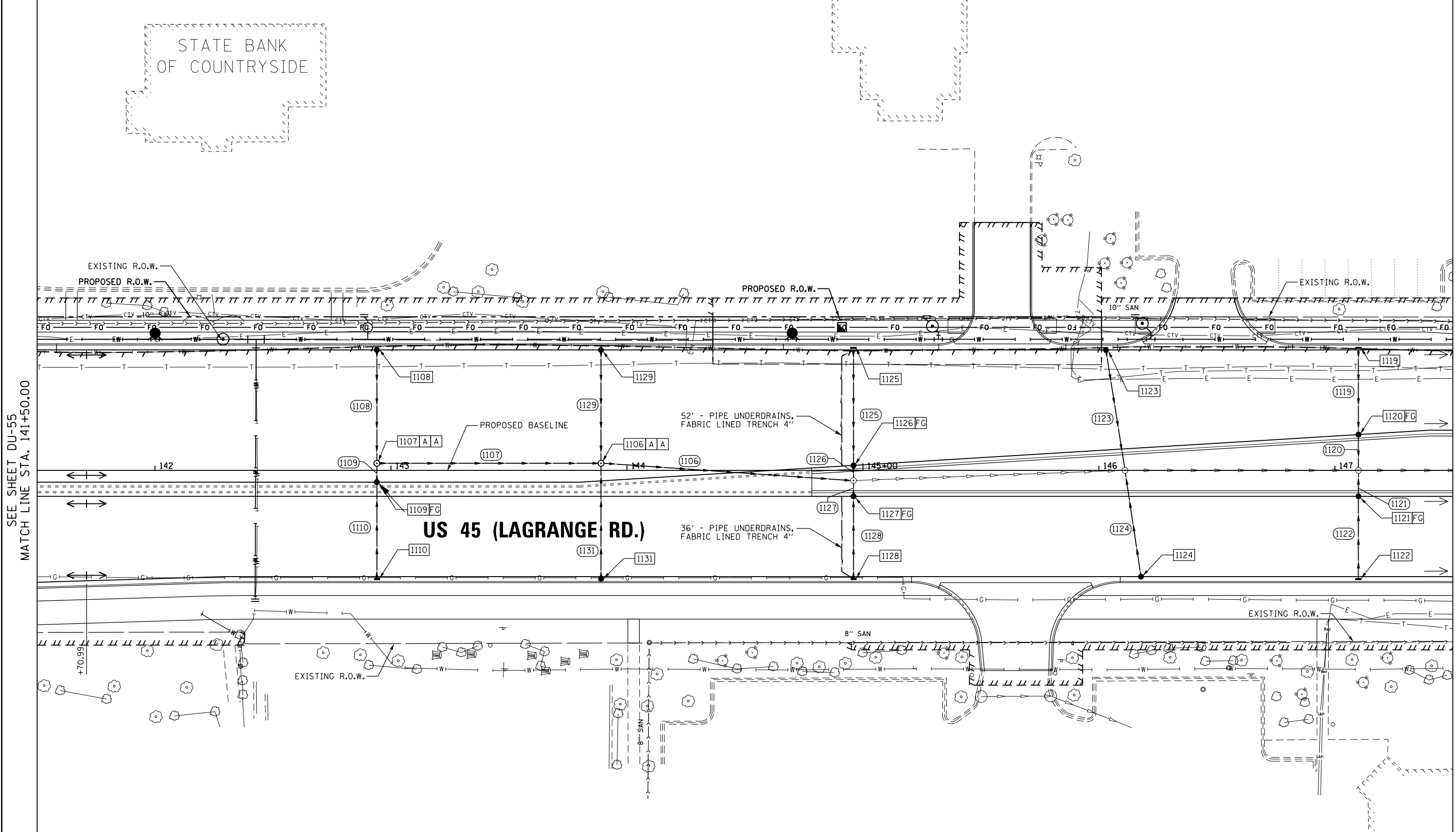

SEE SHEET DU-55
MATCH LINE STA. 141+50.00

MATCH LINE STA. 147+50.00
SEE SHEET DU-57

US 45 (LAGRANGE RD.)

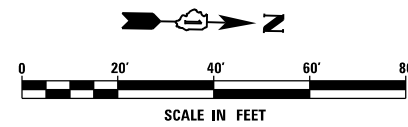

NOTE:
1. SEE DRAWING DN-01 FOR DRAINAGE LEGEND AND NOTES.
2. SEE DRAWINGS DS-01 THROUGH DS-11 FOR STRUCTURE AND PIPE INFORMATION

URS
100 S. WACKER DR.
SUITE 600
CHICAGO, IL 60606
TEL (312) 939-1000
FAX (312) 939-4998

FILE NAME = D160F05-KEA-SHT-DRAINPR21.dgn	USER NAME = Anthony.Plutz	DESIGNED - MGS	REVISED -
		DRAWN - REW	REVISED -
		CHECKED - JRS	REVISED -
SHT.PLAN	PLOT DATE = 3/13/2013	DATE - 03/13/13	REVISED -

**STATE OF ILLINOIS
DEPARTMENT OF TRANSPORTATION**

PROPOSED DRAINAGE PLAN - US 45 (LAGRANGE ROAD)

SCALE: 1"=20' SHEET 21 OF 35 SHEETS STA. 141+50.00 TO STA. 147+50.00

F.A.P. RTE.	SECTION	COUNTY	TOTAL SHEETS	SHEET NO.
330	103R-3	COOK	932	312
DU-56		CONTRACT NO. 60F05		
ILLINOIS FED. AID PROJECT				