

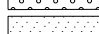
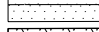
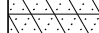
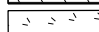
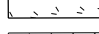

LANDSCAPING LEGEND

-  SEEDING CLASS 2A
TOPSOIL, 6"//WEED CONTROL
-  SEEDING CLASS 4
TOPSOIL, 6"//WEED CONTROL
-  SEEDING CLASS 4B (MOD)
TOPSOIL, 6"//WEED CONTROL
-  INTERSEEDING, CLASS 4
-  SODDING, SALT TOLERANT
TOPSOIL, 24" (MEDIAN ONLY)//WEED
TOPSOIL 6" (EXCEPT MEDIAN)//WEED
-  EROSION CONTROL BLANKET
-  SELECTIVE MOWING STAKE WITH
WETLAND OR PRAIRIE PLANT SIGN

PAVEMENT MARKING NOTES:

1. FOR PCC PAVEMENT:
POLYUREA PAVEMENT MARKING TYPE I SHALL BE USED FOR FINAL PAVEMENT MARKINGS OF THE SIZE AND COLOR SPECIFIED.
2. FOR HOT-MIX ASPHALT PAVEMENT:
THERMOPLASTIC PAVEMENT MARKING SHALL BE USED FOR FINAL PAVEMENT MARKINGS OF THE SIZE AND COLOR SPECIFIED.
3. FOR RAISED REFLECTIVE PAVEMENT MARKERS PLACEMENT,
SPACING AND COLOR SEE DISTRICT 1 STANDARD TC-11.

LANDSCAPING NOTES:

1. PLAN VIEW BREAKS BETWEEN SEEDING TYPES ARE APPROXIMATE. SEE PROPOSED CROSS SECTIONS FOR DETAILS.
2. MULCH METHOD 2 SHALL BE USED AT ALL SEEDING LOCATIONS NOT PROTECTED BY EROSION CONTROL BLANKET. HATCHING HAS BEEN OMITTED FOR CLARITY.
3. WEED CONTROL, NON-SELECTIVE AND NON-RESIDUAL SHOULD BE USED AT ALL SEEDING AND INTERSEEDING CLASS 4 AREAS ADJACENT TO WETLAND AND FOREST PRESERVE.
4. WEED CONTROL, BROADLEAF, SHOULD BE USED IN TURF AREAS INCLUDING ALL SEEDING 2A AND SODDING.
5. WEED CONTROL, TEASEL SHOULD BE USED ALONG RIGHT-OF-WAY WHERE PRESENT.
6. SEE LANDSCAPING PLAN (TINLEY PARK) FOR COORDINATION OF SOD PLACEMENT & MULCH METHOD 4.

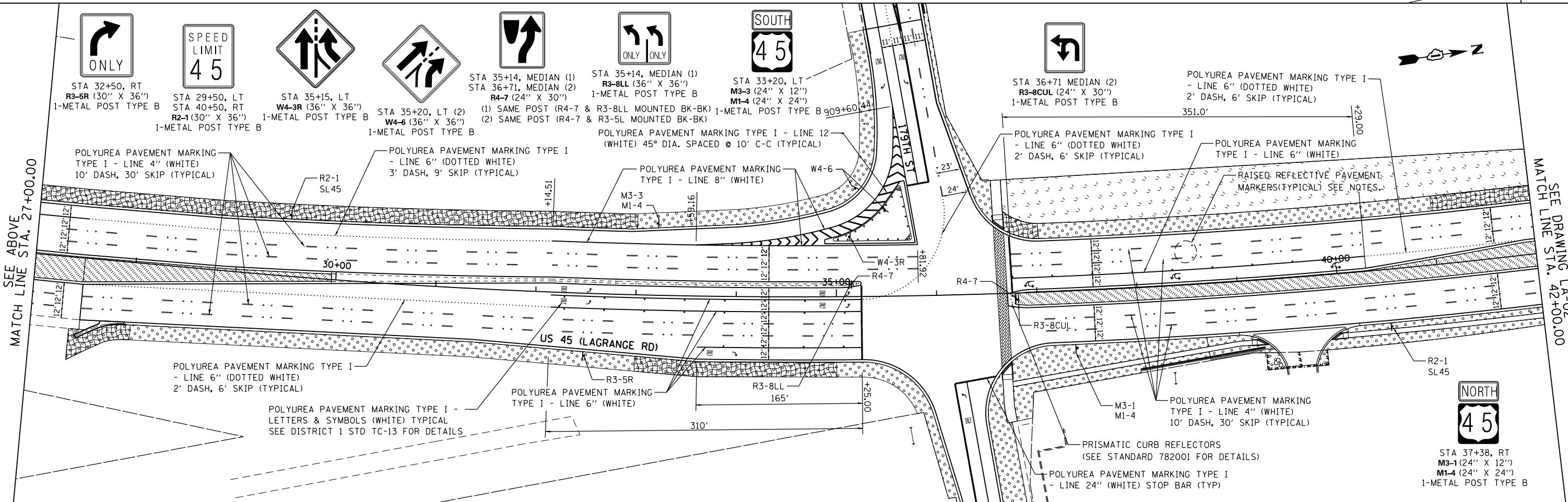
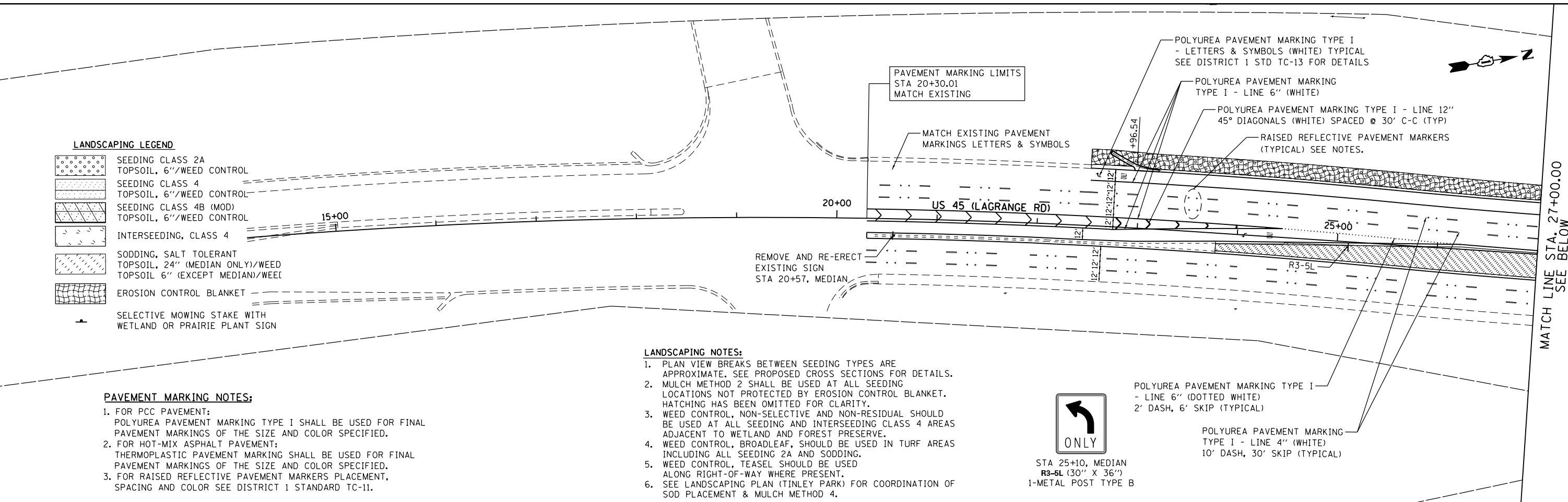

100 S. WACKER DR.
 10TH FLOOR
 CHICAGO, IL 60606
 TEL (312) 939-1000
 FAX (312) 939-4998
URS

FILE NAME =	USER NAME = Frank.Stallone	DESIGNED - BFH	REVISED -
D160F05-SHT-LNDSCP-PMK01.dgn		DRAWN - BFH	REVISED -
		CHECKED - MJT	REVISED -
SHT_PLAN	PLOT DATE = 3/13/2013	DATE - 03/13/13	REVISED -

**STATE OF ILLINOIS
DEPARTMENT OF TRANSPORTATION**

**LANDSCAPING, PAVEMENT MARKING AND SIGNING PLAN
US 45 (LAGRANGE ROAD)**

SCALE: 1"=50' SHEET NO. 1 OF 6 SHEETS STA. BEGIN TO STA. 42+00.00

F.A.P. RTE.	SECTION	COUNTY	TOTAL SHEETS	SHEET NO.
330	103R-3	COOK	932	415
LA-01		CONTRACT NO. 60F05		
ILLINOIS FED. AID PROJECT				