

1 LANDSCAPE PLAN
1"=20'-0"

PLANT SCHEDULE						
SHADE TREES						
CODE	QUANTITY	BOTANICAL NAME	COMMON NAME	SIZE	ROOT	REMARKS
LT	3	Liliodendron tulipifera	Tulip Tree	2.5" cal.	B&B	matching heads
QI	14	Quercus imbricaria	Shingle Oak	2.5" cal.	B&B	matching heads
ORNAMENTAL TREES						
CODE	QUANTITY	BOTANICAL NAME	COMMON NAME	SIZE	ROOT	REMARKS
OV	1	Ostrya virginiana	American Hopbeam	10"H	B&B	multi-stem
PV	19	Prunus virginiana 'Canada Red'	Canada Red Cherry	2.5" cal.	B&B	matching heads
SHRUBS						
CODE	QUANTITY	BOTANICAL NAME	COMMON NAME	SIZE	ROOT	REMARKS
CD	8	Cornus racemosa	Gray Dogwood	36"H	B&B	48" o.c.
HK	42	Hypericum kalmianum 'Ames'	St. Johnswort	18"H	pot	30" o.c.
PO	45	Physocarpus opulifolius 'Monlo'	Diablo Ninebark	36"H	B&B	40" o.c.
RA	170	Rhus aromatica 'Gro Low'	Grow Low Sumac	24"W	pot	30" o.c.
RO.R	34	Rosa 'Radrazz'	Knock Out Red Rose	3 gal.	pot	36" o.c.
SP.TR	136	Spirea 'Tor'	Birchleaf Tor Spirea	24"H	pot	30" o.c.
VB.J	6	Viburnum nudum 'Winterthur'	Winterthur Viburnum	48"H	B&B	60" o.c.
PERENNIALS, ORNAMENTAL GRASSES, VINES AND OTHER						
CODE	QUANTITY	BOTANICAL NAME	COMMON NAME	SIZE	ROOT	REMARKS
A.B.F	132	Agastache 'Blue Fortune'	Blue Fortune Agastache	gal.	pot	15" o.c.
CJ	20	Clematis x 'Jackmanii'	Jackman Clematis	gal.	pot	per plan
LS.W	88	Liatris spicata 'White'	White Blazing Star	gal.	pot	15" o.c.
PA	39	Pennisetum alopecuroides	Fountain Grass	gal.	pot	30" o.c.
PA.H	40	Pennisetum alopecuroides 'Hamlin'	Hamlin Dwarf Fountain Grass	gal.	pot	15" o.c.
PT	20	Parthenocissus tricuspidata	Boston Ivy	gal.	pot	per plan
SS	12	Schizachyrium scoparium	Little Bluestem	3 gal.	pot	30" o.c.
SS.CA	249	Schizachyrium scoparium 'Carousel'	Carousel Little Bluestem	3 gal.	pot	24" o.c.
T.R	221	Red Impression Tulip/Darwin Hybrid	Red Impression Tulip	12+ cm	bulb	15" interplanted

NOTES:

- ALL PLANTINGS SHALL FOLLOW IDOT BUREAU OF DESIGN & ENVIRONMENT MANUAL - CHAPTER 59 - LANDSCAPE DESIGN AND EROSION CONTROL 59-7.09 PLANTING IN URBANIZED AREA FOR SIGHT DISTANCES.
- ALL AREAS TO BE LANDSCAPED SHALL BE EXCAVATED TO THE DEPTH APPROPRIATE FOR THE PROPOSED PLANTINGS. NO EXISTING SOD SHALL REMAIN IN NEW PLANTING AREAS.
- PLANT QUANTITIES SHOWN ON DRAWINGS ARE APPROXIMATE. CONTRACTOR SHALL PROVIDE PLANT MATERIALS SUFFICIENT TO COVER AREAS SHOWN ON PLANS AT THE SPACING INDICATED.
- ANY AREAS OUTSIDE OF THE LANDSCAPE BEDS THAT ARE DISTURBED SHALL BE REPLACED IN KIND.
- NO PLANTING SHALL BE CLOSER THAN 72" FROM FACE OF MEDIAN CURB. NO TREES SHALL BE CLOSER THAN 72" FROM FACE OF MEDIAN CURB.
- MULCH METHOD 2 SHALL BE USED AT ALL SEEDING LOCATIONS NOT PROTECTED BY EROSION CONTROL BLANKET. HATCHING MAY HAVE BEEN OMITTED FOR CLARITY.
- WEED CONTROL NON-SELECTIVE AND NON-RESIDUAL (WETLAND SHOULD BE USED AT ALL INTERSEEDING CLASS 4 AREAS.)
- INTERSEEDING. CLASS 4 SHOULD BE USED WITHIN THE LIMITS OF SELECTIVE CLEARING.
- FOR LANDSCAPE PLANTING DETAILS, SEE SHEETS LA-11 & LA-12.
- FOR PLANT SCHEDULE, SEE SHEET LA-13.
- FOR PROPOSED LANDSCAPE WALL DETAILS, SEE SHEET LA-14.
- FOR ADDITIONAL PLANTING NOTES, SEE SHEET LA-12.
- COORDINATE ALL LANDSCAPE PLANTINGS WITH NEW AND EXISTING UTILITY LINES AND STRUCTURES.
- CONNECT ALL UNDERDRAINS TO NEAREST DRAINAGE STRUCTURE. COORDINATE WITH EOR/AOR.
- ALL NEW SHADE TREES SHALL BE 15'-0" MIN. AWAY FROM OVERHEAD UTILITY LINES AND STRUCTURES.
- CONTRACTOR IS RESPONSIBLE FOR VERIFYING EXISTING CONDITIONS AND SURVEY WITH PROPOSED PLANES. COORDINATE ANY DISCREPANCIES WITH EOR/AOR.

LEGEND:

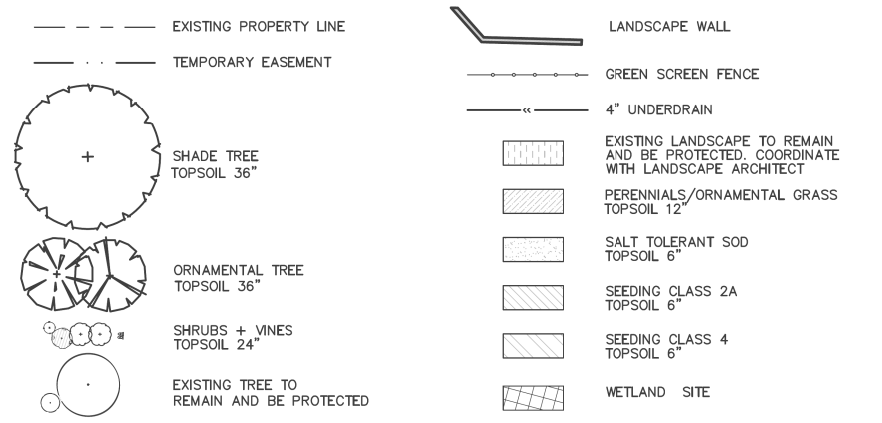

FILE NAME = 7102_Land.dwg	USER NAME = j.grossman	DESIGNED = AB	REVISED =
		DRAWN = JR	REVISED =
		CHECKED = BM	REVISED =
		DATE = 03/13/13	REVISED =

**STATE OF ILLINOIS
DEPARTMENT OF TRANSPORTATION**

LANDSCAPING PLAN US 45 (LAGRANGE ROAD)		
SCALE: AS SHOWN	SHEET NO. 9 OF 15 SHEETS	STA. 81+00.00 TO STA. 87+00.00

F.A.P. RTE. 330	SECTION 103R-3	COUNTY COOK	TOTAL SHEETS 932	SHEET NO. 433
LA-09			CONTRACT NO. 60F05	
ILLINOIS FED. AID PROJECT				