

1 **STANDARD SHRUB INSTALLATION**
NOT TO SCALE

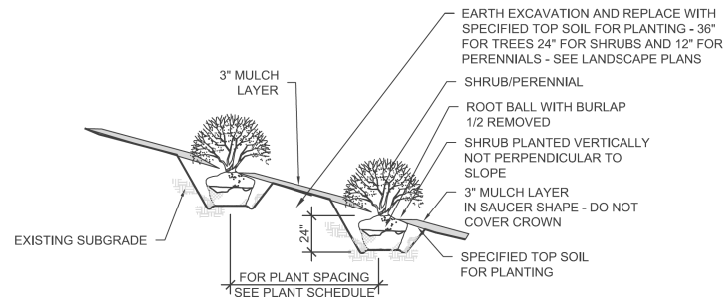

2 **SHRUB/PERENNIAL ON SLOPE INSTALLATION DETAIL**
NOT TO SCALE

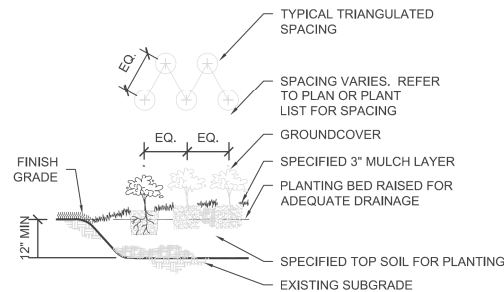

3 **GROUNDCOVER/PERENNIAL INSTALLATION**
NOT TO SCALE

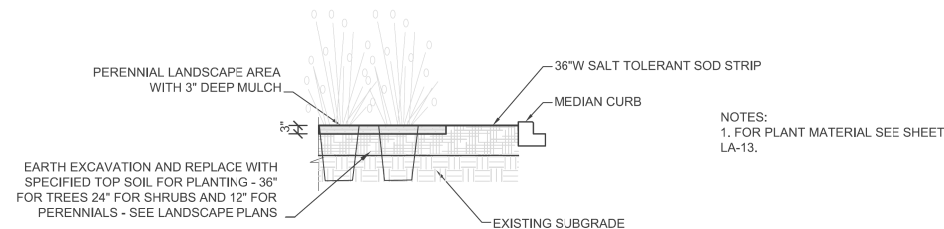

4 **MEDIAN PLANTING BED EDGE DETAIL**
NOT TO SCALE

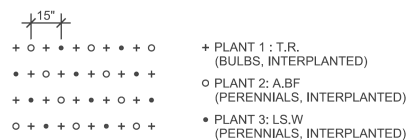

5 **INERPLANTING DETAIL - 3 PLANTS**
NOT TO SCALE

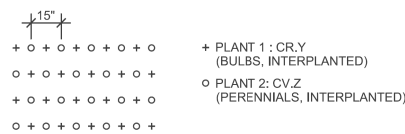

6 **INERPLANTING DETAIL - 2 PLANTS**
NOT TO SCALE

GENERAL PLANTING NOTES

- CONTRACTOR SHALL VERIFY SITE CONDITIONS BEFORE PROCEEDING WITH WORK AND SHALL REPORT ANY CONFLICT TO A/E.
- EXACT LOCATIONS OF ALL UNDERGROUND UTILITIES SHALL BE DETERMINED AND VERIFIED IN THE FIELD BY CONTRACTOR. CONTRACTOR SHALL REPORT ANY CONFLICTS TO A/E PRIOR TO BEGINNING WORK.
- THE CONTRACTOR SHALL COORDINATE THIS WORK WITH OTHER TRADES AND MAINTAIN DRAINAGE DURING CONSTRUCTION.
- CONTRACTOR SHALL KEEP ALL AREAS CLEAN, NEAT AND ORDERLY AT ALL TIMES.
- CONTRACTOR SHALL PROTECT EXISTING VEGETATION OUTSIDE THE LIMITS OF GRADING. ALL EXISTING PARKWAY TREES AND EXISTING INTERIOR TREES SHALL BE PROTECTED WHILE PROJECT IS UNDER CONSTRUCTION AND SHALL BE REPLACED IF DAMAGED BY CONTRACTOR.
- CONTRACTOR SHALL INFORM A/E AS EACH PHASE OF WORK IS UNDERTAKEN.
- SLOPE ALL PLANTING AREAS AWAY FROM BUILDING AT 2% MINIMUM GRADE.
- FINISH GRADE SHALL BE 4" MINIMUM BELOW BUILDING FINISH FLOOR ELEVATION (ADJACENT TO BUILDING SLABS). ALL AREAS SHALL BE RECEIVED BY CONTRACTOR AT +/- 0.1 FOOT TO FINISH GRADE.
- FINISH GRADE SHALL BE 1" BELOW FINISH PAVING SURFACE IN LAWN AREAS AND 2" IN PLANTING AREAS.
- PLANT QUANTITIES SHOWN ON DRAWINGS ARE APPROXIMATE. CONTRACTOR SHALL PROVIDE PLANT MATERIALS SUFFICIENT TO COVER AREAS SHOWN ON PLANS AT THE SPACINGS INDICATED.
- AT LEAST ONE PLANT OF EACH SPECIES DELIVERED TO THE SITE WILL HAVE AN IDENTIFICATION TAG FROM THE SUPPLYING NURSERY SHOWING COMMON AND BOTANICAL PLANT NAMES. ALL PLANTS SHALL BE PROTECTED AGAINST HEAT, SUN, WIND AND FROST DURING TRANSPORTATION TO THE SITE AND WHILE BEING HELD AT THE SITE. DO NOT STORE PLANTS IN TOTAL DARKNESS MORE THAN ONE DAY.
- DO NOT DAMAGE PLANT ROOT BALL DURING TRANSPORTATION OR PLANTING.
- CONTRACTOR SHALL NOTIFY THE A/E AT THE TIME OF DELIVERY OF ANY PLANT MATERIAL THAT IS DAMAGED OR IN POOR CONDITION TO DETERMINE ACCEPTABILITY.
- ALL TREES SHALL BE SINGLE TRUNK STANDARDS UNLESS OTHERWISE NOTED.
- ALL ROCK AND DEBRIS 1" AND LARGER SHALL BE REMOVED FROM PLANTING AREAS AND THEN LEGALLY DISPOSED OF OFF SITE. ALL EXCESS MATERIALS RESULTING FROM CONTRACT WORK SHALL BE LEGALLY DISPOSED OF OFF SITE BY CONTRACTOR.
- A/E RESERVES THE RIGHT TO INSPECT ALL PLANT MATERIALS BEFORE PLANTING. MATERIAL MAY BE REJECTED AT ANY TIME DUE TO CONDITION, FORM OR DAMAGE BEFORE OR AFTER PLANTING. CONTRACTOR SHALL STAKE LOCATION OF ALL TREES, HEDGE LINES AND PLANTING BEDS AND HAVE LAYOUT APPROVED BY A/E PRIOR TO PLANTING.
- THE PLANTING PLANS ARE DIAGRAMMATIC. PLANT MATERIALS SHALL BE SPOTTED APPROXIMATELY AS SHOWN ON THE LANDSCAPE DRAWING AND ARE TO BE APPROVED BY THE A/E BEFORE BEING REMOVED FROM CONTAINERS AND EXCAVATING SOIL FOR PLANTING.
- INSTALL ALL PLANT MATERIAL IN ACCORDANCE WITH DETAILS. ALL FINISH GRADING AND PLANTING OPERATIONS SHALL BE CARRIED OUT IN ACCORDANCE WITH PROJECT SPECIFICATIONS.
- ALL PLANT TYING MATERIAL AND MARKING TAPES SHALL BE REMOVED AT THE TIME OF PLANTING.
- PROVIDE NEW TOPSOIL THAT IS FERTILE, FRIABLE AND NATURAL LOAM SURFACE SOIL, REASONABLY FREE OF SUBSOIL, CLAY, CLAY LUMPS, BRUSH, WEEDS, AND OTHER LITTER AND FREE OF ROOTS, STUMPS, STONES LARGER THAN 2" IN ANY DIMENSION AND OTHER EXTRANEIOUS OR TOXIC MATTER HARMFUL TO PLANT GROWTH. OBTAIN TOPSOIL FROM LOCAL SOURCES OR FROM AREAS HAVING SIMILAR SOIL CHARACTERISTICS TO THAT NECESSARY FOR VIGOROUS GROWTH OF SPECIFIED PLANTINGS. OBTAIN TOPSOIL THAT OCCURS IN A DEPTH OF NOT LESS THAN 6". DO NOT OBTAIN SOIL FROM BOGS OR MARSHES.
- MIX SPECIFIED SOIL AMENDMENTS AND FERTILIZERS WITH TOPSOIL ON A SITE SPECIFIC BASIS AT RATES APPROPRIATE FOR AREA TREES AND SHRUBS IN ACCORDANCE WITH PROJECT SPECIFICATIONS.
- CONTRACTOR SHALL INSTALL A MIN 3" LAYER OF HARDWOOD BARK MULCH (SEE SPECS.) AROUND ALL TREES AND IN ALL GROUND COVER / SHRUB AREAS. CREATE A NATURAL SPADED EDGE WHERE PLANTING BEDS MEET TURF AREAS.
- WATER ALL PLANTS IMMEDIATELY AFTER PLANTING. FLOOD PLANTS TWICE DURING FIRST TWENTY-FOUR HOUR PERIOD OF PLANTING.
- CONTRACTOR SHALL REPAIR TO ITS ORIGINAL CONDITION ANY AREA OR ITEM DAMAGED AS A RESULT OF THEIR WORK. ANY EXISTING LANDSCAPE INDICATED ON THE PLANS THAT IS DAMAGED OR REMOVED DURING DEMOLITION OR CONSTRUCTION SHALL BE REPAIRED AND/OR REPLACED IN KIND AND EQUIVALENT SIZE. CONTRACTOR SHALL REPAIR AND SOD IN KIND ALL TURF AREAS DAMAGED AS A RESULT OF PROJECT CONSTRUCTION.
- CONTRACTOR TO GUY AND STAKE TREES, IF REQUIRED, AS DIRECTED BY A/E, IMMEDIATELY AFTER PLANTING. PROVIDE A MINIMUM OF TWO GUY WIRES PER TREE ON THE UPHILL SIDE OF TREES PLANTED ON SLOPES STEEPER THAN 3:1.
- PROVIDE WIRE TIES AND GUYS OF 2-STRAND, TWISTED, PLIABLE GALVANIZED IRON WIRE, NOT LIGHTER THAN 12 GAGE WITH ZINC-COATED TURNBUCKLES. PROVIDED NOT LESS THAN 1/2" DIAMETER RUBBER OR PLASTIC HOSE, CUT TO REQUIRED LENGTHS AND OF UNIFORM COLOR, MATERIAL, AND SIZE TO PROTECT TREE TRUNKS FROM DAMAGE BY WIRES.
- CONTRACTOR TO WARRANTY ALL TREES AND SHRUBS AGAINST DEATH AND DEFECTS INCLUDING UNSATISFACTORY GROWTH, EXCEPT FOR DEFECTS RESULTING FROM NEGLIGENCE BY OWNER, ABUSE OR DAMAGE BY OTHERS OR UNUSUAL PHENOMENON OR INCIDENTS WHICH ARE BEYOND THE CONTRACTOR'S CONTROL (SEE SPECS).
- PROTECT SEEDED AREAS AND SLOPES AGAINST EROSION AND SEED LOSS DUE TO BIRDS AND OTHER WILDLIFE BY APPLYING SHORT TERM, BIODEGRADABLE EROSION CONTROL BLANKETS, MATS, AND/OR NETTING AFTER COMPLETION OF SEEDING OPERATIONS. ADHERE TO MANUFACTURER'S SPECIFICATIONS FOR REQUIRED PLACEMENT AND STAKING.
- REMOVE AGGREGATE FILL TO AN ADEQUATE DEPTH TO ENSURE THAT NO PART OF THE PLANT MATERIAL IS IN CONTACT OR AFFECTED BY THE LIME IN THE AGGREGATE FILL AS APPROVED BY A/E.

FILE NAME =	USER NAME = jrossman	DESIGNED = AB	REVISED =
7102_landdtl.dwg		DRAWN = JR	REVISED =
	PLOT SCALE = AS SHOWN	CHECKED = BM	REVISED =
	PLOT DATE = 2/4/2013	DATE = 03/13/13	REVISED =

STATE OF ILLINOIS
DEPARTMENT OF TRANSPORTATION

LANDSCAPING DETAILS II

SCALE: AS SHOWN SHEET NO. 12 OF 15 SHEETS STA. BEGIN TO STA. 89+50.00

F.A.P. RTE.	SECTION	COUNTY	TOTAL SHEETS	SHEET NO.
330	103R-3	COOK	932	436
LA-12			CONTRACT NO. 60F05	
ILLINOIS FED. AID PROJECT				