

CONTROLLER SEQUENCE

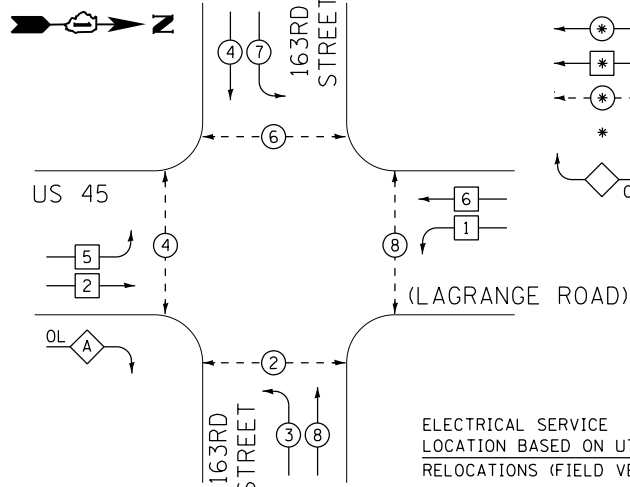

PHASE DESIGNATION DIAGRAM LEGEND

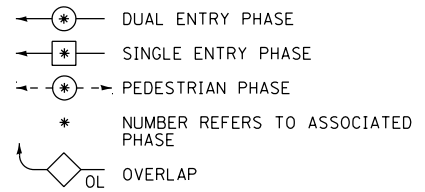

PHASE DESIGNATION DIAGRAM

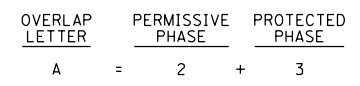

EMERGENCY VEHICLE PREEMPTION SEQUENCE

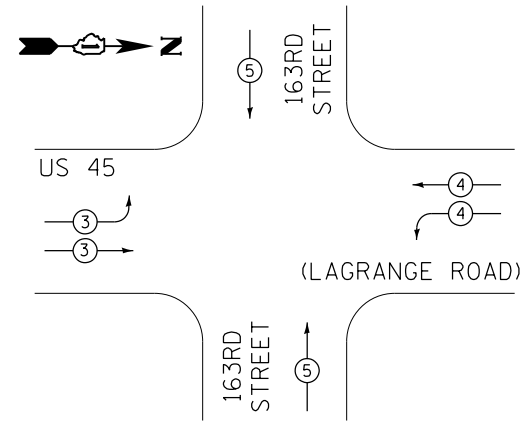

PROPOSED EMERGENCY VEHICLE PREEMPTORS			
EMERGENCY VEHICLE PREEMPTORS	3	4	5
MOVEMENT			

I.D.O.T. TRAFFIC SIGNAL INSTALLATION ELECTRICAL SERVICE REQUIREMENTS						TOTAL WATTAGE
TYPE	NO. OF LAMPS	WATTAGE INCAND.	LED	% OPERATION		
SIGNAL (RED)	22	17	0.50		187.0	
(YELLOW)	22	25	0.25		137.5	
(GREEN)	22	15	0.25		82.5	
ARROW	12	12	0.10		14.4	
PED. SIGNAL	8	25	1.00		200.0	
CONTROLLER	1	100	1.00		100.0	
ILLUM. SIGN	4	25	0.05		5.0	
FLASHER		25	0.50			
ENERGY COST TO:	TOTAL =				726.4	

VILLAGE OF ORLAND PARK
14700 SOUTH RAVINIA AVE.
ENERGY SUPPLY: CONTACT: KATHRYN SUGRUE
PHONE: (708) 235-2337
COMPANY: COMMONWEALTH EDISON

FILE NAME = D:\160F05-SHT-TD46.dgn
SHT.PLAN

USER NAME = Frank.Stallone
DESIGNED - MRF
DRAWN - MRF
PLOT SCALE = 48.0000' / in.
CHECKED - MJL
PLOT DATE = 3/14/2013

REVISIED -
REVISIED -
REVISIED -
REVISIED -
DATE - 03/13/13

STATE OF ILLINOIS DEPARTMENT OF TRANSPORTATION

SCHEDULE OF QUANTITIES, CABLE PLAN, PHASE DESIGNATION DIAGRAM AND EMERGENCY VEHICLE PREEMPTION SEQUENCE
US 45 (LAGRANGE ROAD) AND 163RD STREET
SCALE: N.T.S. SHEET 1 OF 1 SHEETS STA. TO STA.

SCHEDULE OF QUANTITIES

ITEM	UNIT	TOTAL
SIGN PANEL - TYPE 1	50 FT	60
SERVICE INSTALLATION - GROUND MOUNTED	EACH	1
UNDERGROUND CONDUIT, GALVANIZED STEEL, 2" DIA.	FOOT	1011
UNDERGROUND CONDUIT, GALVANIZED STEEL, 2 1/2" DIA.	FOOT	39
UNDERGROUND CONDUIT, GALVANIZED STEEL, 3 1/2" DIA.	FOOT	78
UNDERGROUND CONDUIT, GALVANIZED STEEL, 4" DIA.	FOOT	614
HANDHOLE	EACH	5
HEAVY-DUTY HANDHOLE	EACH	4
DOUBLE HANDHOLE	EACH	2
FULL-ACTUATED CONTROLLER AND TYPE IV CABINET, SPECIAL	EACH	1
UNINTERRUPTIBLE POWER SUPPLY, SPECIAL	EACH	1
TRANSCEIVER - FIBER OPTIC	EACH	1
ELECTRIC CABLE IN CONDUIT, SIGNAL NO. 14 2C	FOOT	1656
ELECTRIC CABLE IN CONDUIT, SIGNAL NO. 14 3C	FOOT	2512
ELECTRIC CABLE IN CONDUIT, SIGNAL NO. 14 5C	FOOT	3100
ELECTRIC CABLE IN CONDUIT, SIGNAL NO. 14 7C	FOOT	2284
ELECTRIC CABLE IN CONDUIT, LEAD-IN, NO. 14 1 PAIR	FOOT	2330
ELECTRIC CABLE IN CONDUIT, SERVICE, NO. 4 2 C	FOOT	306
ELECTRIC CABLE IN CONDUIT, EQUIPMENT GROUNDING CONDUCTOR, NO. 6 1C	FOOT	1005
TRAFFIC SIGNAL POST, GALVANIZED STEEL 16 FT.	EACH	1
STEEL COMBINATION MAST ARM ASSEMBLY AND POLE, 50 FT.	EACH	1
STEEL COMBINATION MAST ARM ASSEMBLY AND POLE, 54 FT.	EACH	1
STEEL COMBINATION MAST ARM ASSEMBLY AND POLE, 60 FT.	EACH	2
CONCRETE FOUNDATION, TYPE A	FOOT	4
CONCRETE FOUNDATION, TYPE C	FOOT	4
CONCRETE FOUNDATION, TYPE E 36-INCH DIAMETER	FOOT	30
CONCRETE FOUNDATION, TYPE E 42-INCH DIAMETER	FOOT	42
SIGNAL HEAD, LED, 1-FACE, 3-SECTION, MAST-ARM MOUNTED	EACH	11
SIGNAL HEAD, LED, 1-FACE, 5-SECTION, MAST-ARM MOUNTED	EACH	3
SIGNAL HEAD, LED, 2-FACE, 3-SECTION, BRACKET MOUNTED	EACH	1
SIGNAL HEAD, LED, 2-FACE, 1-3 SECTION, 1-5 SECTION, BRACKET MOUNTED	EACH	3
PEDESTRIAN SIGNAL HEAD, LED, 2-FACE, BRACKET MOUNTED WITH COUNTDOWN TIMER	EACH	4
TRAFFIC SIGNAL BACKPLATE, LOUVERED, ALUMINUM	EACH	14
INDUCTIVE LOOP DETECTOR	EACH	11
DETECTOR LOOP, TYPE 1	FOOT	194
PREFORMED DETECTOR LOOP	FOOT	1001
*LIGHT DETECTOR	EACH	3
*LIGHT DETECTOR AMPLIFIER	EACH	1
PEDESTRIAN PUSH-BUTTON	EACH	8
TEMPORARY TRAFFIC SIGNAL INSTALLATION	EACH	1
REMOVE EXISTING TRAFFIC SIGNAL EQUIPMENT	EACH	1
REMOVE EXISTING HANDHOLE	EACH	10
REMOVE EXISTING CONCRETE FOUNDATION	FOOT	10
*ELECTRIC CABLE IN CONDUIT NO. 20 3/C, TWISTED, SHIELDED	EACH	800
**LED INTERNALLY ILLUMINATED STREET NAME SIGN	EACH	4
ELECTRIC SERVICE DISCONNECT, LIGHTING AND TRAFFIC SIGNAL	EACH	1
TEMPORARY TRAFFIC SIGNAL TIMING	EACH	1

* 100% COST TO ORLAND FIRE PROTECTION DISTRICT
** 100% COST TO VILLAGE OF ORLAND PARK

NOTE: ALL TRAFFIC SIGNAL POLES, MAST ARM ASSEMBLIES, SIGNAL/PEDESTRIAN HEADS AND HOUSINGS, MOUNTING BRACKETS/PLATES/BOLTS, PEDESTRIAN PUSH BUTTONS, CONTROLLER CABINETS, AND ILLUMINATED SIGNS WITHIN THE VILLAGE OF ORLAND PARK SHALL BE PAINTED BLACK, IN ACCORDANCE WITH THE SPECIAL PROVISIONS.

RESTORATION OF WORK AREA. RESTORATION OF THE TRAFFIC SIGNAL WORK AREA SHALL BE INCIDENTAL TO THE RELATED PAY ITEM SUCH AS FOUNDATION, CONDUIT, HANDHOLE, TRENCH AND BACKFILL, ETC., AND NO EXTRA COMPENSATION SHALL BE ALLOWED. ALL ROADWAY SURFACES SUCH AS SHOULDERS, MEDIANS, SIDEWALKS, PAVEMENT, ETC. SHALL BE REPLACED IN KIND. ALL DAMAGE TO MOWED LAWNS SHALL BE REPLACED WITH AN APPROVED SOD, AND ALL DAMAGE TO UNMOWED FIELDS SHALL BE SEEDED IN ACCORDANCE WITH STANDARD SPECIFICATIONS 252 AND 250 RESPECTIVELY.

NOTE: THE TRAFFIC SIGNAL CONTROLLER EQUIPMENT FOR THIS PROJECT SHALL BE "EAGLE" TO MATCH THE EXISTING ADJACENT SYSTEM.

NOTE: NEW PERMANENT SERVICE INSTALLATIONS WITH ILLUMINATED SIGNS AND/OR COMBINATION MAST ARM SIGNAL POLES SHALL BE METERED.

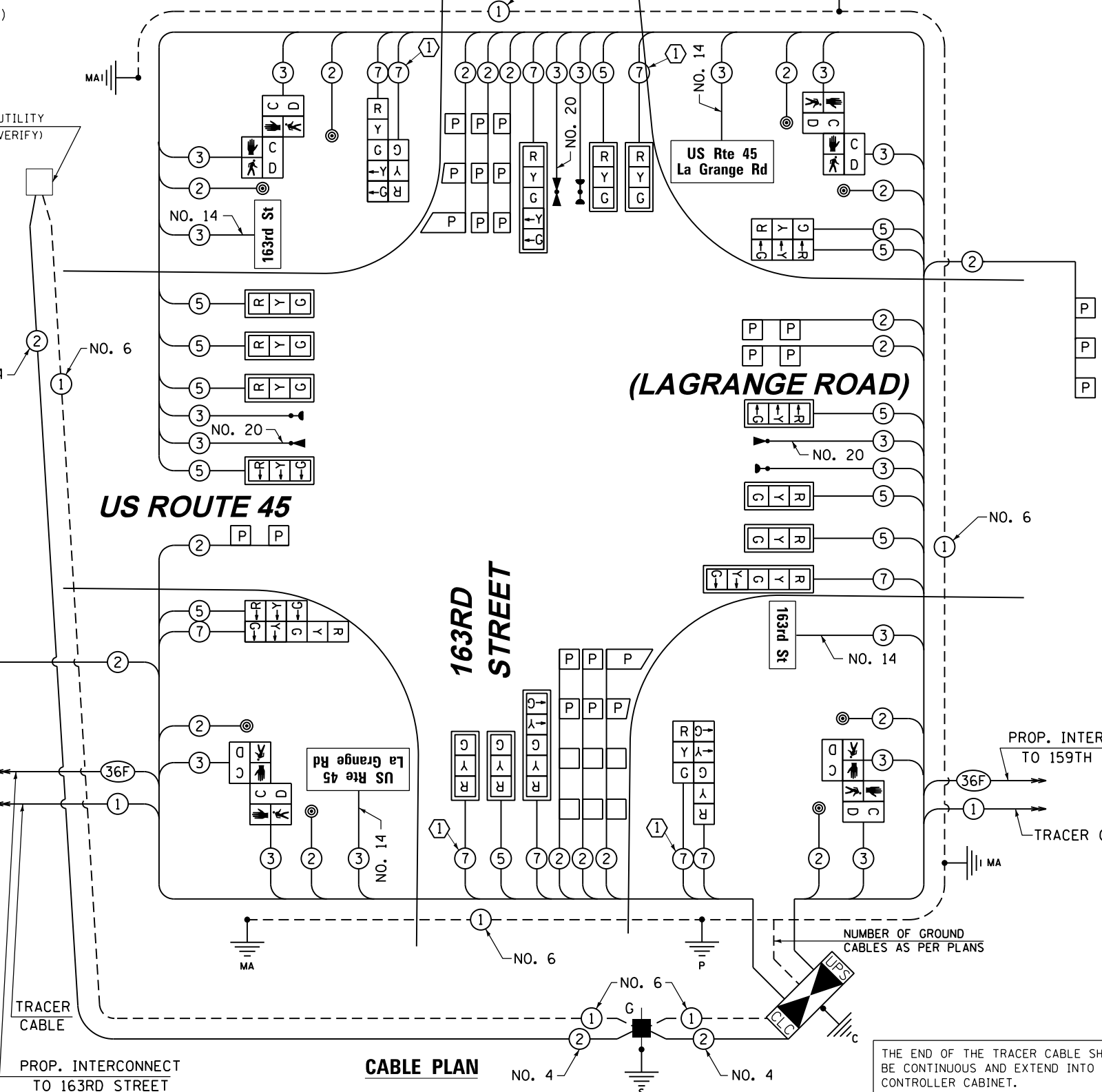

PROTECTED RIGHT TURN ARROWS SHALL NOT BE PROVIDED; HOWEVER, A 7-CONDUCTOR CABLE SHALL BE INSTALLED AS SHOWN (FOR FUTURE USE).

PROP. INTERCONNECT TO 159TH STREET

TRACER CABLE

NUMBER OF GROUND CABLES AS PER PLANS

THE END OF THE TRACER CABLE SHALL BE CONTINUOUS AND EXTEND INTO THE CONTROLLER CABINET.

URS
100 S. WACKER DR.
SUITE 600
CHICAGO, IL 60606
TEL (312) 935-1000
FAX (312) 935-4998

F.A.P. RTE.	SECTION	COUNTY	TOTAL SHEETS	SHEET NO.
330	103R-3	COOK	932	509
TD-46			CONTRACT NO. 60F05	
ILLINOIS FED. AID PROJECT				