

DATE	
BY	
SURVEYED	
PLOTTED	
TEMPLATE	
NOTE BOOK	
AREAS CHECKED	

DATE	
BY	
SURVEYED	
PLOTTED	
TEMPLATE	
NOTE BOOK	
AREAS CHECKED	

BO SWACKER DR.
 300 N. WASHINGTON
 CHICAGO, IL 60606
 TEL 312/939-1000
 FAX 312/939-4198

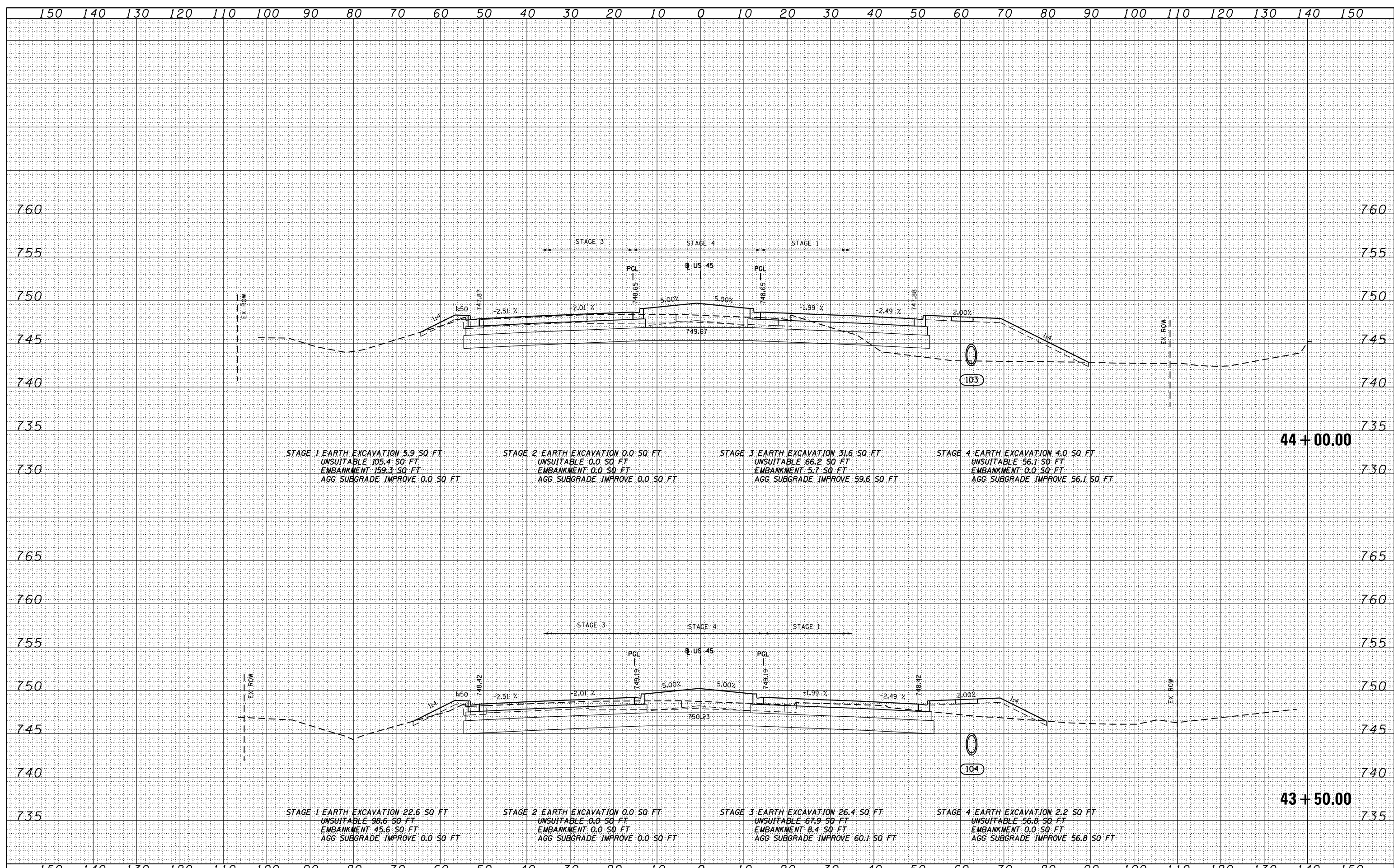

FILE NAME = D160F05-SHT-XSST01.dgn	USER NAME = Anthony.Plutz	DESIGNED - BFH	REVISIED -	STATE OF ILLINOIS DEPARTMENT OF TRANSPORTATION	US 45 CROSS SECTIONS			F.A.P. RTE. 330	SECTION 103R-3	COUNTY COOK	TOTAL SHEETS 932	SHEET NO. 761	
	PLOT SCALE = 20.0000' / in.	CHECKED - E.JG	REVISIED -		SCALE: 1"=10'H; 1"=5'	SHEET NO. 24 OF 147 SHEETS	STA. 43+50.00 TO STA. 44+00.00	XS-US45-24		CONTRACT NO. 60F05			
	PLOT DATE = 3/9/2013	DATE - 03/13/13	REVISIED -		ILLINOIS FED. AID PROJECT								