

DATE	
BY	
FINAL SURVEY	
NO.:	
SURVEYED	
PLOTTED	
TEMPLATE	
AREAS	
CHECKED	

DATE	
BY	
ORIGINAL SURVEY	
NO.:	
SURVEYED	
PLOTTED	
TEMPLATE	
AREAS	
CHECKED	

RO. SWACKER DR.
 500
 CHICAGO, IL 60606
 TEL 312/939-1000
 FAX 312/939-4198

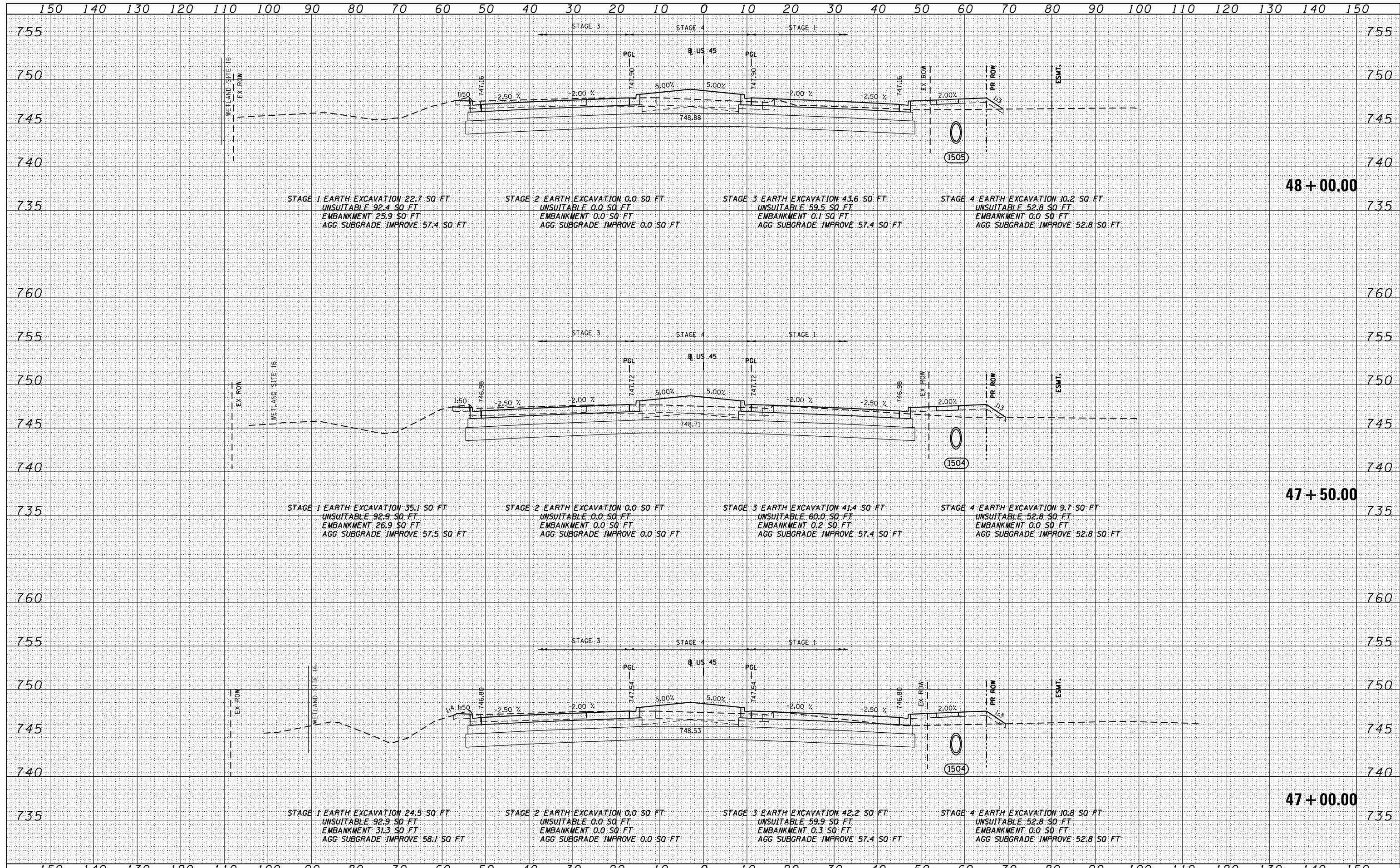

FILE NAME = D160F05-SHT-XSST01.dgn	USER NAME = Anthony.Plutz	DESIGNED - BFH	REvised -	STATE OF ILLINOIS DEPARTMENT OF TRANSPORTATION	US 54 CROSS SECTIONS SCALE: 1"=10'H; 1"=5'	F.A.P. RTE. 330	SECTION 103R-3	COUNTY COOK	TOTAL SHEETS 932	SHEET NO. 764
PLOT SCALE = 20.0000 "/> <td>CHECKED - EJG</td> <td>REvised -</td> <td colspan="2">XS-US45-27</td> <td>CONTRACT NO. 60F05</td>	CHECKED - EJG	REvised -	XS-US45-27			CONTRACT NO. 60F05				
PLOT DATE = 3/9/2013	DATE - 03/13/13	REvised -	ILLINOIS FED. AID PROJECT							
SHEET NO. 27 OF 147 SHEETS STA. 47+00.00 TO STA. 48+00.00										