

DATE	
BY	
FINISHED	
SURVEY	
PLOTTED	
TEMPLATE	
NOTE BOOK	
AREAS CHECKED	
NO.	

DATE	
BY	
ORIGINAL	
SURVEY	
PLOTTED	
TEMPLATE	
NOTE BOOK	
AREAS CHECKED	
NO.	

100 S. WACKER DR.
 CHICAGO, IL 60606
 TEL 312/939-1000
 FAX 312/939-4198

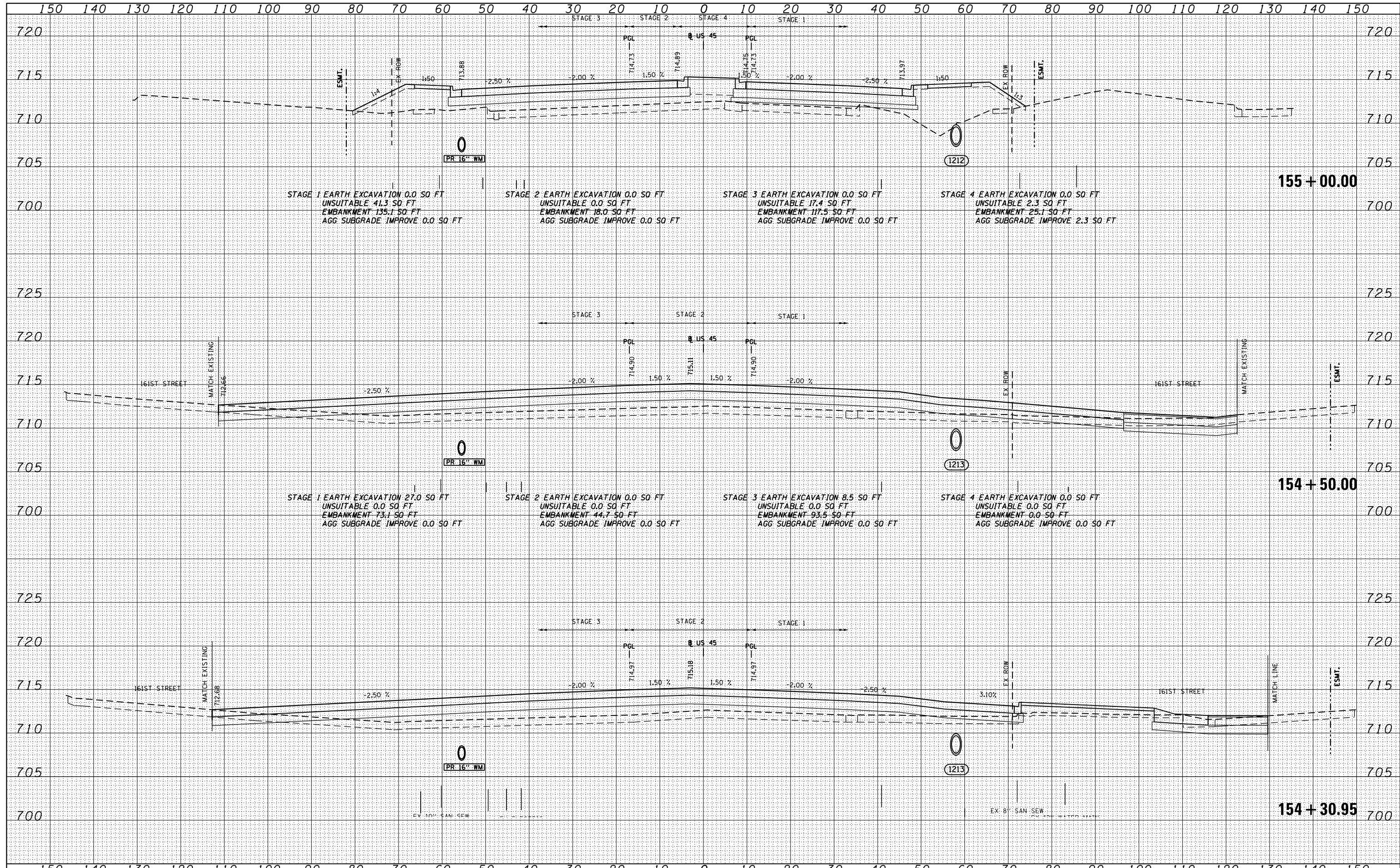

FILE NAME =	USER NAME = Anthony.Plutz	DESIGNED - BFH	REVISED -	STATE OF ILLINOIS DEPARTMENT OF TRANSPORTATION US 545 CROSS SECTIONS SCALE: 1"=10'H; 1"=5'V SHEET NO. 135 OF 147 SHEETS STA. 154+30.95 TO STA. 155+00.00	F.A.P. RE.	SECTION	COUNTY	TOTAL SHEETS	SHEET NO.
D160F05-SHT-XSST01.dgn		DRAWN - BFH	REVISED -		330	103R-3	COOK	932	872
		CHECKED - E.JG	REVISED -		XS-US45-135		CONTRACT NO. 60F05		
		DATE - 03/13/13	REVISED -		ILLINOIS FED. AID PROJECT				