

- ① PROP. 8' WHITE THERMO. PVT. MRK. LETTERS AND SYMBOLS (TYP.)
- ② PROP. THERMO. PVT. MRK.-4" CENTER LINE, SINGLE YELLOW (TYP.)
- ③ PROP. THERMO. PVT. MRK.-4" CENTER LINE, DOUBLE YELLOW (TYP.)
- ④ PROP. THERMO. PVT. MRK.-4" EDGE LINE, SOLID WHITE (TYP.)
- ⑤ PROP. THERMO. PVT. MRK.-4" SKIP-DASH, SINGLE WHITE (TYP.)
- ⑥ PROP. THERMO. PVT. MRK.-6" SOLID LINE, WHITE (TYP.)
- ⑦ PROP. THERMO. PVT. MRK.-6" DOTTED LINE, WHITE (TYP.)
- ⑧ PROP. THERMO. PVT. MRK.-6" PEDESTRIAN, 2x 6"; SOLID WHITE (TYP.)
- ⑨ PROP. THERMO. PVT. MRK.-8" GORE MARKING, SOLID WHITE (TYP.)
- ⑩ PROP. THERMO. PVT. MRK.-12" DIAGONAL, YELLOW, SPACED 75' C-C (TYP.)
- ⑪ PROP. THERMO. PVT. MRK.-12" GORE MARKING CHEVRON, WHITE (TYP.)
- ⑫ PROP. THERMO. PVT. MRK.-24" STOP LINE, WHITE (TYP.)
- ⑬ PROP. POLYUREA PVT. MRK - 4" SKIP-DASH, SINGLE WHITE (TYP.)
- ⑭ PROP. POLYUREA PVT. MRK - 6" DOTTED LINE, WHITE (TYP.)

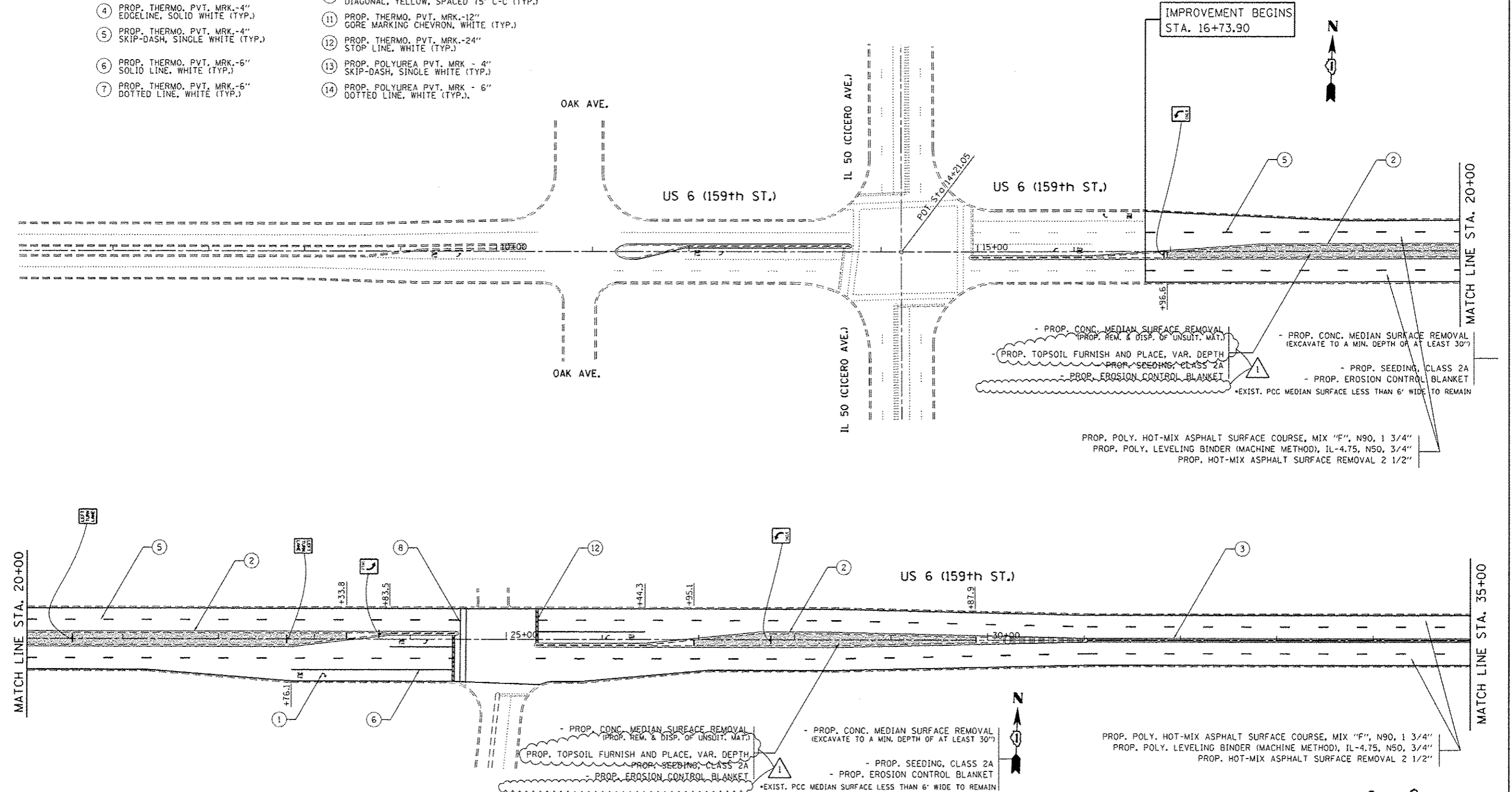

PROP. POLY. HOT-MIX ASPHALT SURFACE COURSE, MIX "F", N90, 1 3/4"  
 PROP. POLY. LEVELING BINDER (MACHINE METHOD), IL-4.75, N50, 3/4"  
 PROP. HOT-MIX ASPHALT SURFACE REMOVAL 2 1/2"

PROP. POLY. HOT-MIX ASPHALT SURFACE COURSE, MIX "F", N90, 1 3/4"  
 PROP. POLY. LEVELING BINDER (MACHINE METHOD), IL-4.75, N50, 3/4"  
 PROP. HOT-MIX ASPHALT SURFACE REMOVAL 2 1/2"

60K98 8 of 32

FILE NAME =	USER NAME = marozkmo	DESIGNED -	REVISED -				
c:\pwork\pids\marozkmo\0207980\0	22618-sht-plan.dgn		3-29-13				
		DRAWN -	REVISED -				
		CHECKED -	REVISED -				
		DATE -	REVISED -				

**STATE OF ILLINOIS**  
**DEPARTMENT OF TRANSPORTATION**

<b>US 6 (159TH ST.)</b>							
<b>IL 50 (CICERO AVE.) TO I-294 (TRI-STATE TOLLWAY)</b>							
SCALE:	SHEET NO.	OF	SHEETS	STA.	TO	STA.	

F.A.P. RTE.	SECTION	COUNTY	TOTAL SHEETS	SHEET NO.
351	3277 RS-4	COOK	32	8
CONTRACT NO. 60K98				
(ILLINOIS) FED. AID PROJECT				