

SUMMARY OF QUANTITIES			URBAN		CONSTRUCTION TYPE CODE				
CODE NO	ITEM	UNIT	TOTAL QUANTITIES	100% STATE 0005					
20201200	REMOVAL AND DISPOSAL OF UNSUITABLE MATERIAL	CU YD	2711	2711					
21101615	TOPSOIL FURNISH AND PLACE, 4"	SO YD	352	352					
21101600	TOPSOIL FURNISH AND PLACE, VARIABLE DEPTH	SO YD	3253	3253					
25000210	SEEDING, CLASS 2A	ACRE	0.672	0.672					
25000400	NITROGEN FERTILIZER NUTRIENT	POUND	41	41					
25000500	PHOSPHORUS FERTILIZER NUTRIENT	POUND	41	41					
25000600	POTASSIUM FERTILIZER NUTRIENT	POUND	41	41					
25100630	EROSION CONTROL BLANKET	SO YD	3253	3253					
25200110	SODDING, SALT TOLERANT	SO YD	352	352					
25200200	SUPPLEMENTAL WATERING	UNIT	5	5					
40600200	BITUMINOUS MATERIALS (PRIME COAT)	TON	101	101					
40600300	AGGREGATE (PRIME COAT)	TON	502	502					
40600400	MIXTURE FOR CRACKS, JOINTS, AND FLANGWAYS	TON	189	189					
40600827	POLYMERIZED LEVELING BINDER (MACHINE METHOD), IL-4.75, N50	TON	5111	5111					
40600895	CONSTRUCTING TEST STRIP	EACH	2	2					

SUMMARY OF QUANTITIES			URBAN		CONSTRUCTION TYPE CODE				
CODE NO	ITEM	UNIT	TOTAL QUANTITIES	100% STATE 0005					
40600982	HOT-MIX ASPHALT SURFACE REMOVAL - BUTT JOINT	SO YD	904	904					
40603595	POLYMERIZED HOT-MIX ASPHALT SURFACE COURSE, MIX "F", N90	TON	12344	12344					
42001300	PROTECTIVE COAT	SO YD	704	704					
44000159	HOT-MIX ASPHALT SURFACE REMOVAL, 2 1/2"	SO YD	124434	124434					
44003510	MEDIAN REMOVAL PARTIAL DEPTH	SO FT	36	36					
44201803	CLASS D PATCHES, TYPE II, 13 INCH	SO YD	1082	1082					
44201807	CLASS D PATCHES, TYPE III, 13 INCH	SO YD	1505	1505					
44201809	CLASS D PATCHES, TYPE IV, 13 INCH	SO YD	1317	1317					
48102100	AGGREGATE WEDGE SHOULDER, TYPE B	TON	246	246					
60252800	CATCHBASINS TO BE RECONSTRUCTED	EACH	4	4					
60300305	FRAMES AND LIDS TO BE ADJUSTED	EACH	7	7					
67000400	ENGINEER'S FIELD OFFICE, TYPE A	CAL MO	6	6					
67100100	MOBILIZATION	L SUM	1	1					
70102625	TRAFFIC CONTROL AND PROTECTION, STANDARD 701606	L SUM	1	1					

1

15

14

Rev. 4-8-13

FILE NAME *	USER NAME * paragon	DESIGNED -	REVISED -	STATE OF ILLINOIS DEPARTMENT OF TRANSPORTATION				US 6 (159TH ST.) SUMMARY OF QUANTITIES				F.A.P. RTE. 351	SECTION 3277 RS-4	COUNTY COOK	TOTAL SHEETS 32	SHEET NO. 3
CLIP WORK PLOT COPY FROM 2007 900 06250 ST plot.dgn	PLOT SCALE * 100000' / in	DRAWN -	REVISED -									CONTRACT NO. 60K98				
	PLOT DATE * 12/26/2012	CHECKED -	REVISED -													
		DATE -	REVISED -													

SUMMARY OF QUANTITIES				URBAN CONSTRUCTION TYPE CODE					SUMMARY OF QUANTITIES				URBAN CONSTRUCTION TYPE CODE				
CODE NO	ITEM	UNIT	TOTAL QUANTITIES	100% STATE 0005					CODE NO	ITEM	UNIT	TOTAL QUANTITIES	100% STATE 0005				
70102630	TRAFFIC CONTROL AND PROTECTION, STANDARD 701601	L SUM	1	1					* 78000100	THERMOPLASTIC PAVEMENT MARKING - LETTERS AND SYMBOLS	SO FT	979	979				
70102635	TRAFFIC CONTROL AND PROTECTION, STANDARD 701701	L SUM	1	1					* 78000200	THERMOPLASTIC PAVEMENT MARKING - LINE 4"	FOOT	60778	60778				
70300100	SHORT TERM PAVEMENT MARKING	FOOT	23444	23444					* 78000400	THERMOPLASTIC PAVEMENT MARKING - LINE 6"	FOOT	3863	3863				
70300210	TEMPORARY PAVEMENT MARKING LETTERS AND SYMBOLS	SO FT	979	979					* 78000500	THERMOPLASTIC PAVEMENT MARKING - LINE 8"	FOOT	6576	6576				
70300220	TEMPORARY PAVEMENT MARKING - LINE 4"	FOOT	60778	60778					* 78000600	THERMOPLASTIC PAVEMENT MARKING - LINE 12"	FOOT	1721	1721				
70300240	TEMPORARY PAVEMENT MARKING - LINE 6"	FOOT	3863	3863					* 78000650	THERMOPLASTIC PAVEMENT MARKING - LINE 24"	FOOT	576	576				
70300250	TEMPORARY PAVEMENT MARKING - LINE 8"	FOOT	6576	6576					* 78008210	POLYUREA PAVEMENT MARKING TYPE I - LINE 4"	FOOT	292	292				
70300260	TEMPORARY PAVEMENT MARKING - LINE 12"	FOOT	1721	1721					* 78008230	POLYUREA PAVEMENT MARKING TYPE I - LINE 6"	FOOT	292	292				
70300280	TEMPORARY PAVEMENT MARKING - LINE 24"	FOOT	576	576					* 78100100	RAISED REFLECTIVE PAVEMENT MARKER	EACH	891	891				
70301000	WORK ZONE PAVEMENT MARKING REMOVAL	SO FT	2605	2605					78300100	PAVEMENT MARKING REMOVAL	SO FT	244	244				
* 72000100	SIGN PANEL - TYPE 1	SO FT	50.5	50.5					78300200	RAISED REFLECTIVE PAVEMENT MARKER REMOVAL	EACH	713	713				
* 72400100	REMOVE SIGN PANEL ASSEMBLY - TYPE A	EACH	9	9					* 88600600	DETECTOR LOOP REPLACEMENT	FOOT	3075	3075				
* 72400310	REMOVE SIGN PANEL - TYPE 1	SO FT	50.5	50.5					89502378	REBUILD EXISTING HANDHOLE TO HEAVY-DUTY HANDHOLE	EACH	1	1				
* 72900100	METAL POST - TYPE A	FOOT	50	50					X2020110	GRADING AND SHAPING SHOULDERS	UNIT	130	130				

* Specialty Items

Rev 4-8-13

US 6 (159TH)

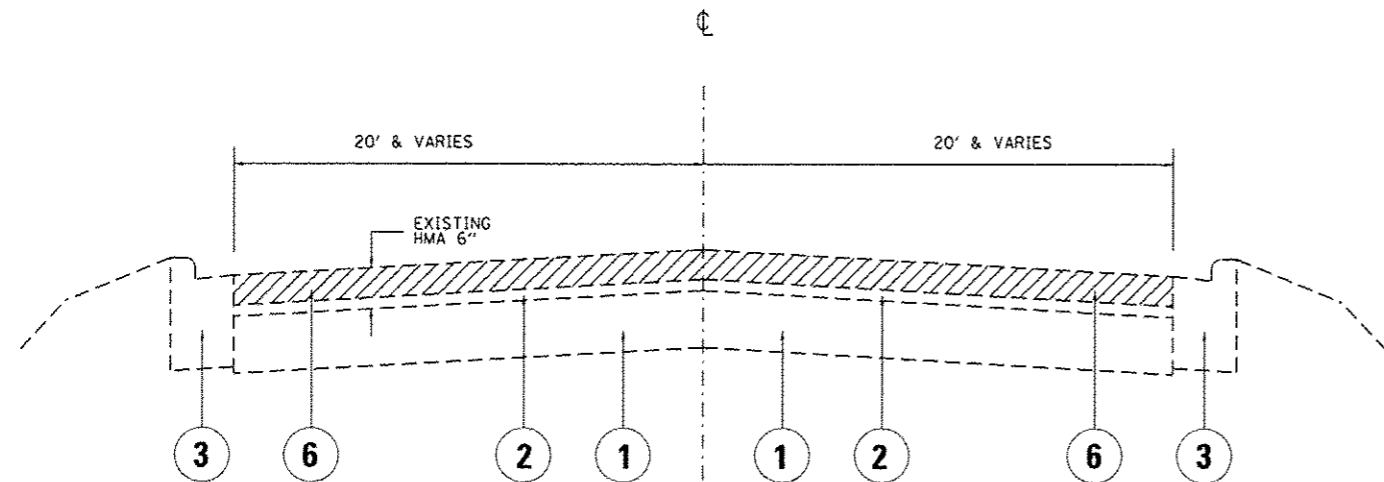

EXIST. TYPICAL SECTION

STA. 11+24 TO STA. 41+45
 STA. 67+00 TO STA. 80+00
 STA. 100+00 TO STA. 152+50

US 6 (159TH)

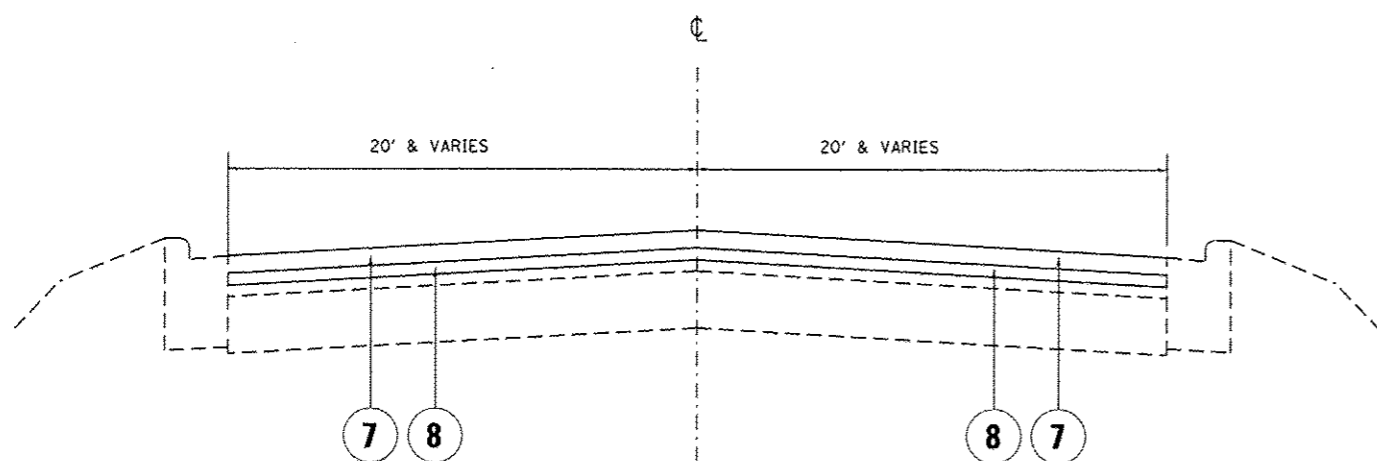

PROP. TYPICAL SECTION

STA. 11+24 TO STA. 41+45
 STA. 67+00 TO STA. 80+00
 STA. 100+00 TO STA. 152+50

LEGEND

- ① EXISTING P.C.C PAVEMENT, ± 9½"
- ② EXISTING H.M.A. SURFACE AFTER MILLING, ± 3½"
- ③ EXISTING COMB. CONCRETE CURB & GUTTER
- ④ EXISTING H.M.A. SHOULDER
- ⑤ EXISTING AGGREGATE SHOULDER
- ⑥ PROPOSED H.M.A. SURFACE REMOVAL, 2½"
- ⑦ PROPOSED POLYMERIZED H.M.A. SURFACE COURSE, MIX "F", N90, 1 ¾"
- ⑧ PROPOSED POLYMERIZED LEVELING BINDER (MACHINE METHOD), IL-4.75, N50, ¾"
- ⑨ PROPOSED AGGREGATE WEDGE SHOULDER, TYPE B
- ⑩ PROPOSED GRADING AND SHAPING SHOULDERS
- ⑪ PROPOSED SAFETY EDGE (SEE DETAIL)
- ⑫ EXISTING CONC. MEDIAN SURFACE 6' WIDE OR GREATER TO BE REMOVED
 *EXIST. PCC MEDIAN SURFACE LESS THAN 6' WIDE TO REMAIN PAVED
- ⑬ EXISTING GRAVEL / GRANULAR MATERIAL TO BE REMOVED (TO BE PAID FOR AS REMOVAL AND DISPOSAL OF UNSUITABLE MATERIAL)
- ⑭ PROPOSED TOPSOIL, FURNISH AND PLACE, VARIABLE DEPTH
 PROPOSED SEEDING, CLASS RA
 PROPOSED EROSION CONTROL BLANKET AND FERTILIZER NUTRIENTS (NITROGEN, PHOSPHORUS, AND POTASSIUM) TO BE APPLIED TO ALL SEEDING AREAS. (SEE PLAN SHEETS FOR LOCATIONS)

HOT-MIX ASPHALT MIXTURE REQUIREMENTS

MIXTURE TYPE	AIR VOIDS @ Ndes
* POLY. HOT-MIX ASPHALT SURFACE COURSE, MIX "F", N90 (IL 9.5 mm)	4% AT 90 GYR.
POLY. LEVELING BINDER (MACHINE METHOD), IL-4.75, N50	3.5% AT 50 GYR.
CLASS D PATCHES (HMA BINDER IL-19 mm)	4% AT 70 GYR.

NOTES:

THE UNIT WEIGHT USED TO CALCULATE ALL HMA SURFACE MIXTURE QUANTITIES IS 112 LBS/SQ YD/IN.

THE "AC TYPE" FOR POLYMERIZED HMA MIXES SHALL BE "SBS/SBR PG 76-22" AND FOR NON-POLYMERIZED HMA THE "AC TYPE" SHALL BE "PG 64-22" UNLESS MODIFIED BY DISTRICT ONE SPECIAL PROVISIONS. FOR USE OF RECYCLED MATERIALS SEE SPECIAL PROVISIONS.

* HOT-MIX ASPHALT - PAY FOR PERFORMANCE USING PERCENT WITHIN LIMITS - PLANT SAMPLING (BMPR) SHALL ONLY APPLY TO POLYMERIZED HMA SURFACE COURSE SMA, N80"

THE CONTRACTOR SHALL MILL THE ROADWAY FIRST THEN DO PAVEMENT PATCHING PER BD-22 DETAIL

US 6 (159TH)
 Ⓞ

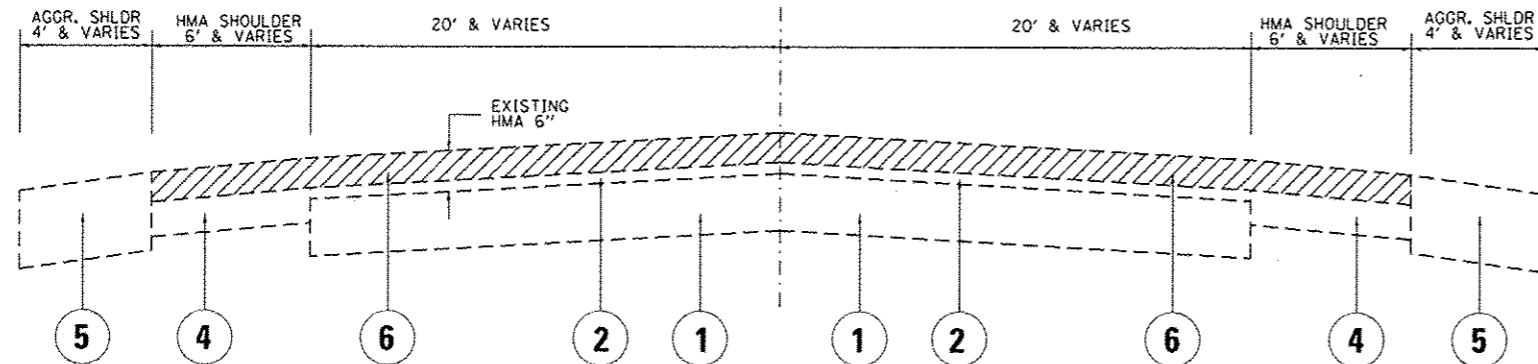

EXIST. TYPICAL SECTION

STA. 41+45 TO STA. 67+00
 STA. 80+00 TO STA. 100+00
 STA. 152+50 TO STA. 182+83

US 6 (159TH)
 Ⓞ

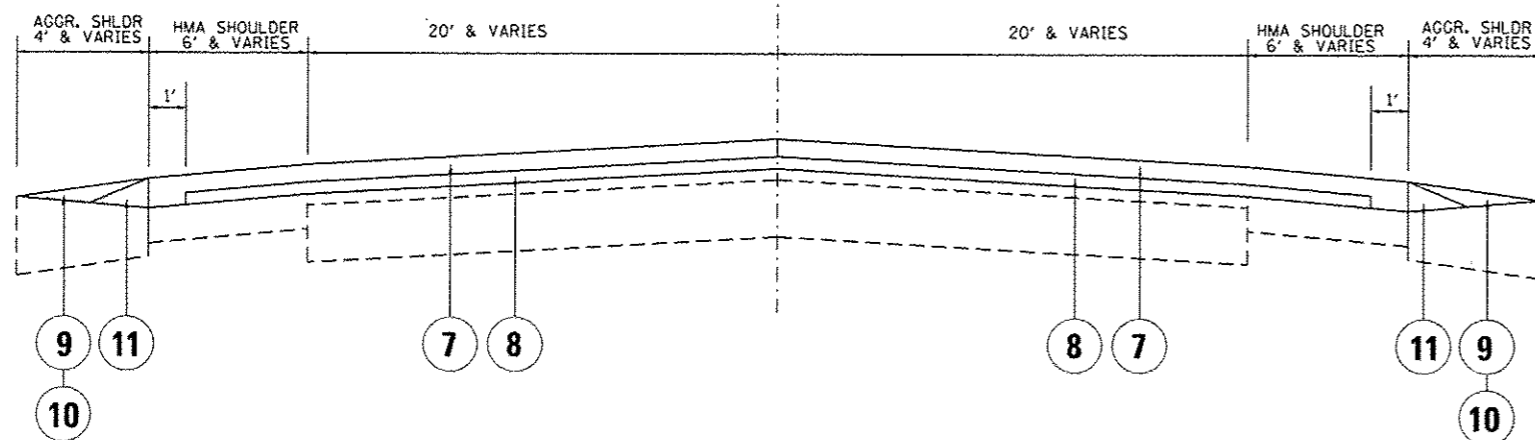

PROP. TYPICAL SECTION

STA. 41+45 TO STA. 67+00
 STA. 80+00 TO STA. 100+00
 STA. 152+50 TO STA. 182+83

LEGEND

- ① EXISTING P.C.C. PAVEMENT, ± 9/2"
- ② EXISTING H.M.A. SURFACE AFTER MILLING, ± 3/2"
- ③ EXISTING COMB. CONCRETE CURB & GUTTER
- ④ EXISTING H.M.A. SHOULDER
- ⑤ EXISTING AGGREGATE SHOULDER
- ⑥ PROPOSED H.M.A. SURFACE REMOVAL, 2 1/2"
- ⑦ PROPOSED POLYMERIZED H.M.A. SURFACE COURSE, MIX "F", NS0, 1 3/4"
- ⑧ PROPOSED POLYMERIZED LEVELING BINDER (MACHINE METHOD), IL-4.75, NS0, 3/4"
- ⑨ PROPOSED AGGREGATE WEDGE SHOULDER, TYPE B
- ⑩ PROPOSED GRADING AND SHAPING SHOULDERS
- ⑪ PROPOSED SAFETY EDGE (SEE DETAIL)
- ⑫ EXISTING CONC. MEDIAN SURFACE 6' WIDE OR GREATER TO BE REMOVED
 *EXIST. PCC MEDIAN SURFACE LESS THAN 6' WIDE TO REMAIN PAVED
- ⑬ EXISTING GRAVEL / GRANULAR MATERIAL TO BE REMOVED (TO BE PAID FOR AS REMOVAL AND DISPOSAL OF UNSUITABLE MATERIAL)
- ⑭ PROPOSED TOPSOIL, FURNISH AND PLACE, VARIABLE DEPTH
 PROPOSED SEEDING, CLASS RA
 PROPOSED EROSION CONTROL BLANKET AND FERTILIZER NUTRIENTS (NITROGEN, PHOSPHORUS, AND POTASSIUM) TO BE APPLIED TO ALL SEEDING AREAS. (SEE PLAN SHEETS FOR LOCATIONS)

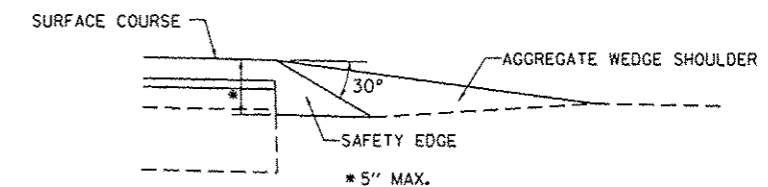

SAFETY EDGE DETAIL

SAFETY EDGE TREATMENT SHALL BE APPLIED TO PAVED SHOULDER OF 1 FOOT OR LESS THAT IS ADJACENT TO AGGREGATE / EARTH SHOULDER

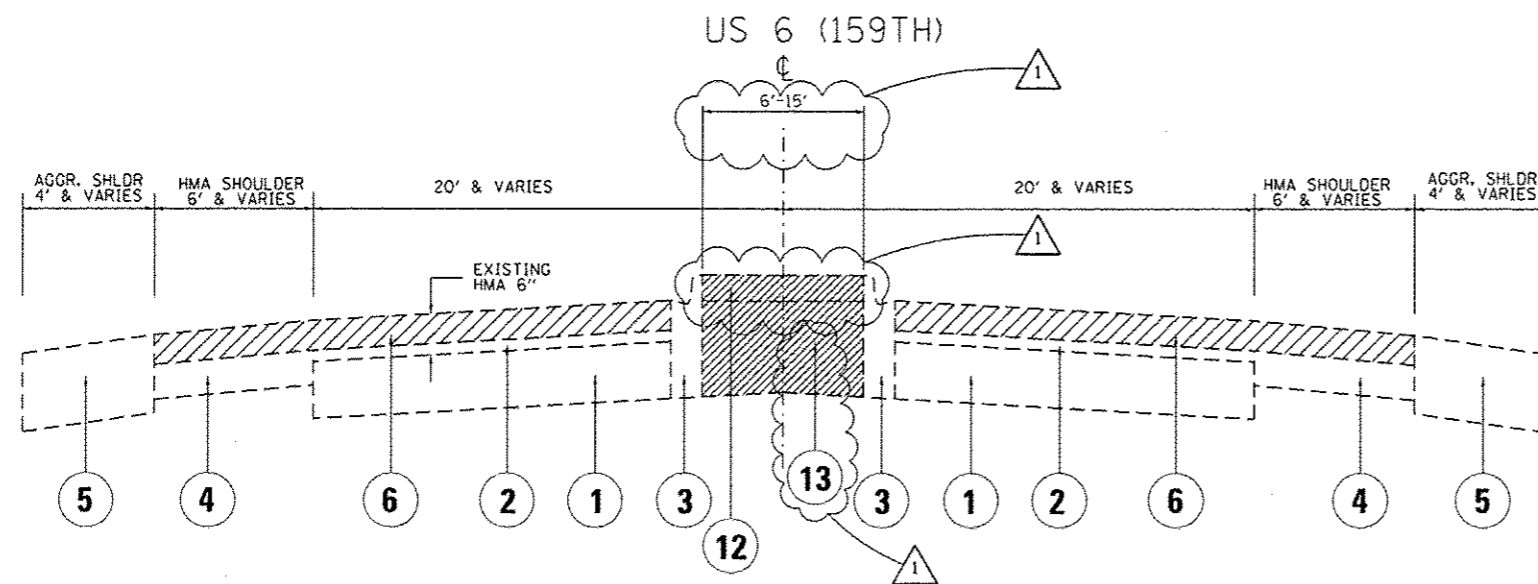

EXIST. TYPICAL SECTION

STA. 41+45 TO STA. 67+00
 STA. 80+00 TO STA. 100+00
 STA. 152+50 TO STA. 182+83

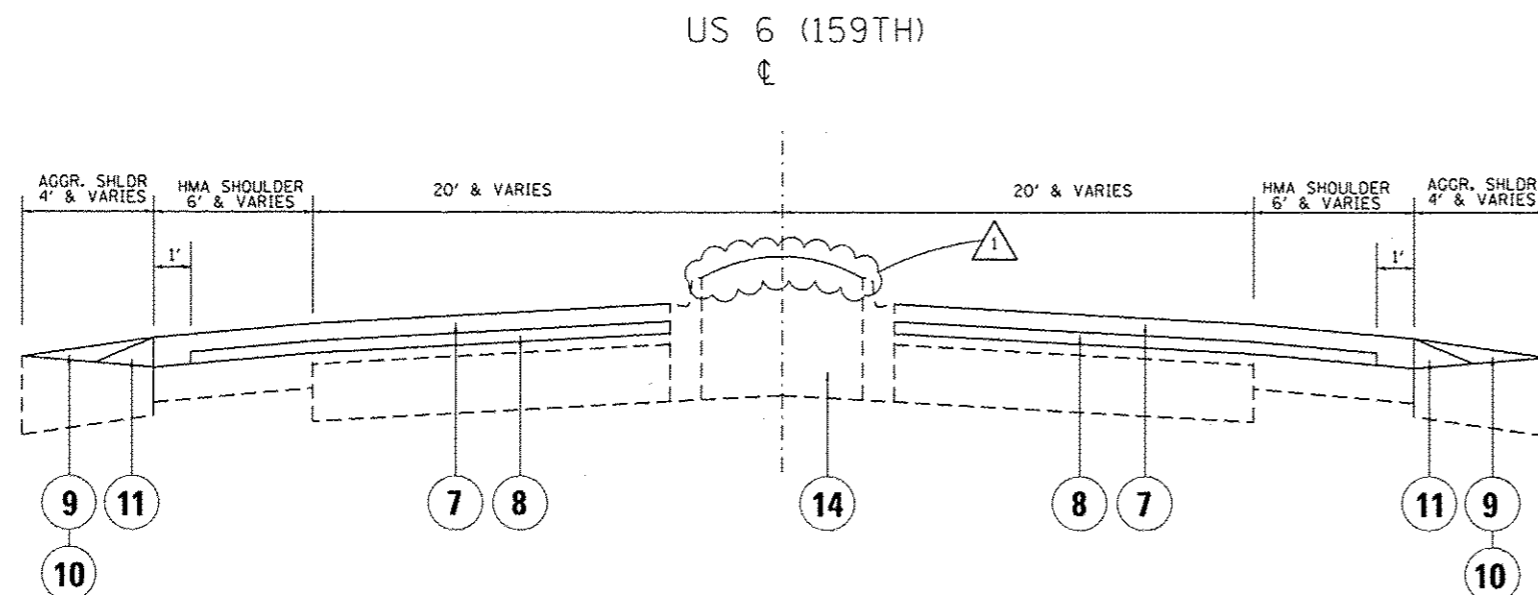

PROP. TYPICAL SECTION

STA. 41+45 TO STA. 67+00
 STA. 80+00 TO STA. 100+00
 STA. 152+50 TO STA. 182+83

LEGEND

- ① EXISTING P.C.C. PAVEMENT, ± 9 1/2"
- ② EXISTING H.M.A. SURFACE AFTER MILLING, ± 3 1/2"
- ③ EXISTING COMB. CONCRETE CURB & GUTTER
- ④ EXISTING H.M.A. SHOULDER
- ⑤ EXISTING AGGREGATE SHOULDER
- ⑥ PROPOSED H.M.A. SURFACE REMOVAL, 2 1/2"
- ⑦ PROPOSED POLYMERIZED H.M.A. SURFACE COURSE, MIX "F", N90, 1 3/4"
- ⑧ PROPOSED POLYMERIZED LEVELING BINDER (MACHINE METHOD), IL-4.75, N50, 3/4"
- ⑨ PROPOSED AGGREGATE WEDGE SHOULDER, TYPE B
- ⑩ PROPOSED GRADING AND SHAPING SHOULDERS
- ⑪ PROPOSED SAFETY EDGE (SEE DETAIL)
- ⑫ EXISTING CONC. MEDIAN SURFACE 6' WIDE OR GREATER TO BE REMOVED
 *EXIST. PCC MEDIAN SURFACE LESS THAN 6' WIDE TO REMAIN PAVED
- ⑬ EXISTING GRAVEL / GRANULAR MATERIAL TO BE REMOVED (TO BE PAID FOR AS REMOVAL AND DISPOSAL OF UNSUITABLE MATERIAL)
- ⑭ PROPOSED TOPSOIL, FURNISH AND PLACE, VARIABLE DEPTH
 PROPOSED SEEDING, CLASS 2A
 PROPOSED EROSION CONTROL BLANKET AND FERTILIZER NUTRIENTS (NITROGEN, PHOSPHORUS, AND POTASSIUM) TO BE APPLIED TO ALL SEEDING AREAS. (SEE PLAN SHEETS FOR LOCATIONS)

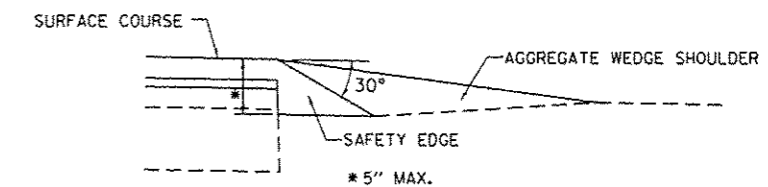

SAFETY EDGE DETAIL

SAFETY EDGE TREATMENT SHALL BE APPLIED TO PAVED SHOULDER OF 1 FOOT OR LESS THAT IS ADJACENT TO AGGREGATE / EARTH SHOULDER

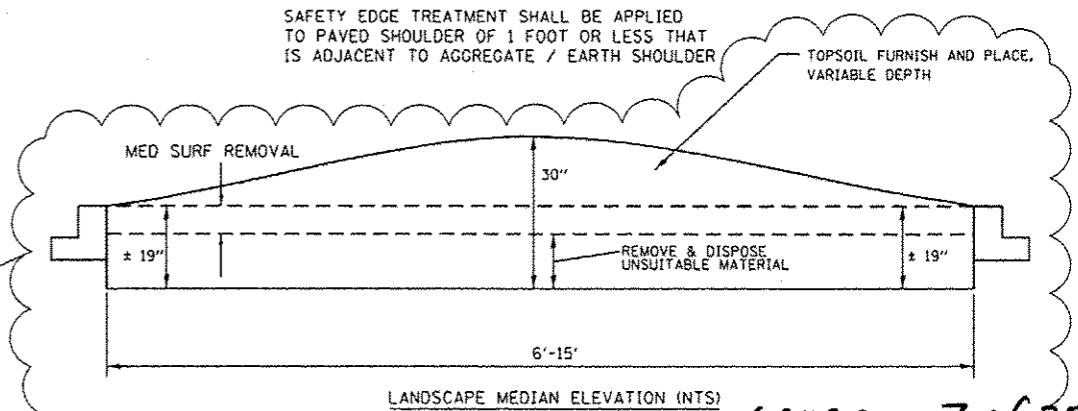

LANDSCAPE MEDIAN ELEVATION (NTS)

- ① PROP. 8' WHITE THERMO. PVT. MRK. LETTERS AND SYMBOLS (TYP.)
- ② PROP. THERMO. PVT. MRK.-4" CENTER LINE, SINGLE YELLOW (TYP.)
- ③ PROP. THERMO. PVT. MRK.-4" CENTER LINE, DOUBLE YELLOW (TYP.)
- ④ PROP. THERMO. PVT. MRK.-4" EDGE LINE, SOLID WHITE (TYP.)
- ⑤ PROP. THERMO. PVT. MRK.-4" SKIP-DASH, SINGLE WHITE (TYP.)
- ⑥ PROP. THERMO. PVT. MRK.-6" SOLID LINE, WHITE (TYP.)
- ⑦ PROP. THERMO. PVT. MRK.-6" DOTTED LINE, WHITE (TYP.)
- ⑧ PROP. THERMO. PVT. MRK.-6" PEDESTRIAN, 2x 6"; SOLID WHITE (TYP.)
- ⑨ PROP. THERMO. PVT. MRK.-8" GORE MARKING, SOLID WHITE (TYP.)
- ⑩ PROP. THERMO. PVT. MRK.-12" DIAGONAL, YELLOW, SPACED 75' C-C (TYP.)
- ⑪ PROP. THERMO. PVT. MRK.-12" GORE MARKING CHEVRON, WHITE (TYP.)
- ⑫ PROP. THERMO. PVT. MRK.-24" STOP LINE, WHITE (TYP.)
- ⑬ PROP. POLYUREA PVT. MRK - 4" SKIP-DASH, SINGLE WHITE (TYP.)
- ⑭ PROP. POLYUREA PVT. MRK - 6" DOTTED LINE, WHITE (TYP.)

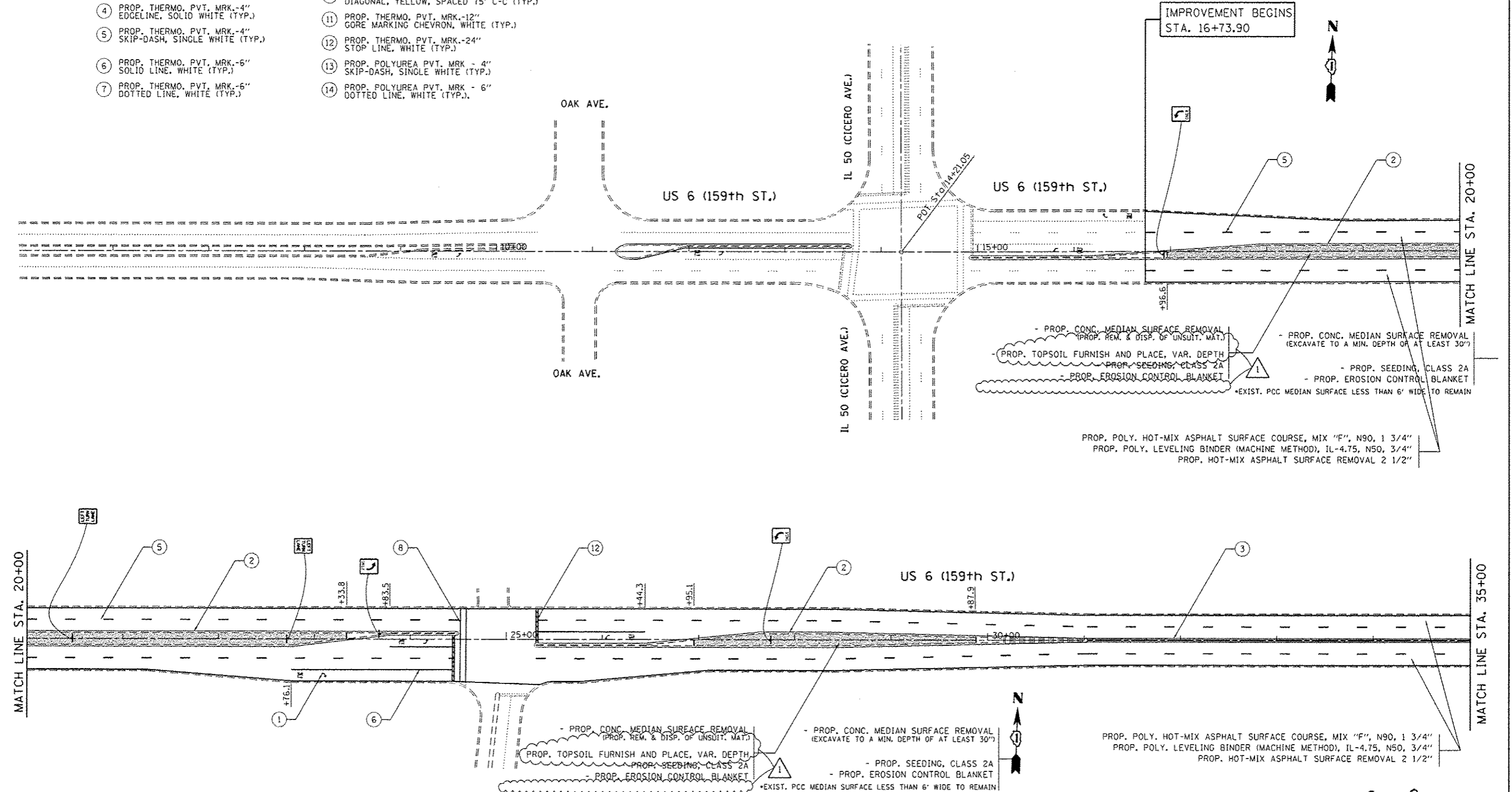

PROP. POLY. HOT-MIX ASPHALT SURFACE COURSE, MIX "F", N90, 1 3/4"
 PROP. POLY. LEVELING BINDER (MACHINE METHOD), IL-4.75, N50, 3/4"
 PROP. HOT-MIX ASPHALT SURFACE REMOVAL 2 1/2"

PROP. POLY. HOT-MIX ASPHALT SURFACE COURSE, MIX "F", N90, 1 3/4"
 PROP. POLY. LEVELING BINDER (MACHINE METHOD), IL-4.75, N50, 3/4"
 PROP. HOT-MIX ASPHALT SURFACE REMOVAL 2 1/2"

60K98 8 of 32

FILE NAME =	USER NAME = marozkmo	DESIGNED -	REVISED -
c:\pwork\p1das\marozkmo\10207900\0	22610-sht-plan.dgn		3-29-13
PLOT SCALE = 100.0000' / 1"	CHECKED -	REVISIONS	
PLOT DATE = 3/27/2013	DATE -		

STATE OF ILLINOIS
DEPARTMENT OF TRANSPORTATION

US 6 (159TH ST.)	
IL 50 (CICERO AVE.) TO I-294 (TRI-STATE TOLLWAY)	
SCALE:	SHEET NO. OF SHEETS STA. TO STA.

F.A.P. RTE.	SECTION	COUNTY	TOTAL SHEETS	SHEET NO.
351	3277 RS-4	COOK	32	8
CONTRACT NO. 60K98				
(ILLINOIS) FED. AID PROJECT				

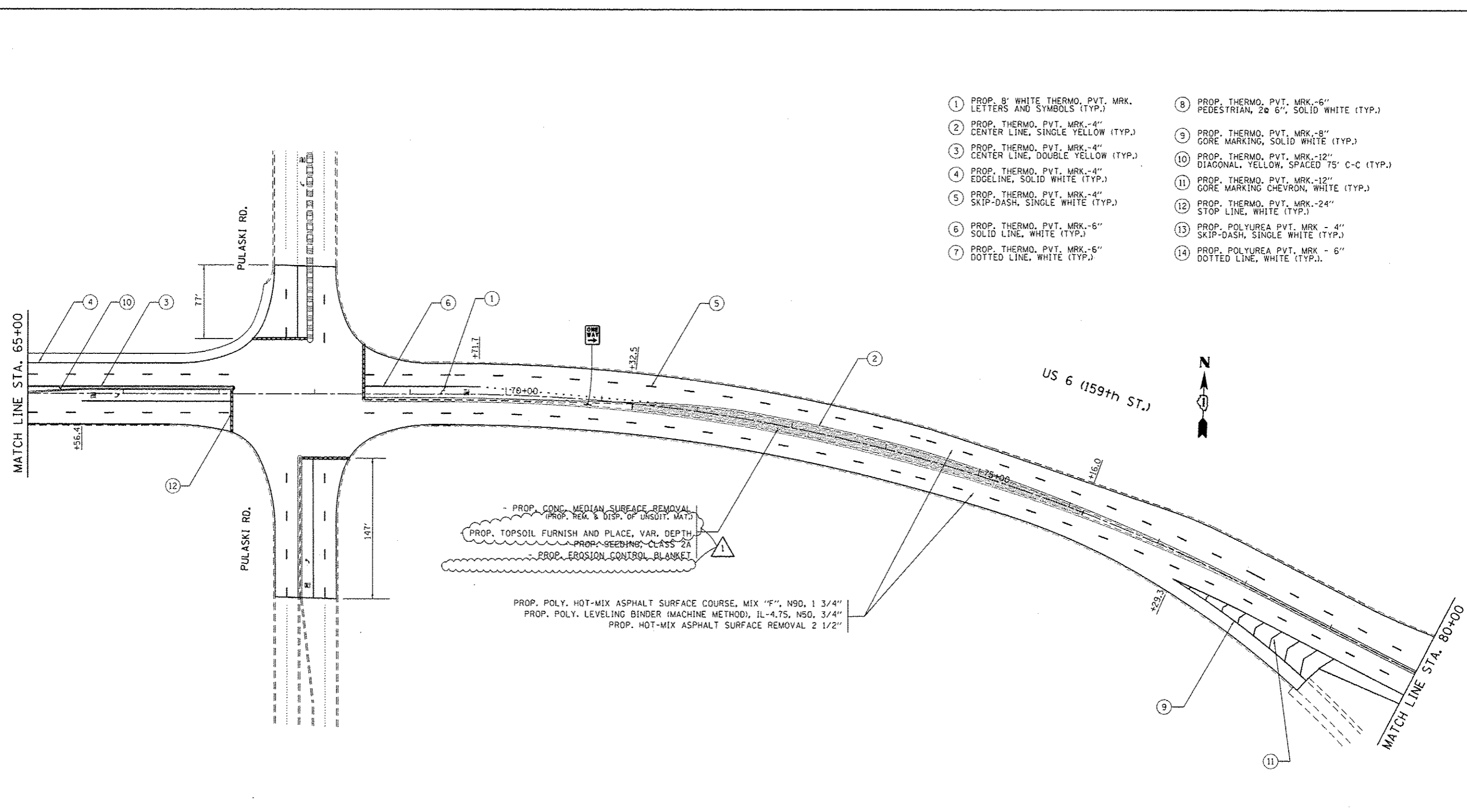

- ① PROP. 8" WHITE THERMO. PVT. MRK. LETTERS AND SYMBOLS (TYP.)
- ② PROP. THERMO. PVT. MRK.-4" CENTER LINE, SINGLE YELLOW (TYP.)
- ③ PROP. THERMO. PVT. MRK.-4" CENTER LINE, DOUBLE YELLOW (TYP.)
- ④ PROP. THERMO. PVT. MRK.-4" EDGELINE, SOLID WHITE (TYP.)
- ⑤ PROP. THERMO. PVT. MRK.-4" SKIP-DASH, SINGLE WHITE (TYP.)
- ⑥ PROP. THERMO. PVT. MRK.-6" SOLID LINE, WHITE (TYP.)
- ⑦ PROP. THERMO. PVT. MRK.-6" DOTTED LINE, WHITE (TYP.)
- ⑧ PROP. THERMO. PVT. MRK.-6" PEDESTRIAN, 2@ 6", SOLID WHITE (TYP.)
- ⑨ PROP. THERMO. PVT. MRK.-8" GORE MARKING, SOLID WHITE (TYP.)
- ⑩ PROP. THERMO. PVT. MRK.-12" DIAGONAL, YELLOW, SPACED 75' C-C (TYP.)
- ⑪ PROP. THERMO. PVT. MRK.-12" GORE MARKING CHEVRON, WHITE (TYP.)
- ⑫ PROP. THERMO. PVT. MRK.-24" STOP LINE, WHITE (TYP.)
- ⑬ PROP. POLYUREA PVT. MRK - 4" SKIP-DASH, SINGLE WHITE (TYP.)
- ⑭ PROP. POLYUREA PVT. MRK - 6" DOTTED LINE, WHITE (TYP.)

- PROP. CONC. MEDIAN SURFACE REMOVAL
 (PROP. REM. & DISP. OF UNSUIT. MAT.)
 PROP. TOPSOIL FURNISH AND PLACE, VAR. DEPTH
 PROP. SEEDING, CLASS 2A
 - PROP. EROSION CONTROL BLANKET

PROP. POLY. HOT-MIX ASPHALT SURFACE COURSE, MIX "F", N90, 1 3/4"
 PROP. POLY. LEVELING BINDER (MACHINE METHOD), IL-4.75, N50, 3/4"
 PROP. HOT-MIX ASPHALT SURFACE REMOVAL 2 1/2"

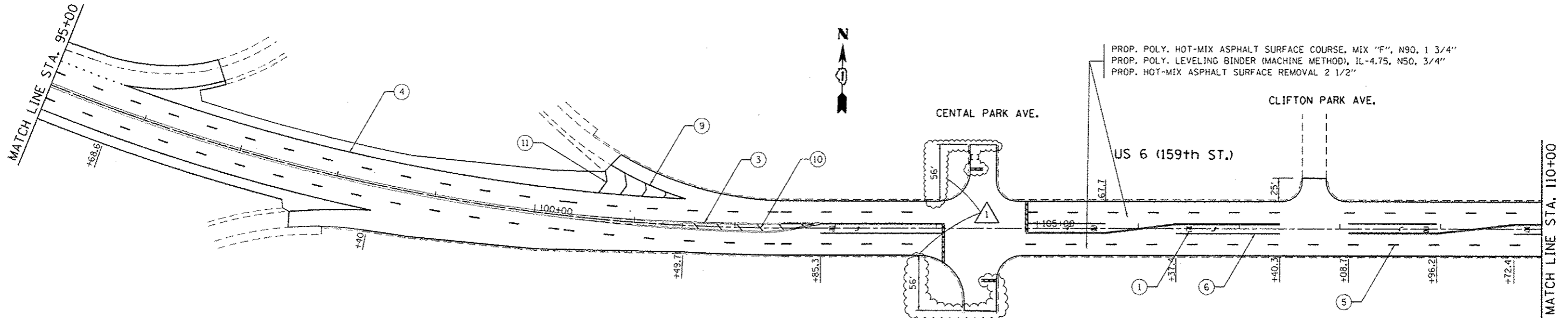

- | | |
|----------------------------------------------------------------|-----------------------------------------------------------------------|
| ① PROP. 8" WHITE THERMO. PVT. MRK. LETTERS AND SYMBOLS (TYP.) | ⑧ PROP. THERMO. PVT. MRK.-6" PEDESTRIAN, 2 @ 6"; SOLID WHITE (TYP.) |
| ② PROP. THERMO. PVT. MRK.-4" CENTER LINE, SINGLE YELLOW (TYP.) | ⑨ PROP. THERMO. PVT. MRK.-8" GORE MARKING, SOLID WHITE (TYP.) |
| ③ PROP. THERMO. PVT. MRK.-4" CENTER LINE, DOUBLE YELLOW (TYP.) | ⑩ PROP. THERMO. PVT. MRK.-12" DIAGONAL, YELLOW, SPACED 75' C-C (TYP.) |
| ④ PROP. THERMO. PVT. MRK.-4" EDGE LINE, SOLID WHITE (TYP.) | ⑪ PROP. THERMO. PVT. MRK.-12" GORE MARKING CHEVRON, WHITE (TYP.) |
| ⑤ PROP. THERMO. PVT. MRK.-4" SKIP-DASH, SINGLE WHITE (TYP.) | ⑫ PROP. THERMO. PVT. MRK.-24" STOP LINE, WHITE (TYP.) |
| ⑥ PROP. THERMO. PVT. MRK.-6" SOLID LINE, WHITE (TYP.) | ⑬ PROP. POLYUREA PVT. MRK - 4" SKIP-DASH, SINGLE WHITE (TYP.) |
| ⑦ PROP. THERMO. PVT. MRK.-6" DOTTED LINE, WHITE (TYP.) | ⑭ PROP. POLYUREA PVT. MRK - 6" DOTTED LINE, WHITE (TYP.) |

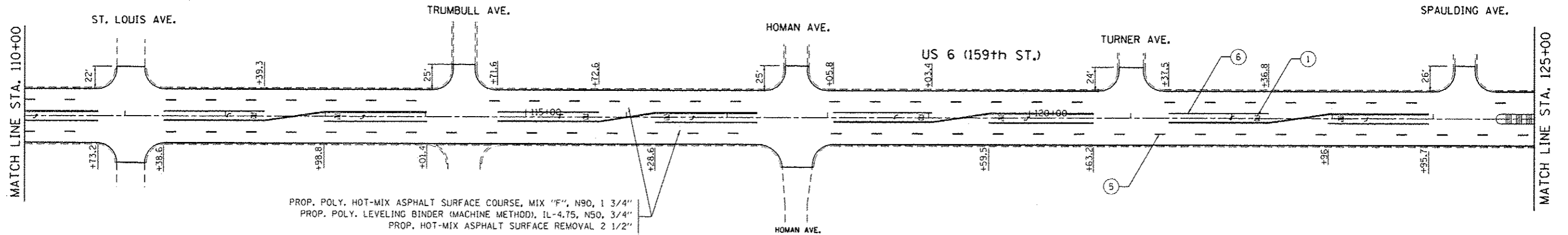

PROP. POLY. HOT-MIX ASPHALT SURFACE COURSE, MIX "F", N90, 1 3/4"
 PROP. POLY. LEVELING BINDER (MACHINE METHOD), IL-4.75, N50, 3/4"
 PROP. HOT-MIX ASPHALT SURFACE REMOVAL 2 1/2"

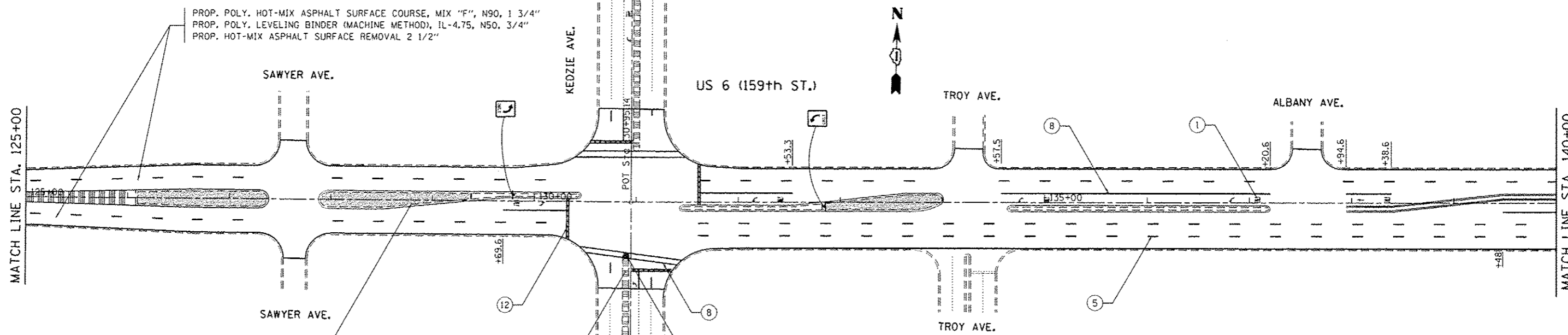

PROP. POLY. HOT-MIX ASPHALT SURFACE COURSE, MIX "F", N90, 1 3/4"
 PROP. POLY. LEVELING BINDER (MACHINE METHOD), IL-4.75, N50, 3/4"
 PROP. HOT-MIX ASPHALT SURFACE REMOVAL 2 1/2"

- PROP. CONC. MEDIAN SURFACE REMOVAL
 (PROP. REM. & DISP. OF UNSUIT. MAT.)
 PROP. TOPSOIL FURNISH AND PLACE, VAR. DEPTH
 PROP. SEEDING, CLASS 2A
 PROP. EROSION CONTROL BLANKET

EXIST. PCC CORR. MEDIAN
 (TO REMAIN IN PLACE)

EXIST. MEDIAN REMOVAL PARTIAL DEPTH
 (MILL TO MATCH ADJACENT MILLED SURFACE)
 EXISTING HANDHOLE TO BE REBUILT
 TO HEAVY DUTY HANDHOLE

- ① PROP. 8' WHITE THERMO. PVT. MRK. LETTERS AND SYMBOLS (TYP.)
- ② PROP. THERMO. PVT. MRK.-4" CENTER LINE, SINGLE YELLOW (TYP.)
- ③ PROP. THERMO. PVT. MRK.-4" CENTER LINE, DOUBLE YELLOW (TYP.)
- ④ PROP. THERMO. PVT. MRK.-4" EDGELINE, SOLID WHITE (TYP.)
- ⑤ PROP. THERMO. PVT. MRK.-4" SKIP-DASH, SINGLE WHITE (TYP.)
- ⑥ PROP. THERMO. PVT. MRK.-6" SOLID LINE, WHITE (TYP.)
- ⑦ PROP. THERMO. PVT. MRK.-5" DOTTED LINE, WHITE (TYP.)
- ⑧ PROP. THERMO. PVT. MRK.-6" PEDESTRIAN, 2@ 6", SOLID WHITE (TYP.)
- ⑨ PROP. THERMO. PVT. MRK.-8" CORE MARKING, SOLID WHITE (TYP.)
- ⑩ PROP. THERMO. PVT. MRK.-12" DIAGONAL, YELLOW, SPACED 75' C-C (TYP.)
- ⑪ PROP. THERMO. PVT. MRK.-12" CORE MARKING CHEVRON, WHITE (TYP.)
- ⑫ PROP. THERMO. PVT. MRK.-24" STOP LINE, WHITE (TYP.)
- ⑬ PROP. POLYUREA PVT. MRK - 4" SKIP-DASH, SINGLE WHITE (TYP.)
- ⑭ PROP. POLYUREA PVT. MRK - 6" DOTTED LINE, WHITE (TYP.)

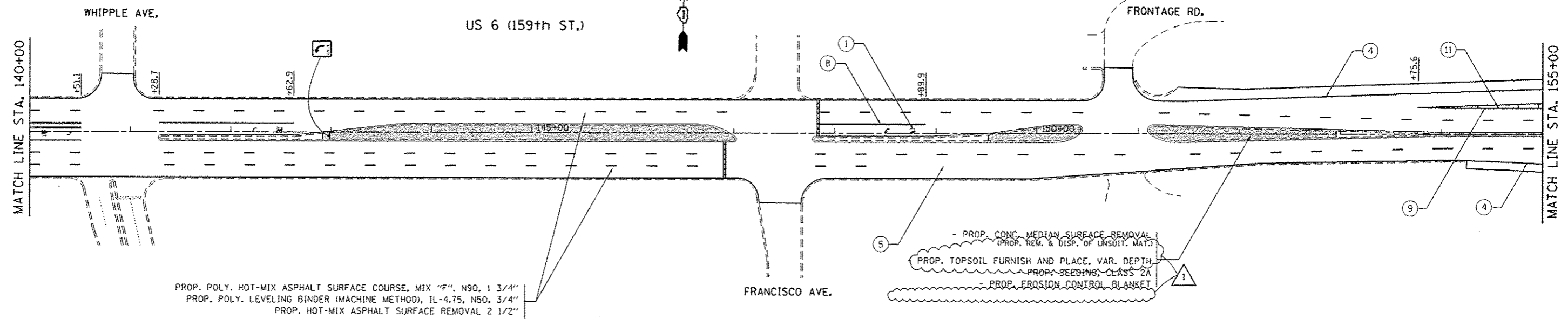

PROP. POLY. HOT-MIX ASPHALT SURFACE COURSE, MIX "F", N90, 1 3/4"
 PROP. POLY. LEVELING BINDER (MACHINE METHOD), IL-4.75, N50, 3/4"
 PROP. HOT-MIX ASPHALT SURFACE REMOVAL 2 1/2"

- PROP. CONC. MEDIAN SURFACE REMOVAL
 (PROP. REM. & DISP. OF UNSUIT. MAT.)
 PROP. TOPSOIL FURNISH AND PLACE, VAR. DEPTH
 PROP. SEEDING, CLASS 2A
 PROP. EROSION CONTROL BLANKET