

QUANTITY
 4 (100) LINE = 64.1 ft. (19.7 m)
 21.1 sq. ft. (1.97 sq. m)

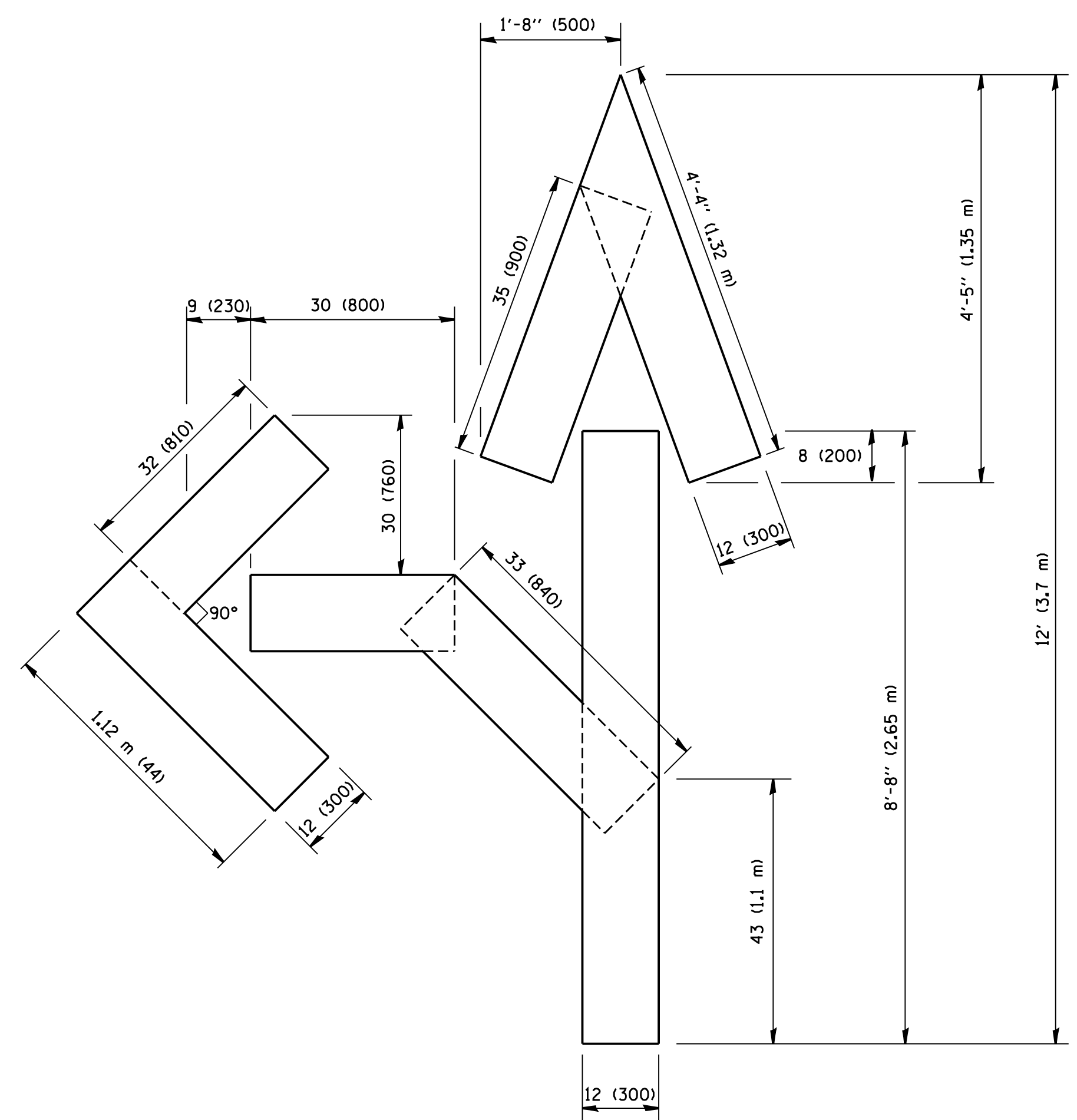

QUANTITY
 4 (100) LINE = 82.5 ft. (25.3 m)
 27.5 sq. ft. (2.53 sq. m)

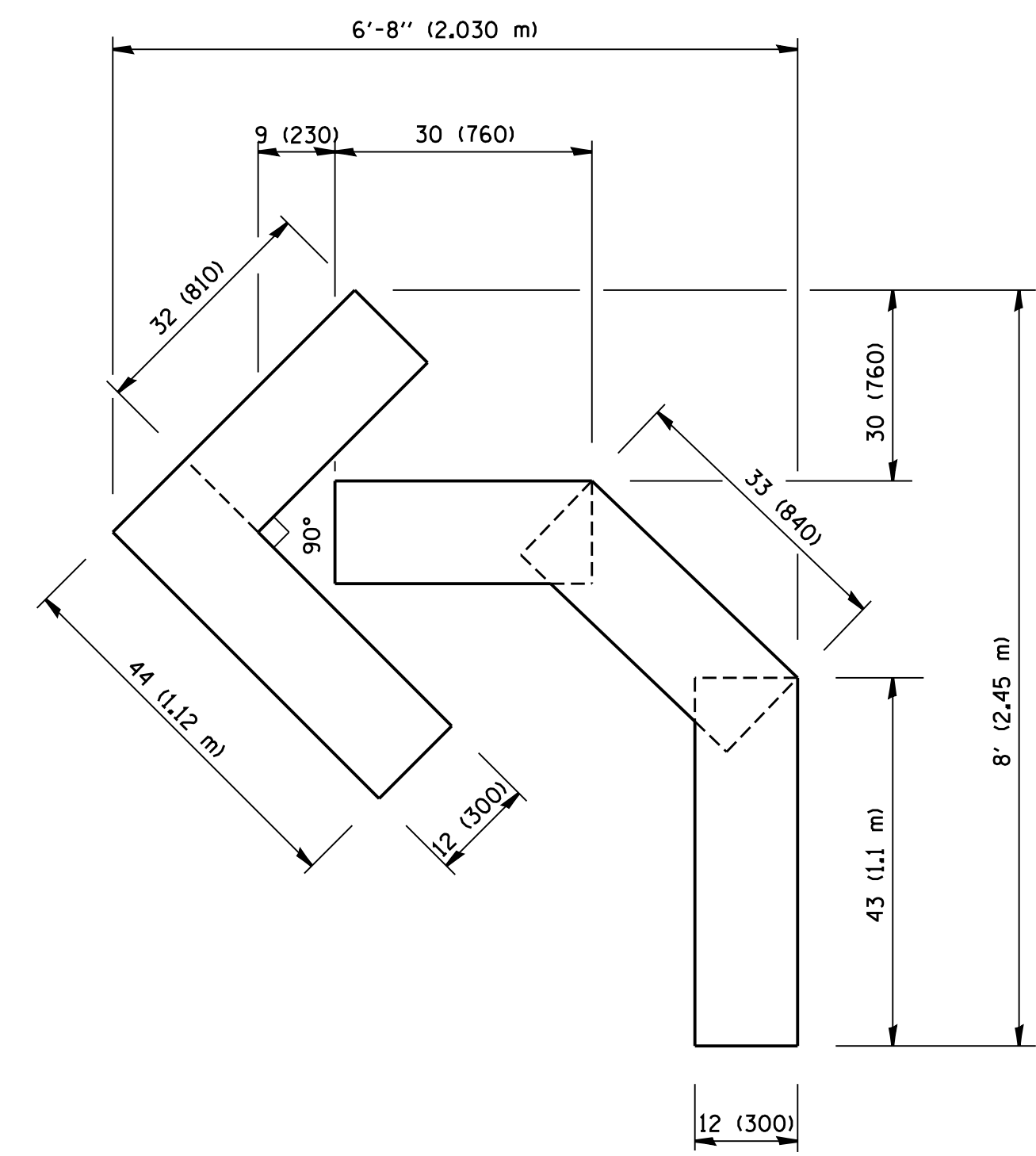

QUANTITY
 4 (100) LINE = 45.5 ft. (13.9 m)
 15.2 sq. ft. (1.39 sq. m)

All dimensions are in inches (millimeters) unless otherwise shown.

| | | | |
|--|-----------------------------|-----------------|--------------------------------|
| FILE NAME = W:\diststd\22x34\tbl6.dgn | USER NAME = gaglionobt | DESIGNED - | REVISED -T. RAMMACHER 06-05-96 |
| | | DRAWN - | REVISED -T. RAMMACHER 11-04-97 |
| | PLOT SCALE = 50.0000' / IN. | CHECKED - | REVISED -T. RAMMACHER 03-02-98 |
| | PLOT DATE = 1/4/2008 | DATE - 09-18-94 | REVISED -E. GOMEZ 08-28-00 |

**STATE OF ILLINOIS
 DEPARTMENT OF TRANSPORTATION**

| PAVEMENT MARKING LETTERS AND SYMBOLS FOR TRAFFIC STAGING | | | |
|---|-------------------------|------|---------|
| SCALE: NONE | SHEET NO. 1 OF 1 SHEETS | STA. | TO STA. |

| F.A. RTE. | SECTION | COUNTY | TOTAL SHEETS | SHEET NO. |
|---|---------|--------|--------------------|-----------|
| 872 | 41-RS-4 | LAKE | 22 | 19 |
| TC-16 | | | CONTRACT NO. 60N29 | |
| FED. ROAD DIST. NO. 1 ILLINOIS FED. AID PROJECT | | | | |