

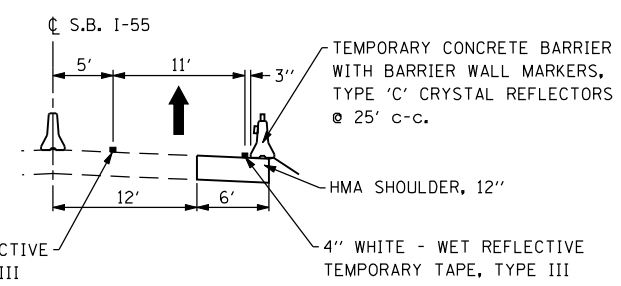

ARSENAL ROAD

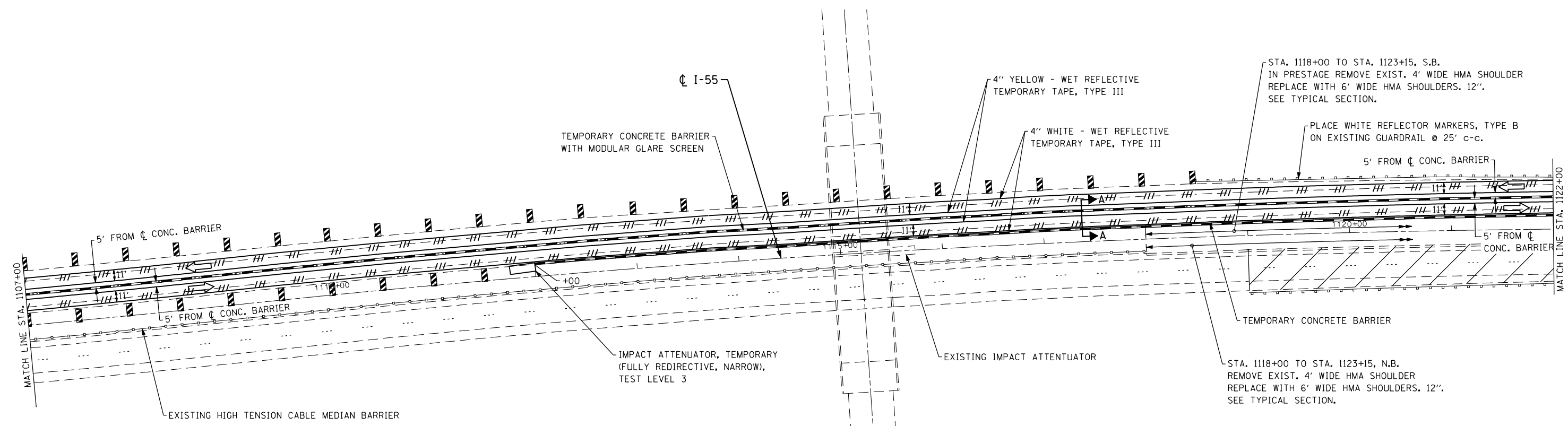

LEGEND

- WORK AREA
- ARROW BOARD
- TRAFFIC LANE
- TEMPORARY CONCRETE BARRIER
- TYPE III BARRICADES WITH FLASHING LIGHTS
- VERTICAL PANELS @ 50' c-c. UNLESS OTHERWISE SHOWN
- TEMPORARY SIGN
- DRUMS @ 50' c-c. WITH STEADY-BURN MONO-DIRECTIONAL LIGHTS
- TYPE II BARRICADES WITH STEADY-BURN MONO-DIRECTIONAL LIGHTS
- DIRECTIONAL INDICATOR BARRIER
- PAVEMENT MARKING REMOVAL

FILE NAME = D160R62-stage1-04.dgn
 USER NAME = IDOT
 PLOT SCALE = 100.0000' / IN.
 PLOT DATE = 1/18/2013

CHRISTIAN-ROGE & ASSOCIATES, INC.
 ENGINEERS-PLANNERS-SURVEYORS
 211 WEST WACKER DRIVE
 CHICAGO, ILLINOIS 60606
 PHONE: (312)372-2023 FAX: (312)372-8274

DESIGNED - S.J.P.	REVISED -
DRAWN - B.K.	REVISED -
CHECKED - M.P.	REVISED -
DATE - JANUARY 17, 2013	REVISED -

**STATE OF ILLINOIS
 DEPARTMENT OF TRANSPORTATION**

**SUGGESTED TRAFFIC CONTROL AND PROTECTION
 I-55 STAGE I**

SCALE: 1" = 50' SHEET NO. 4 OF 9 SHEETS STA. 1107+00 TO STA. 1122+00

F.A.I. RTE.	SECTION	COUNTY	TOTAL SHEETS	SHEET NO.
55	87B, D-BR-1	WILL	106	19
CONTRACT NO. 60R62				
FED. ROAD DIST. NO. 1 ILLINOIS FED. AID PROJECT				