

Proposed Rehabilitation LOCATION SKETCH

SCOPE OF WORK

- 1. Expansion Joint Repairs

DESIGN SPECIFICATIONS
2002 AASHTO Standard Specifications for Highway Bridges (17th Edition)

LOADING HS20-44

LEGEND

- Joint Repair Area
- Scope of Work

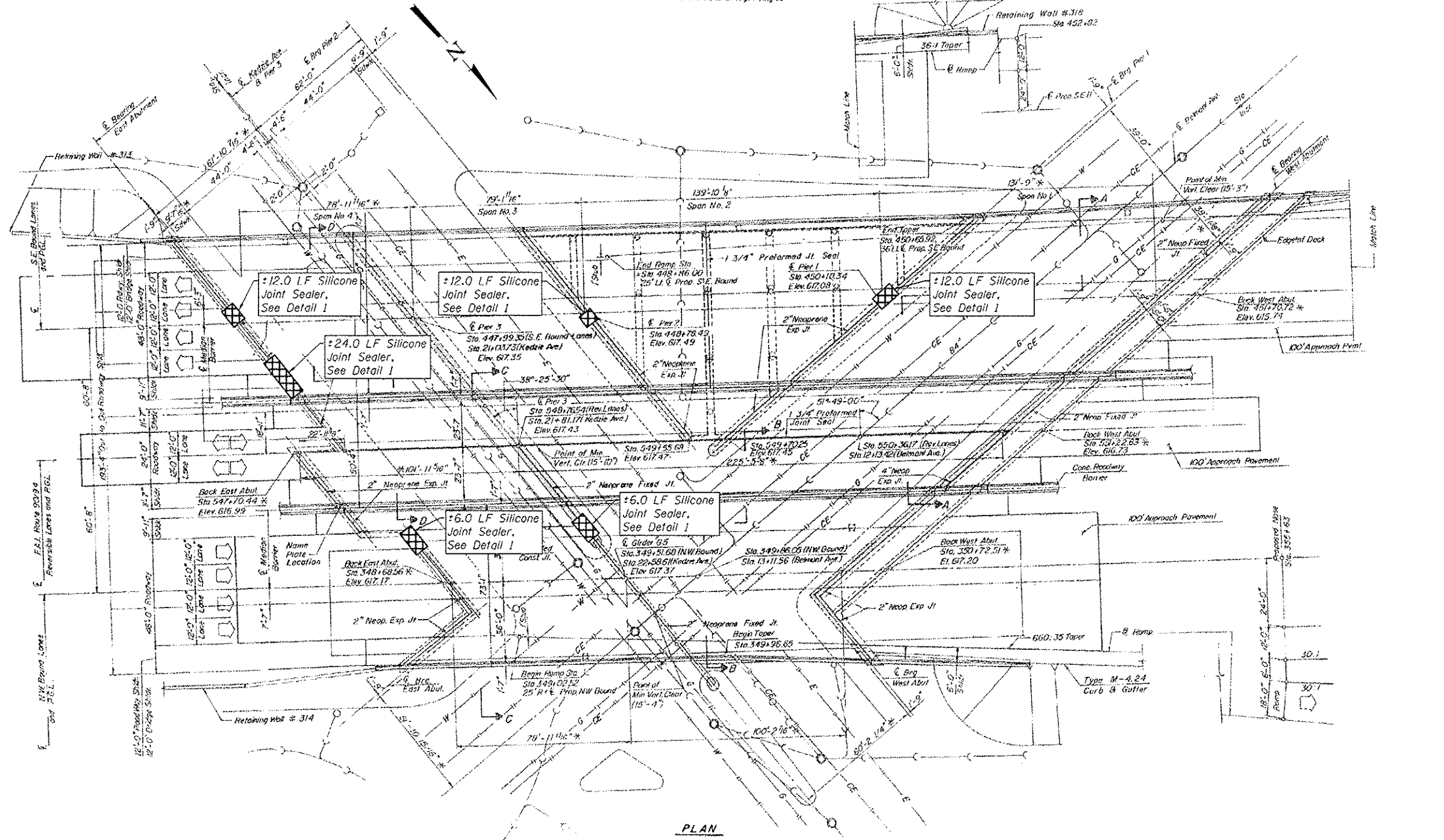

PLAN

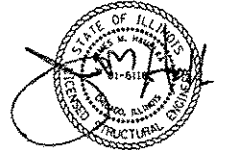

COLLINS ENGINEERS, INC.
JAMES M. HAMELKA
NO. 81-6116
EXPIRES 11-30-2014



USER NAME :	DESIGNED - AMS	REVISED -
PLOT SCALE :	DRAWN - AMS	REVISED -
PLOT DATE :	CHECKED - JMH	REVISED -
	DATE - DECEMBER 2012	REVISED -

STATE OF ILLINOIS
DEPARTMENT OF TRANSPORTATION

GENERAL PLAN AND ELEVATION
I-90/4 OVER KEDZIE & BELMONT SN 016-0121 & 016-0122
SHEET NO. 51 OF 52 SHEETS

F.A.T. RTE. 90/94	SECTION 2012-055BR	COUNTY COOK	TOTAL SHEETS 107	SHEET NO. 37
CONTRACT NO. 60V58			ILLINOIS FED. AID PROJECT	