

SCOPE OF WORK
I. Expansion Joint Repairs

DESIGN SPECIFICATIONS
2002 AASHTO Standard Specifications for Highway Bridges (17th Edition)

LOADING HS20-44

LEGEND

- Joint Repair Area
- ±10.0 LF Scope of Work

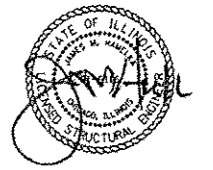
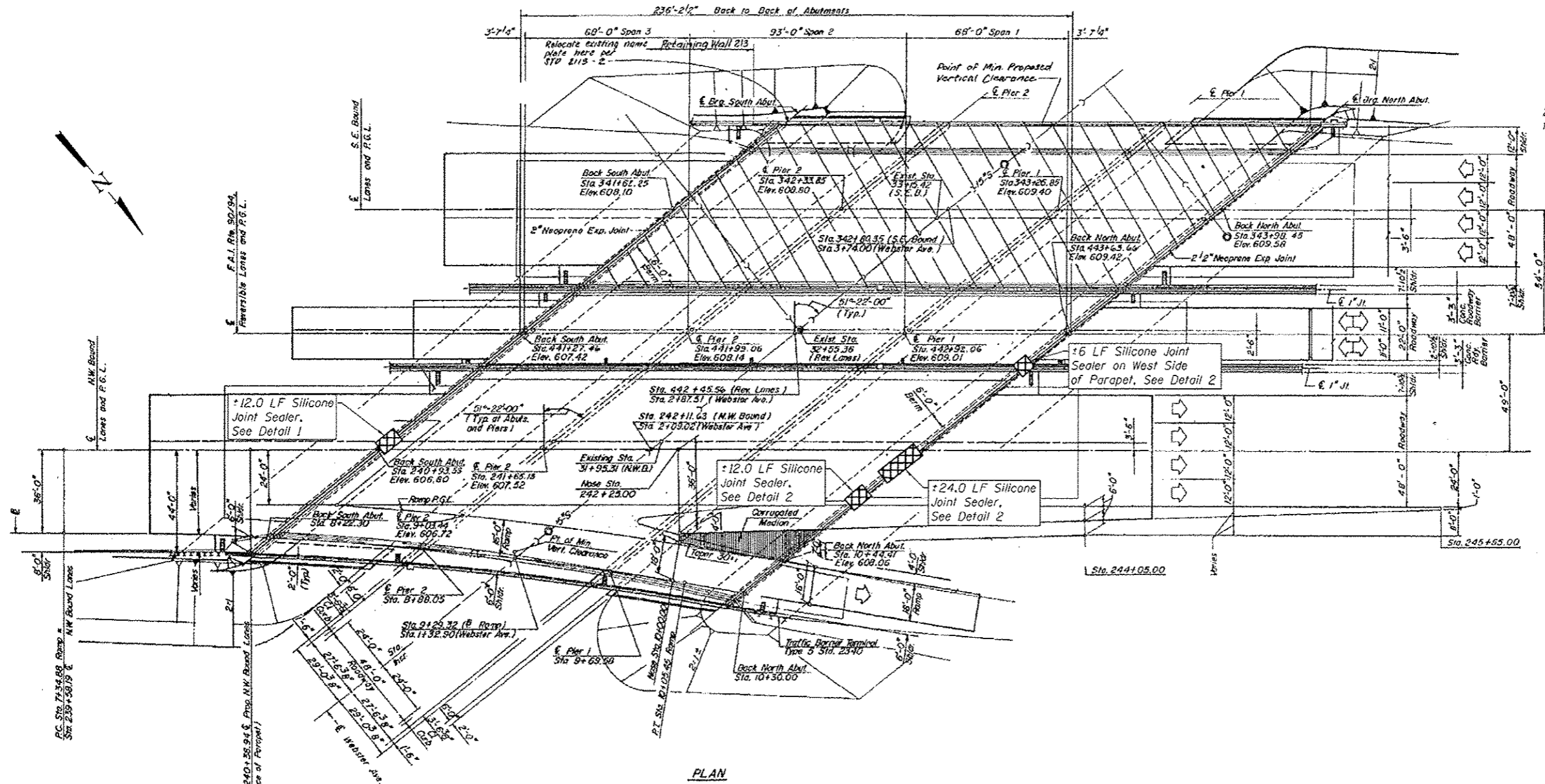

COLLINS ENGINEERS, INC.
JAMES M. HAMELKA
NO. 81-6116
EXPIRES 11-30-2014

COLLINS ENGINEERS, INC.
177 N. Rock St.
Chicago, IL 60606
Tel: 312.734.8800
Fax: 312.734.8801
www.collins-engineers.com

USER NAME	DESIGNED - AMS	REVISED -
PLOT SCALE	DRAWN - AMS	REVISED -
PLOT DATE	CHECKED - JMH	REVISED -
	DATE - DECEMBER 2012	REVISED -

STATE OF ILLINOIS
DEPARTMENT OF TRANSPORTATION

GENERAL PLAN AND ELEVATION
I-90/94 OVER WEBSTER AVE (SN 016-0131)

SHEET NO. 51 OF 52 SHEETS

F.A.I. RTE.	SECTION	COUNTY	TOTAL SHEETS	SHEET NO.
90/94	2012-055BR	COOK	107	61
CONTRACT NO. 60V58			ILLINOIS FED. AID PROJECT	