

INDEX OF SHEETS

- S1. General Plan and Elevation I
- S2. General Plan and Elevation II
- S3. General Notes, Bill of Materials, Index of Sheets, and Details
- S4. Partial Framing Plan I
- S5. Partial Framing Plan II
- S6. Partial Framing Plan III
- S7. PPC I-Beam Repair Details
- S8. Structural Steel Repair Details I
- S9. Structural Steel Repair Details II
- S10. Pier 1 Repairs
- S11. Pier 2 Repairs
- S12. Pier 3 Repairs
- S13. Pier 4 Repairs
- S14. Pier 5 Repairs
- S15. Pier 6 Repairs
- S16. Pier 7 Repairs
- S17. Pier 8 Repairs
- S18. Pier 9 Repairs
- S19. Pier 10 Repairs
- S20. Pier 11 Repairs
- S21. Pier 12 Repairs
- S22. Pier 13 Repairs
- S23. Pier 14 Repairs
- S24. Pier 15 Repairs
- S25. Pier 16 Repairs
- S26. Pier 17 Repairs
- S27. Pier 18 Repairs
- S28. Pier 19 Repairs
- S29. Pier 20 Repairs
- S30. Pier 21 Repairs
- S31. Pier 22 Repairs
- S32. Pier 23 Repairs
- S33. Pier 24 Repairs
- S34. Pier 24 Repairs

GENERAL NOTES

1. Plan dimensions and details relative to existing plans are subject to nominal construction variations. The Contractor shall field verify existing dimensions and details affecting new construction and make necessary approved adjustments prior to construction or ordering of materials. Such variations shall not be cause for additional compensation for a change in scope of the work, however, the Contractor will be paid for the quantity actually furnished at the unit price bid for the work.
2. Staged construction shall be utilized to maintain traffic during construction. See Civil Drawings.
3. The Contractor shall exercise care during removal of existing joints to ensure that the slab, beams and diaphragms' integrity will not be detrimentally impacted. The Contractor shall repair any damage(s) to the slab, beams or diaphragms caused by his operation as directed by the Engineer at no additional cost to the Department.
4. Joint openings shall be adjusted according to Article 520.04 of the Std. Specs. when the deck is poured at an ambient temperature other than 50° F.
5. Cost for removal and disposal of existing expansion joints is included in the cost of Silicone Joint Sealer 1", Silicone Joint Sealer 1 1/2", Silicone Joint Sealer 2", or Silicone Joint Sealer 3", depending on the proposed repairs at the joint.
6. The Contractor must take extra care to achieve proper bondage at the ends of the joint repair to the existing joint assembly.
7. The existing structural steel coating contains lead. The Contractor shall take appropriate precautions to deal with the presence of lead in this project.
8. Existing structural steel that will be in contact with new structural steel shall be cleaned and painted prior to erection as required by the Special Provision "Cleaning and Painting Contact Surface Areas of Existing Steel Structures".
9. All new structural steel shall be shop painted with the inorganic zinc rich primer per AASHTO M300, Type 1. Cost is included in Structural Steel Repair.

BILL OF MATERIAL

ITEM DESCRIPTION	UNIT	QUANTITY
Silicone Joint Sealer, 1"	Foot	42.0
Silicone Joint Sealer, 1 1/2"	Foot	229.0
Silicone Joint Sealer, 2"	Foot	684.0
Silicone Joint Sealer, 3"	Foot	48.0
Polymer Concrete	Cu. Ft.	61.0
Structural Repair of Concrete (Depth Equal To or Less Than 5")	Sq. Ft.	16,484
Structural Repair of Concrete (Depth Greater Than 5")	Sq. Ft.	278
Precast Prestressed Concrete I-Beam Repair	L. Sum	1
Structural Steel Repair	Pound	3,310
Temporary Shoring and Cribbing	Each	393

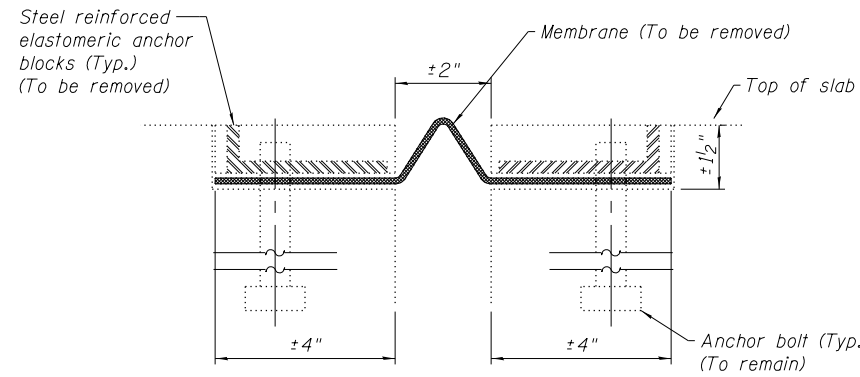

SECTION THROUGH EXISTING NEOPRENE JOINT

DETAIL 1

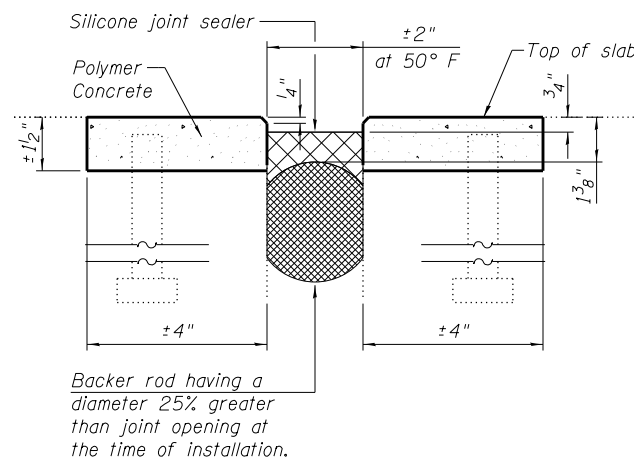

SECTION THROUGH PROPOSED SILICONE JOINT SEALER

Steel reinforced elastomeric anchor blocks (Typ.) (To be removed)

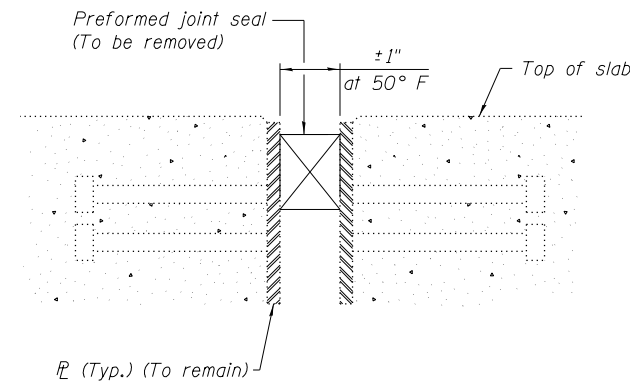

SECTION THROUGH EXISTING PJS JOINT

DETAIL 2

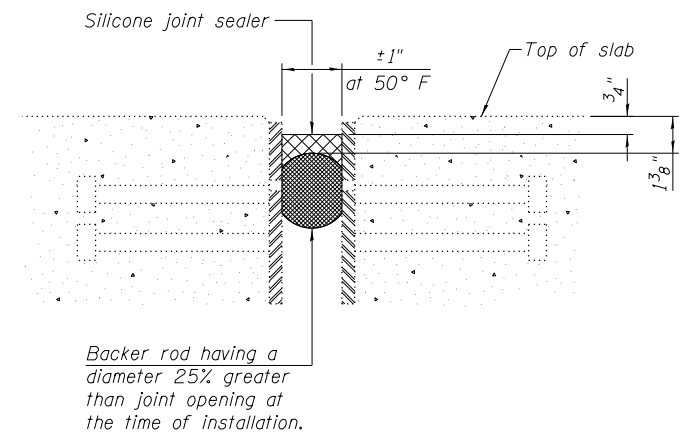

SECTION THROUGH PROPOSED SILICONE JOINT SEALER

Backer rod having a diameter 25% greater than joint opening at the time of installation.

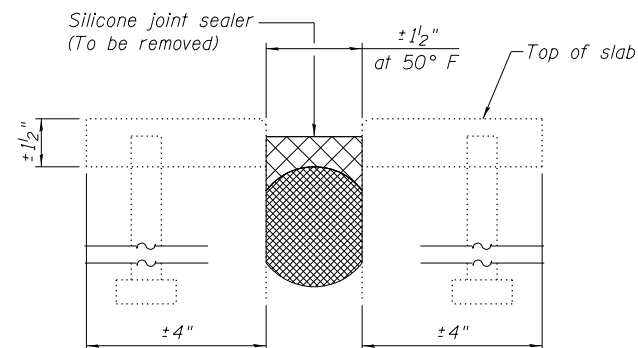

SECTION THROUGH EXISTING SILICONE JOINT

DETAIL 3

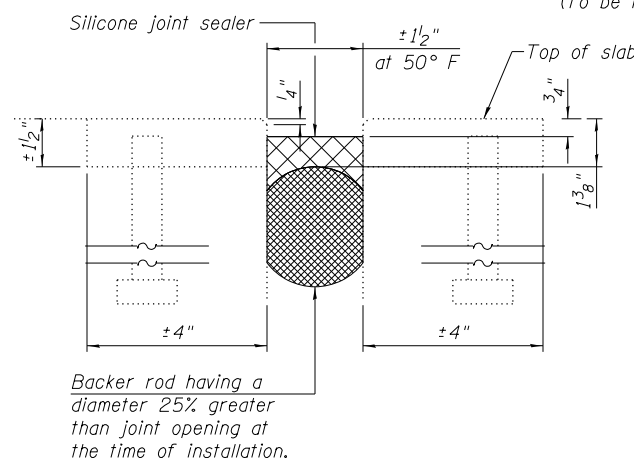

SECTION THROUGH PROPOSED SILICONE JOINT SEALER

Backer rod having a diameter 25% greater than joint opening at the time of installation.

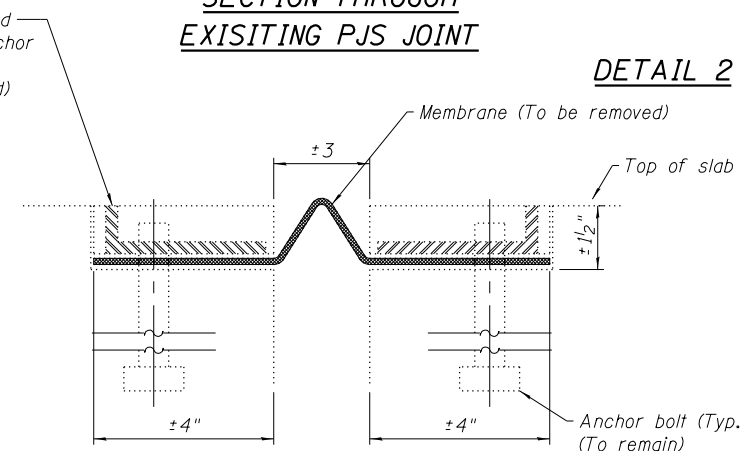

SECTION THROUGH EXISTING NEOPRENE JOINT

DETAIL 4

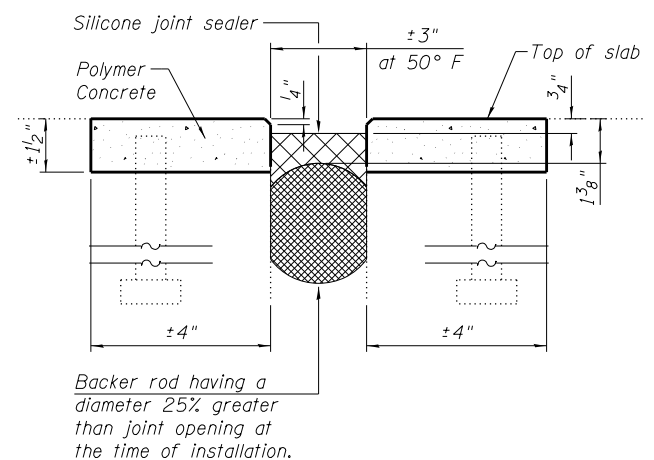

SECTION THROUGH PROPOSED SILICONE JOINT SEALER

Backer rod having a diameter 25% greater than joint opening at the time of installation.